

Kit 1624

HONDA CR-Z, 3-dr Hatchback, 10- / *11-

*North America

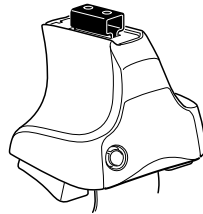

754 Rapid System
480R Rapid Traverse (North America)

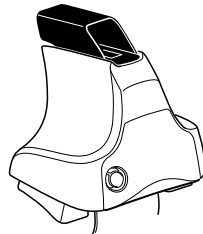
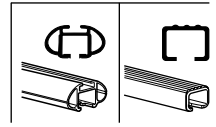

480 Traverse (North America)

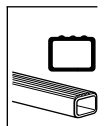

xx kg / xx lbs + 7 kg / 15,4 lbs =

 3 kg / 6,6 lbs

Max. 40 kg

Max. 88 lbs

80 km/h 130 km/h
 50 Mph 80 Mph
 40 km/h 25 Mph
km/h Mph

THULE

instructions Kit XXXX

x1

754 Rapid System x4

480R Rapid Traverse (North America) x4

x4

754 Rapid System
480R Rapid Traverse (North America)

x1

480 Traverse (North America) x4

x4

x2

x2

x2

x4

x4

x1

 17 mm

x2

 23 mm

x2

x2

x2

x2

 (North America)

x2

x2

1142 x1

1143 x1

1144 x2

353 x1

354 x1

359 x2

x1

1

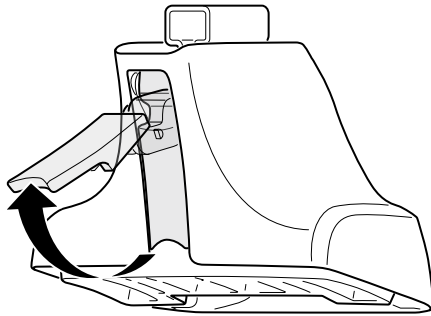

2



754 Rapid System
480R Rapid Traverse
(North America)

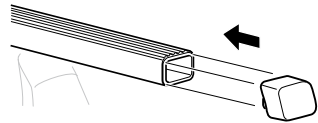
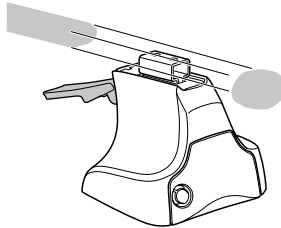

x4

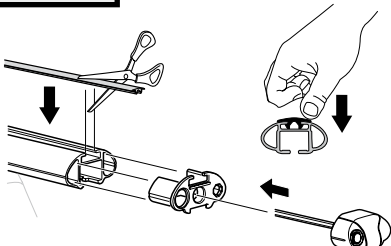
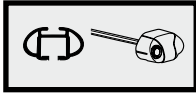

x4

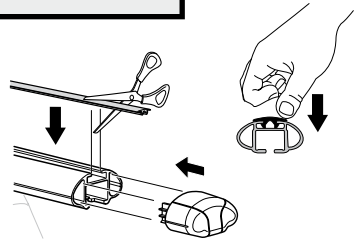
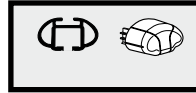

x4

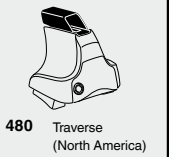

480 Traverse
(North America)

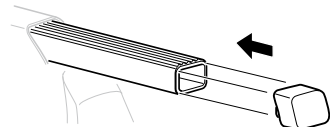
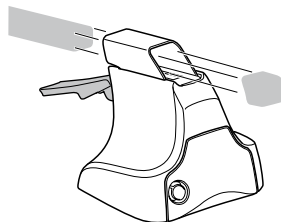

x4

3

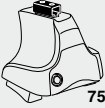

754 Rapid System

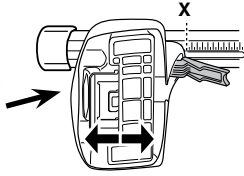

	X
HONDA CR-Z, 3-dr Hatchback, 10- / *11-	31

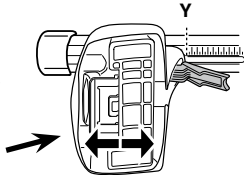

	Y
HONDA CR-Z, 3-dr Hatchback, 10- / *11-	26,5

3



480R Rapid Traverse



480 Traverse

(North America)

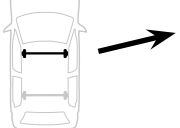

	X inch	X mm
HONDA CR-Z, 3-dr Hatchback, 10- / *11-	37 ⁷/₈"	961 mm

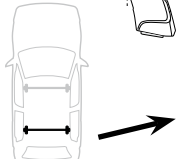
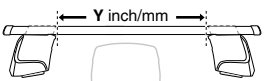

	Y inch	Y mm
HONDA CR-Z, 3-dr Hatchback, 10- / *11-	36 ¹/₈"	916 mm

4

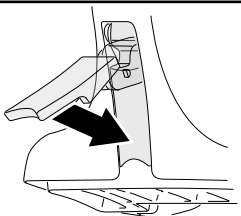

5

HONDA CR-Z, 3-dr Hatchback, 10- / *11-

SRA

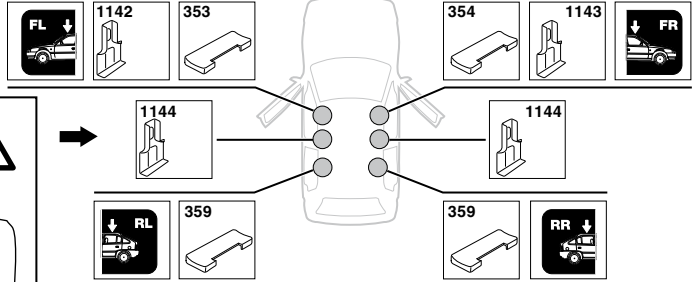
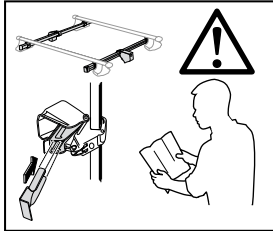

A

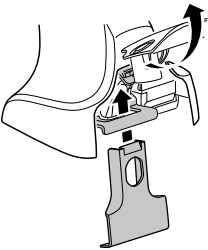

B

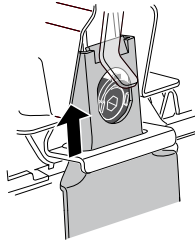

C

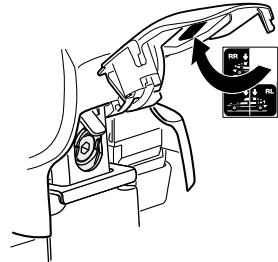
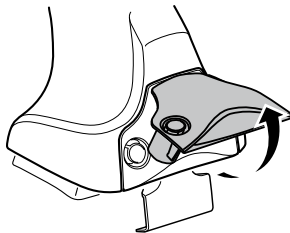
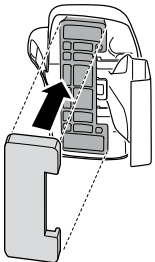
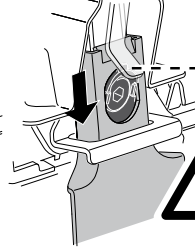

6

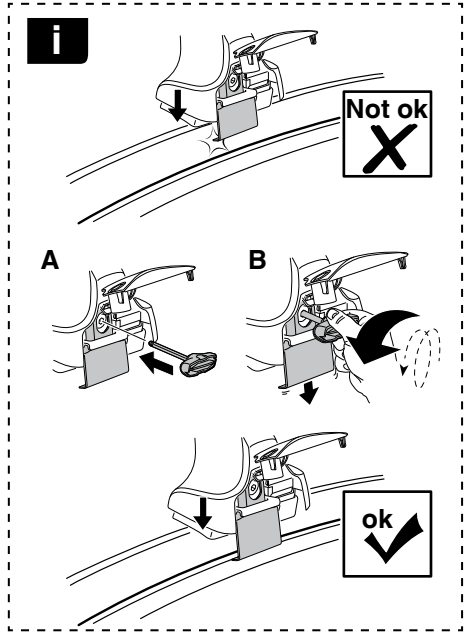
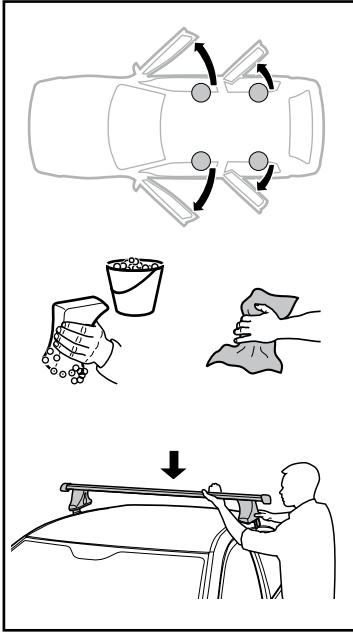

	X mm	Y mm	Z mm	X inch	Y inch	Z inch
HONDA CR-Z, 3-dr Hatchback, 10- / *11-	80 mm	610 mm	460 mm	3 1/8"	24"	18 1/8"

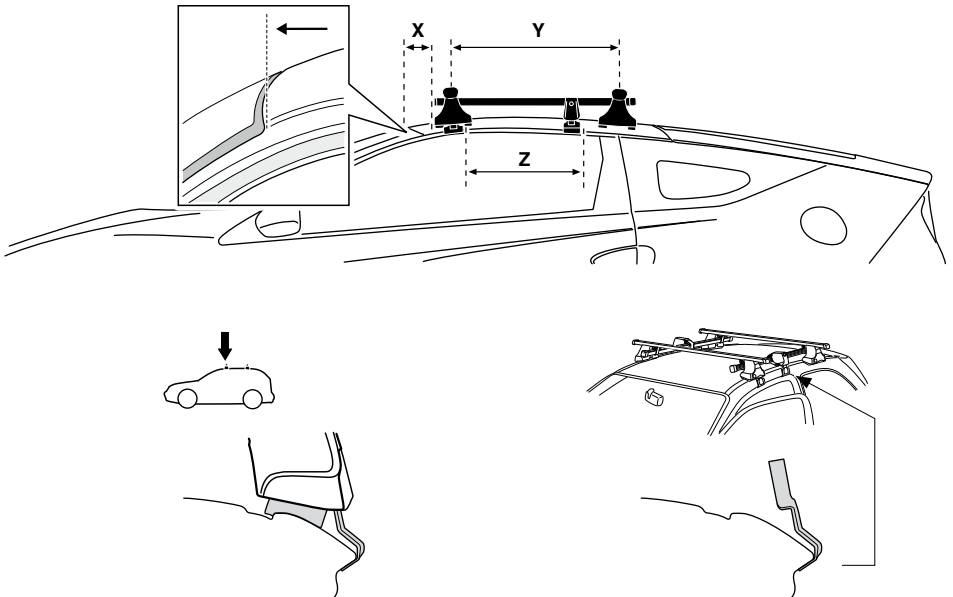

7

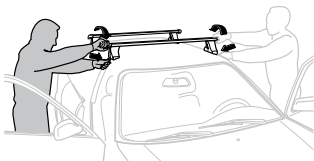

GB/US	Tighten alternately
D	Die Schrauben abwechselnd anziehen
F	Serrer alternativement chaque côté
NL	Afwisselend aan de linker- en de rechterkant aandraaien
I	Alternare il serraggio delle viti
E	Apertar alternativamente
PT	Aperte alternadamente
S	Dra åt växelvis
FIN	Kierrä vuorotellen
EST	Pinguldage vaheldumisi
LAT	Pielveiciet pamišus
LIT	Užsukinėkite pakaitomis
PL	Śruby dokręcaj naprzemiennie
RU	Загряивайте попеременно

CZ	Pokręřta багаžnika dokręcaj naprzemiennie.
SK	Dofahajte striedavo
SLO	Privijajte izmenično.
HR	Naizmjenično zategnite
HU	Egymástól függetlenül szorítandó
GR	Σφιγγετε εναλλάξ
TR	Dönüşümlü sıkın

中文 交替拧紧

한국어 번갈아 가며 조이십시오.

日本語 交互に締め付けてください。

ไทย ชันในแบบสลับ

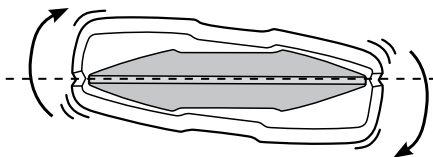
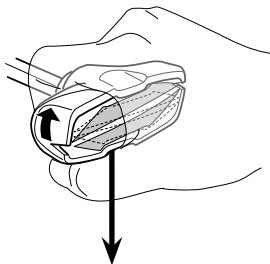
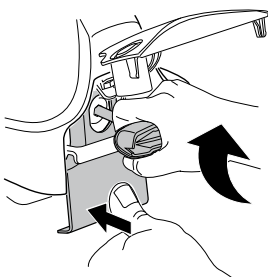
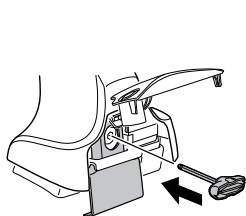

≈ 3 Nm

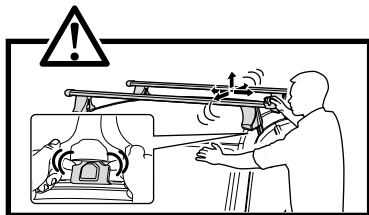
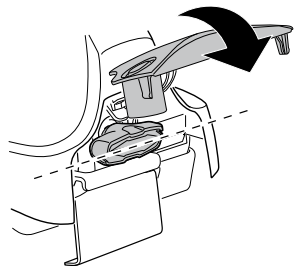

8



x1
17 mm

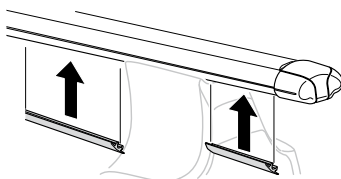

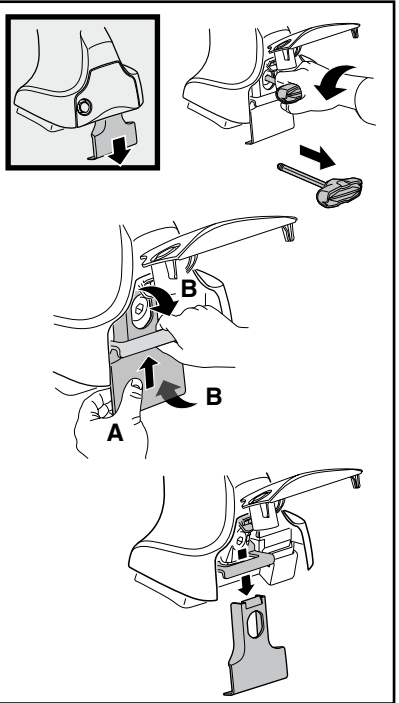
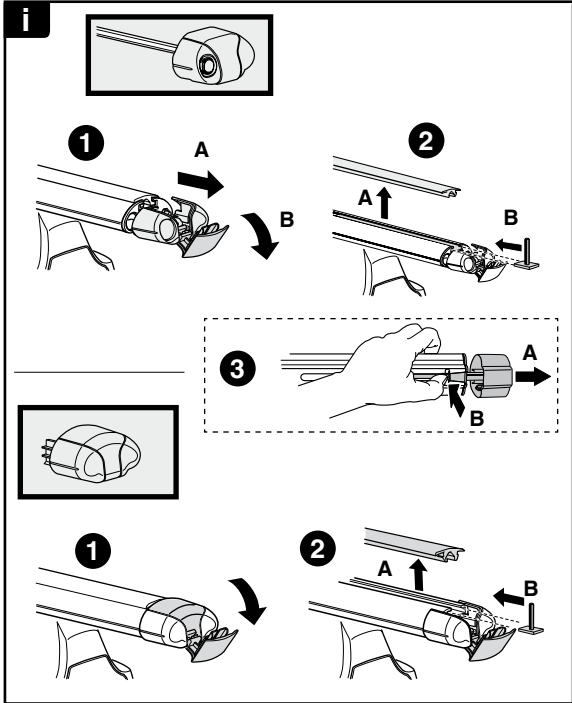

THULE
SWEDEN
**ONE
KEY
SYSTEM**

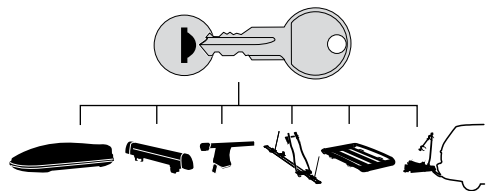

- 544** (x4)
 - 596** (x6)
 - 588** (x8)
 - 510** (x10)
 - 452** (x12)
- NA
EUR
ASIA

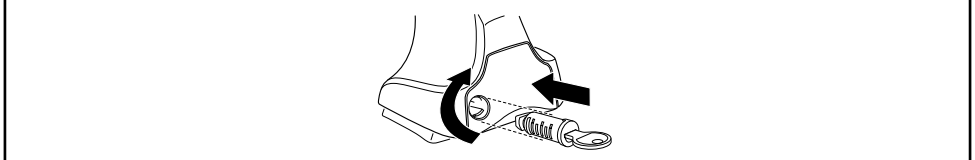

WW ▶ Thule Sweden AB, Box 69, 330 33 Hillerstorp, SWEDEN
NA ▶ Thule Inc., 42 Silvermine Road, Seymour, Connecticut 06483, USA

info@thule.com
customer.service@thule.com

www.thule.com