

Kit 1623

NISSAN March (K13), 5-dr Hatchback, 10–
NISSAN Micra (K13), 5-dr Hatchback, 10–

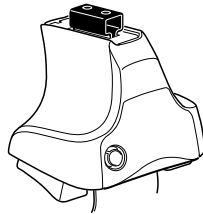

754 Rapid System
480R Rapid Traverse (North America)

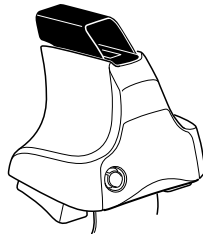
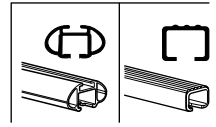

480 Traverse (North America)

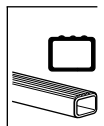

754 Rapid System
480R Rapid Traverse (North America)

480 Traverse (North America)

1

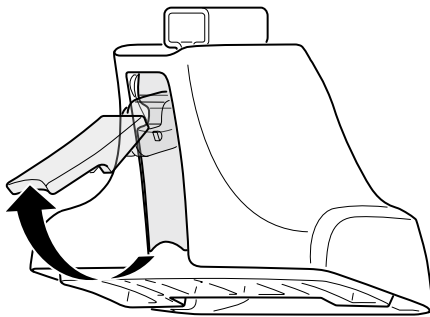

2



754 Rapid System
480R Rapid Traverse
(North America)

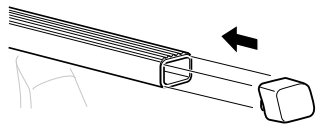
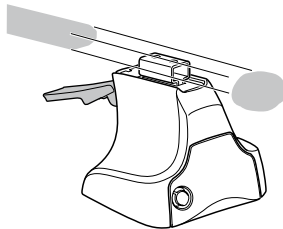

x4

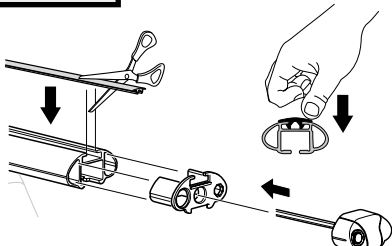
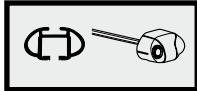

x4

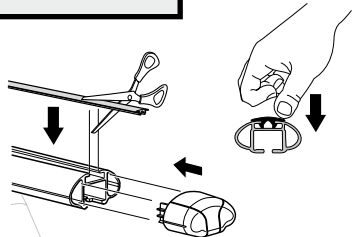
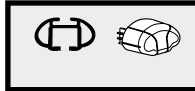

x4

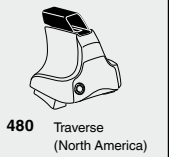

480 Traverse
(North America)

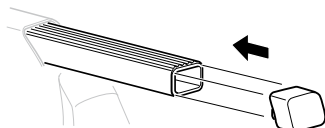
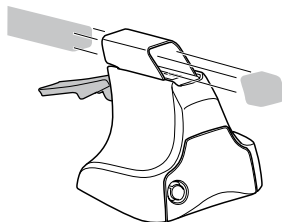

x4

3

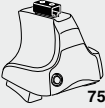

754 Rapid System

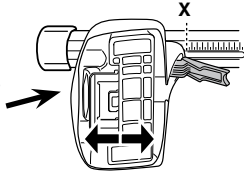

	X
NISSAN March (K13), 5-dr Hatchback, 10-	22,5
NISSAN Micra (K13), 5-dr Hatchback, 10-	22,5

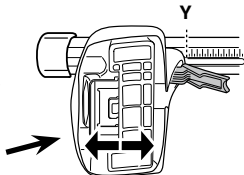

	Y
NISSAN March (K13), 5-dr Hatchback, 10-	19
NISSAN Micra (K13), 5-dr Hatchback, 10-	19

3



480R Rapid Traverse



480 Traverse

(North America)

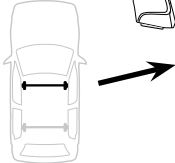

	X inch	X mm
NISSAN March (K13), 5-dr Hatchback, 10-	34 1/4"	876 mm
NISSAN Micra (K13), 5-dr Hatchback, 10-	34 1/4"	876 mm

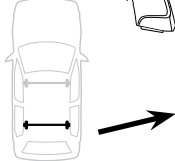

	Y inch	Y mm
NISSAN March (K13), 5-dr Hatchback, 10-	33"	839 mm
NISSAN Micra (K13), 5-dr Hatchback, 10-	33"	839 mm

4

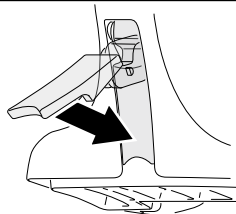

5

NISSAN March (K13), 5-dr Hatchback, 10-
NISSAN Micra (K13), 5-dr Hatchback, 10-

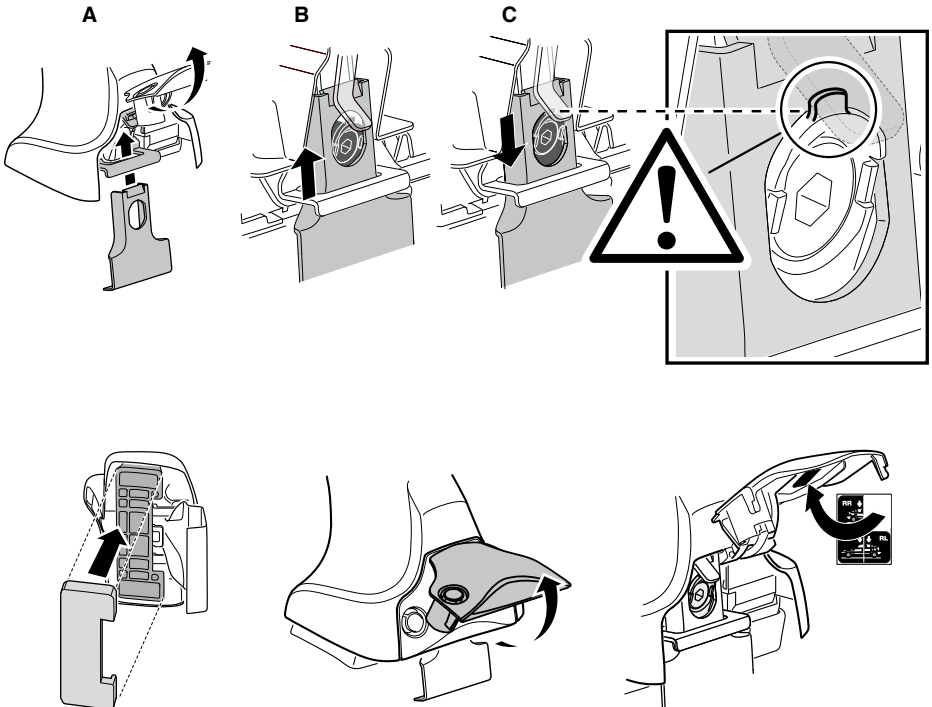
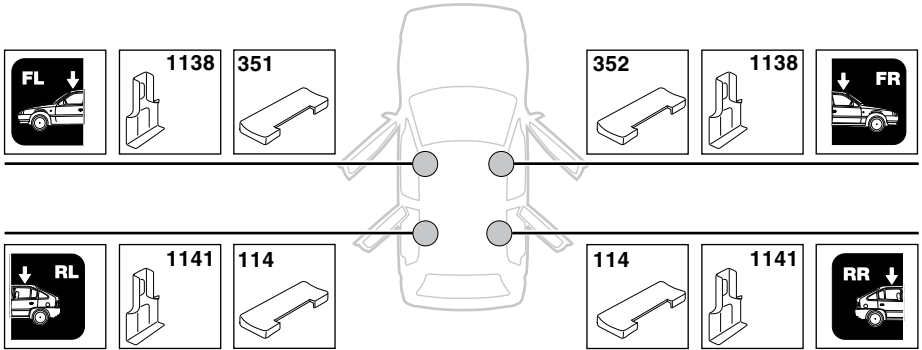

6

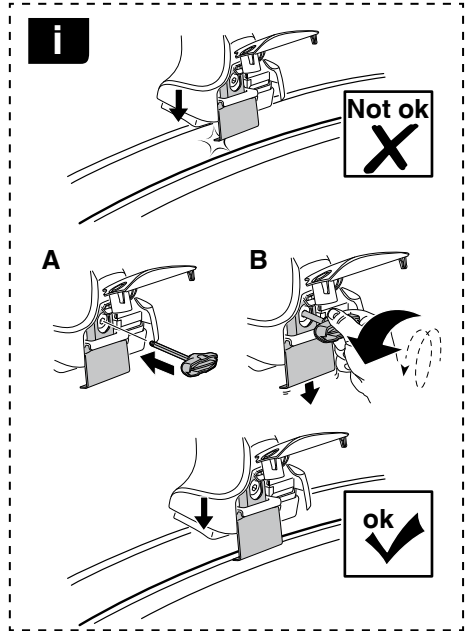
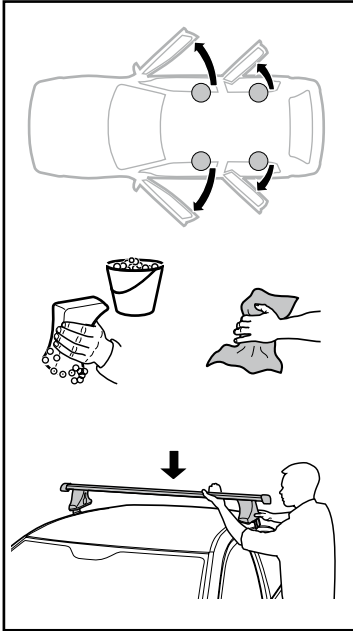

	X mm	Y mm	X inch	Y inch
NISSAN March (K13), 5-dr Hatchback, 10-	260 mm	670 mm	10 1/4"	26 3/8"
NISSAN Micra (K13), 5-dr Hatchback, 10-	260 mm	670 mm	10 1/4"	26 3/8"

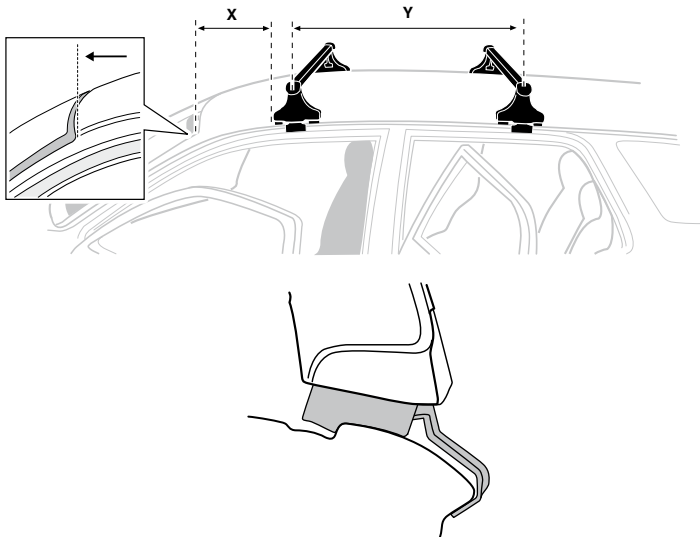

7

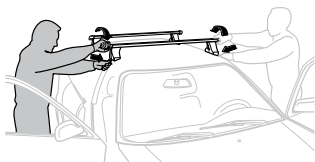

GB/US	Tighten alternately
D	Die Schrauben abwechselnd anziehen
F	Serrer alternativement chaque côté
NL	Afwisselend aan de linker- en de rechterkant aandraaien
I	Alternare il serraggio delle viti
E	Apertar alternativamente
PT	Aperte alternadamente
S	Dra åt växelvis
FIN	Kierrä vuorotellen
EST	Pinguldage vaheldumisi
LAT	Pielveiciet pamišus
LIT	Užsukinėkite pakaitomis
PL	Śruby dokręcaj naprzemiennie
RU	Загтягивайте попеременно

CZ	Pokręřta багаžníka dokręřcaj dokręřcaj naprzemiennie.
SK	Dofahajte striedavo
SLO	Privijajte izmenično.
HR	Naizmjenično zategnite
HU	Egymástól függetlenül szorítandó
GR	Σφιγγετε εναλλάξ
TR	Dönüşümlü sıkın

中文 交替拧紧

한국어 번갈아 가며 조이십시오.

日本語 交互に締め付けてください。

ไทย ชันในแบบสลับ

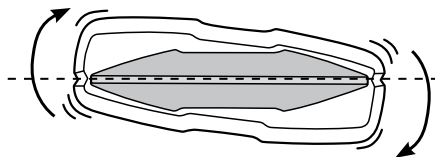
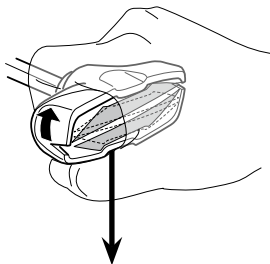
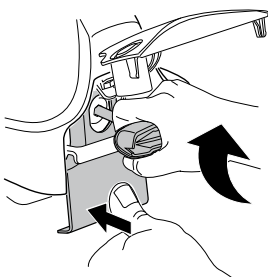
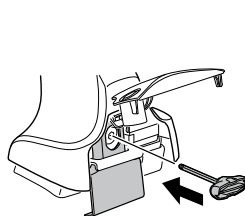

≈ 3 Nm

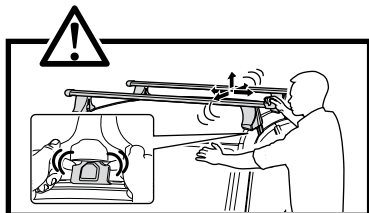
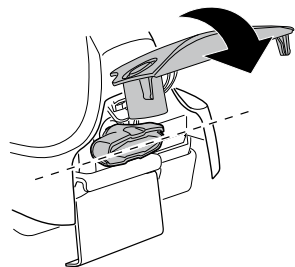

8



x1
17 mm

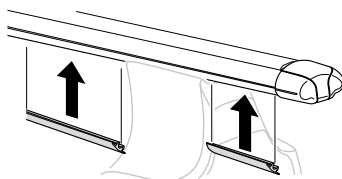

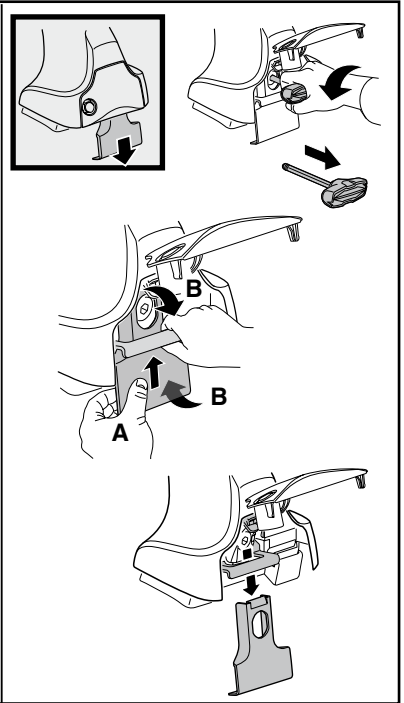
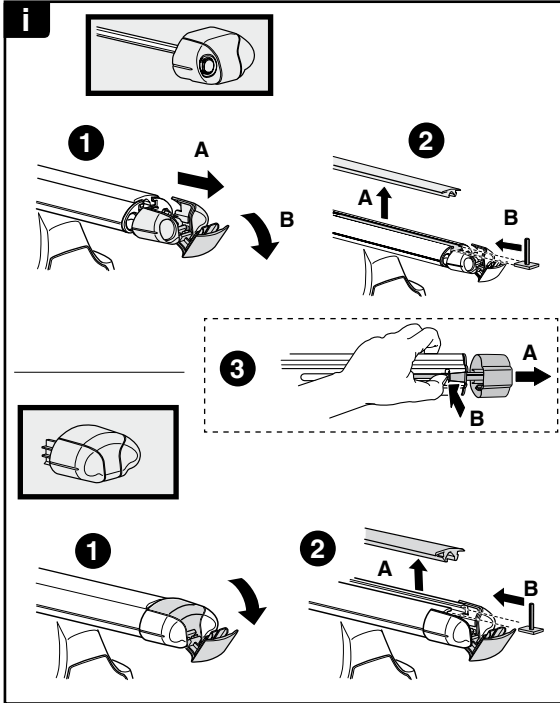
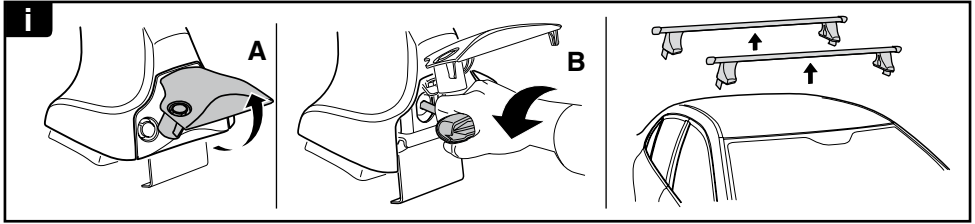

THULE
SWEDEN
**ONE
KEY
SYSTEM**

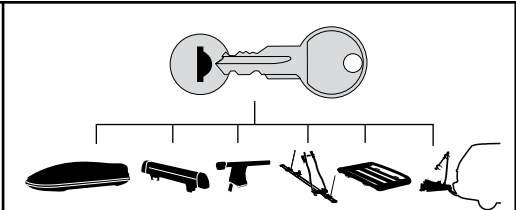

- 544 (x4)
- 596 (x6)
- 588 (x8)
- NA 510 (x10)
- EUR 452 (x12)
- ASIA

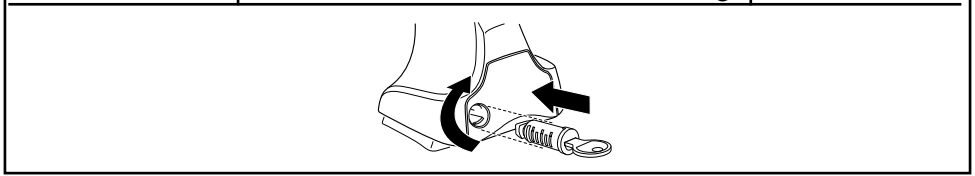

WW ▶ Thule Sweden AB, Box 69, 330 33 Hillerstorp, SWEDEN
NA ▶ Thule Inc., 42 Silvermine Road, Seymour, Connecticut 06483, USA

info@thule.com
customer.service@thule.com

www.thule.com