

Kit 1609

PERODUA Alza, 5-dr MPV, 09–

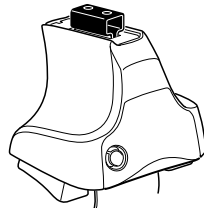

480R Rapid Traverse
754 Rapid System

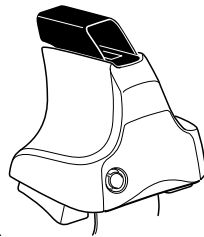
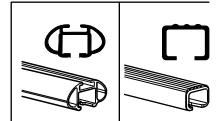

480 Traverse

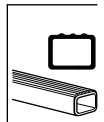

480R Rapid Traverse **x4**
754 Rapid System **x4**

480 Traverse **x4**

1109 x2
1110 x2
120 x1
121 x1
162 x2
FR **FL** **RL** **RR** x1

Kit

1



480R Rapid Traverse
754 Rapid System



480 Traverse

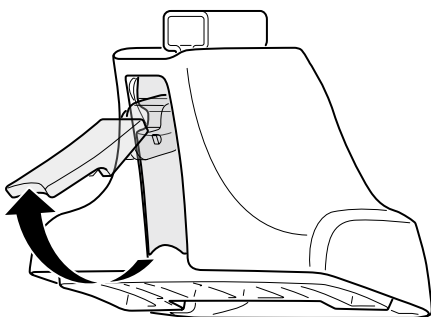

2

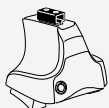

480R Rapid Traverse
754 Rapid System



480 Traverse

+

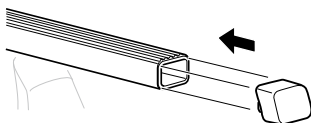
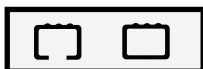
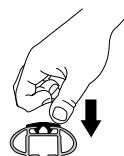
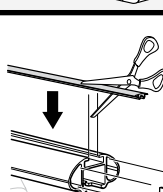
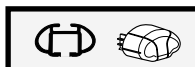
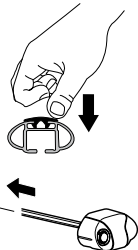
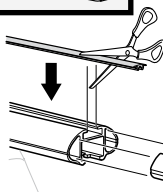
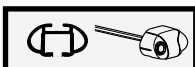
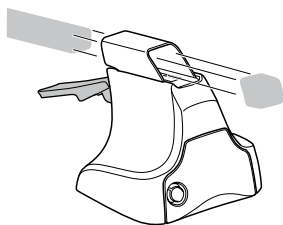
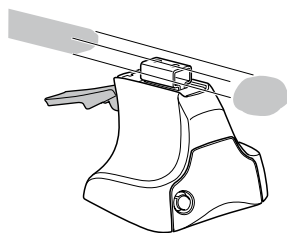

3

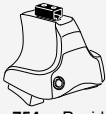

754 Rapid System

1

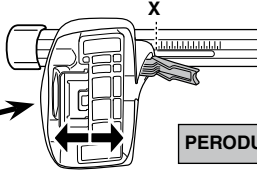
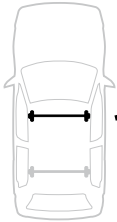

2

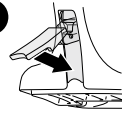

PERODUA Alza, 5-dr MPV, 09-

X

37

1

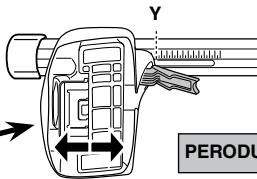
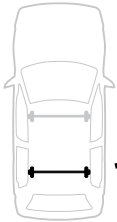

2

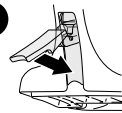

PERODUA Alza, 5-dr MPV, 09-

Y

36

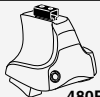

480R Rapid Traverse



480 Traverse

1

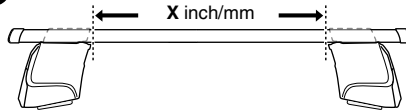

2

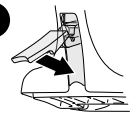

PERODUA Alza, 5-dr MPV, 09-

X inch

X mm

40 1/4"

1022 mm

1

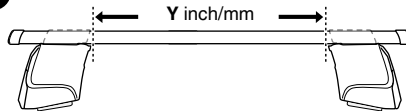

2

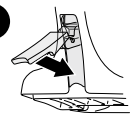

PERODUA Alza, 5-dr MPV, 09-

Y inch

Y mm

39 3/4"

1012 mm

4

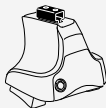

480R Rapid Traverse
754 Rapid System



480 Traverse

PERODUA Alza, 5-dr MPV, 09-

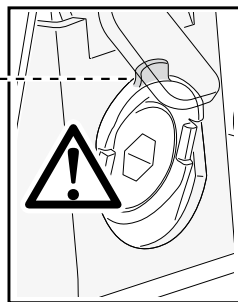
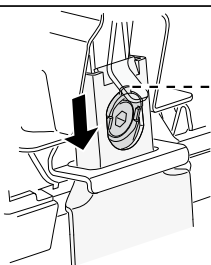
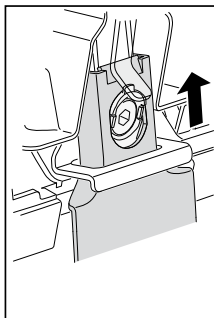
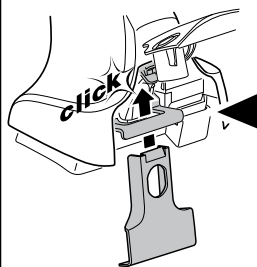
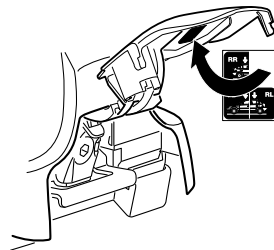
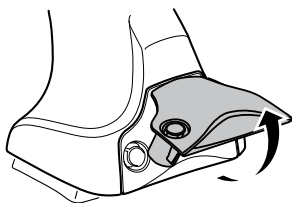
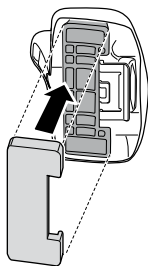
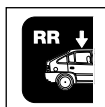
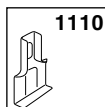
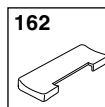
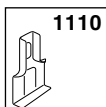
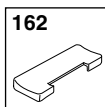
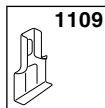
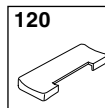
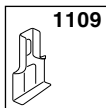
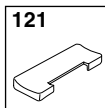

5

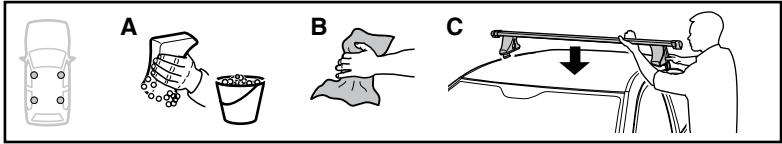

	X mm	Y mm	X inch	Y inch
PERODUA Alza, 5-dr MPV, 09-	470 mm	700 mm	18 1/2"	27 1/2"

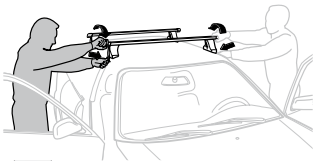
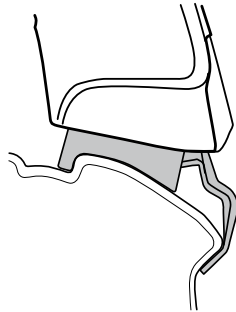
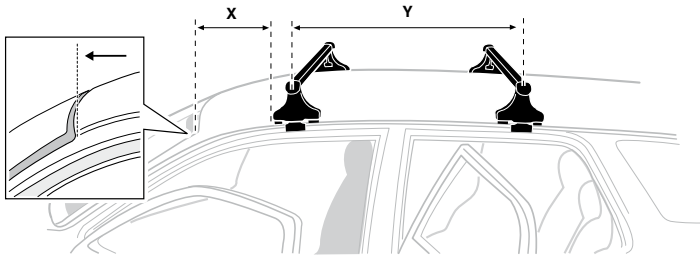

- | | | | |
|--------------|---|------------|---|
| GB/US | Tighten alternately | CZ | Pokrétla bagažníka dokręcaj dokręcaj naprzemiennie. |
| D | Die Schrauben abwechselnd anziehen | SK | Dofahujte striedavo |
| F | Serrer alternativement chaque côté | SLO | Privijajte izmenično. |
| NL | Afwisselend aan de linker- en de rechterkant aandraaien | HR | Naizmjenično zategniti |
| I | Alternare il serraggio delle viti | HU | Egymástól függetlenül szorítandó |
| E | Apretar alternativamente | GR | Σφιγγείτε εναλλάξ |
| PT | Aperte alternadamente | TR | Dönüşümlü sıkın |
| S | Dra åt växelvis | 中文 | 交替拧紧 |
| FIN | Kierrä vuorotellen | 한국어 | 번갈아 가며 조이십시오. |
| EST | Pinguldage vaheldumisi | 日本語 | 交互に締め付けてください。 |
| LAT | Pievelciet pamāšus | ไทย | ขันในแบบสลับ |
| LIT | Užsukinėkite pakaitomis | | |
| PL | Śruby dokręcaj naprzemiennie | | |
| RU | Затягивайте попеременно | | |

6

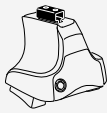

480R Rapid Traverse
754 Rapid System



480 Traverse

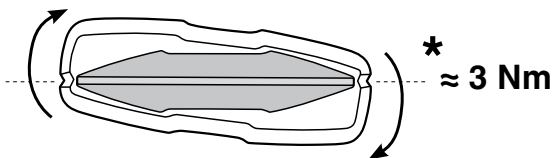
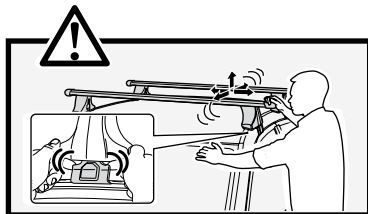
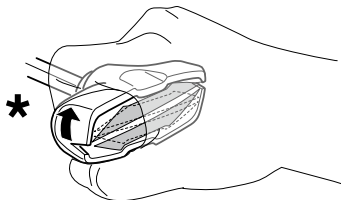
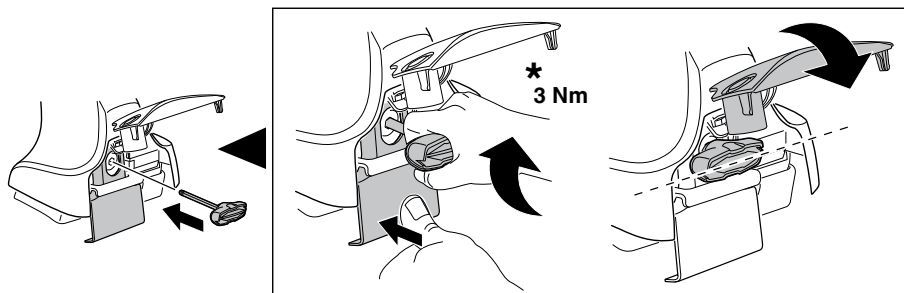

7

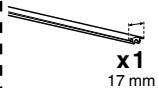

x1
17 mm

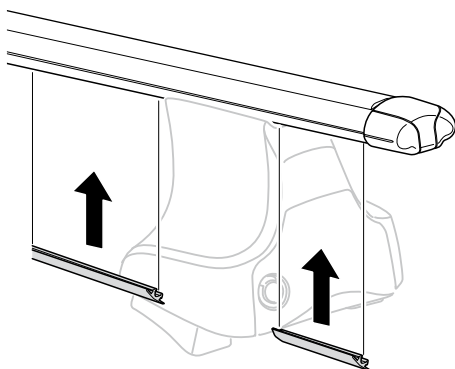

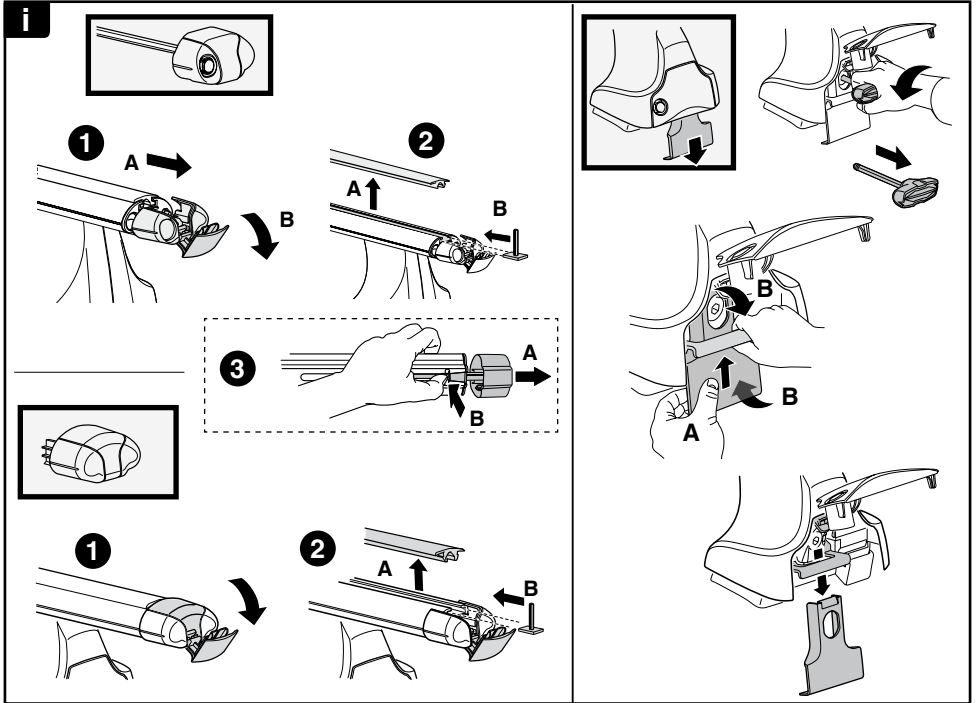
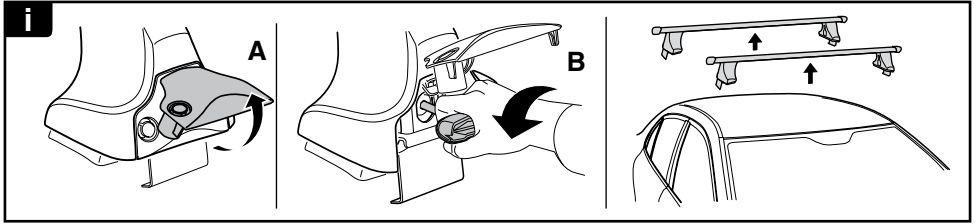

THULE
SWEDEN
**ONE
KEY
SYSTEM**

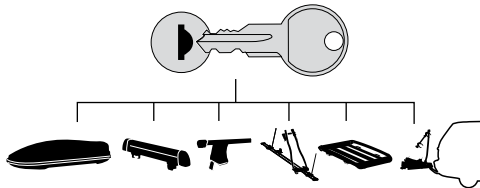

544 (x4)

596 (x6)

588 (x8)

NA **510** (x10)

EUR **452** (x12)

ASIA

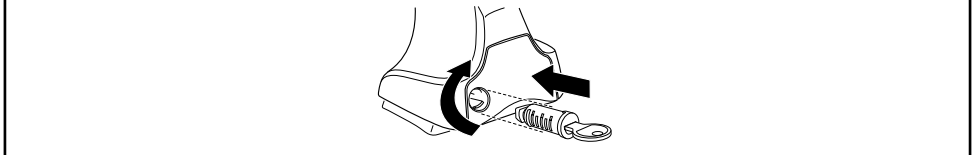

WW ▶ Thule Sweden AB, Box 69, 330 33 Hillerstorp, SWEDEN
NA ▶ Thule Inc., 42 Silvermine Road, Seymour, Connecticut 06483, USA

info@thule.com
customer.service@thule.com

www.thule.com