

Kit 1608

SEAT Ibiza ST, 5-dr Estate, 10-

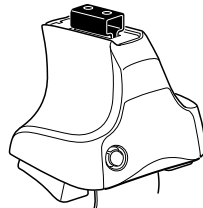

480R Rapid Traverse
754 Rapid System

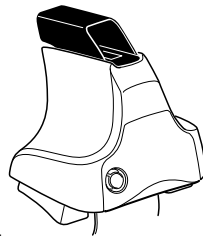
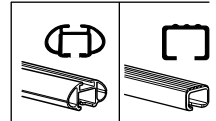

480 Traverse

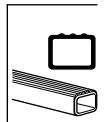

480R Rapid Traverse x4
754 Rapid System x4

480 Traverse x4

Kit

1

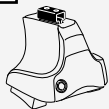

480R Rapid Traverse
754 Rapid System



480 Traverse

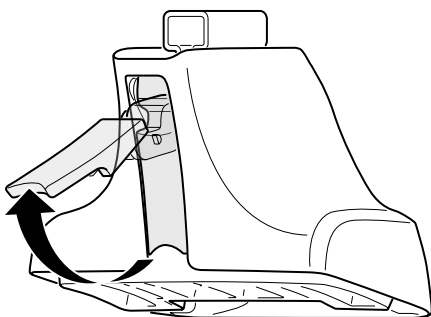

2

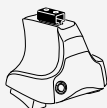

480R Rapid Traverse
754 Rapid System



480 Traverse

+

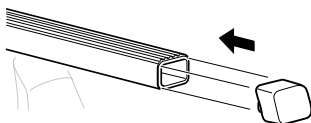
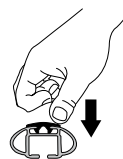
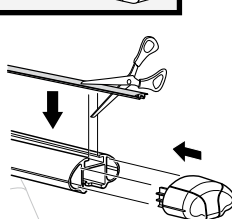
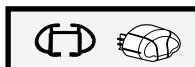
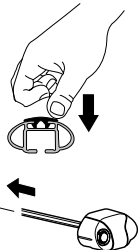
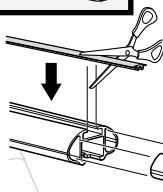
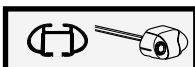
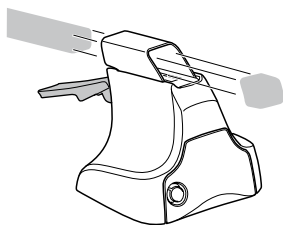
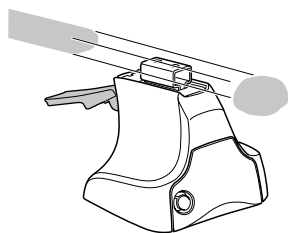

3

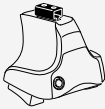

754 Rapid System

1

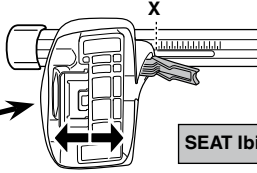
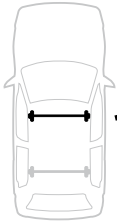

2

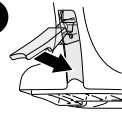

SEAT Ibiza ST, 5-dr Estate, 10-

X

37

1

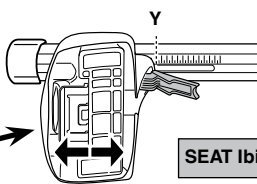
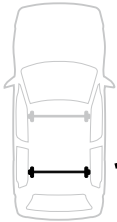

2

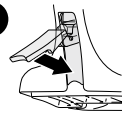

SEAT Ibiza ST, 5-dr Estate, 10-

Y

30,5



480R Rapid Traverse



480 Traverse

1

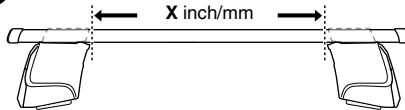

2

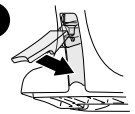

SEAT Ibiza ST, 5-dr Estate, 10-

X inch

X mm

40 1/4"

1021 mm

1

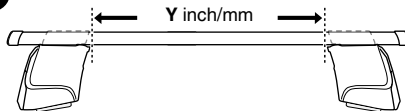

2

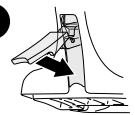

SEAT Ibiza ST, 5-dr Estate, 10-

Y inch

Y mm

37 5/8"

956 mm

4

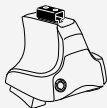

480R Rapid Traverse
754 Rapid System



480 Traverse

SEAT Ibiza ST, 5-dr Estate, 10-

333



897

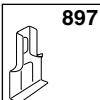

334



898

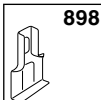

15



1047



15



1047

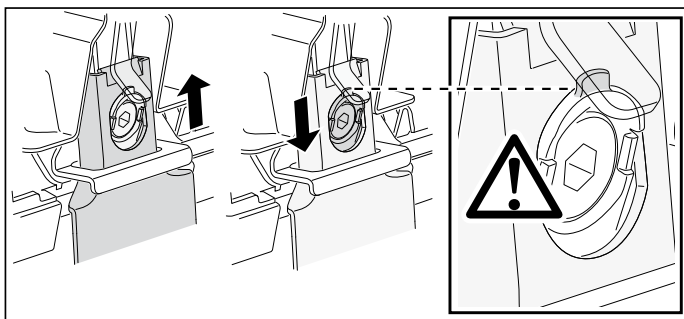
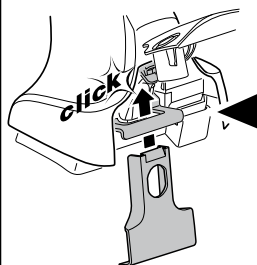
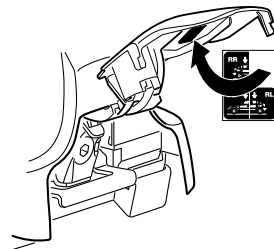
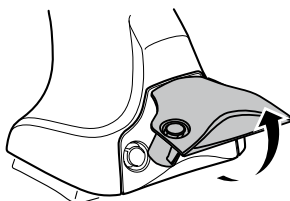
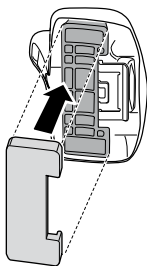
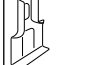

5

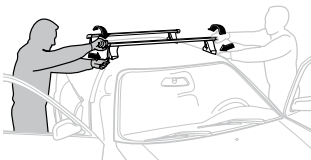
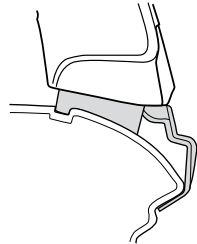
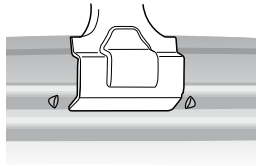
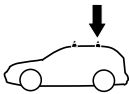
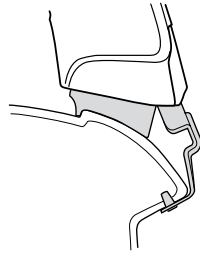
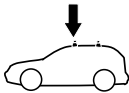
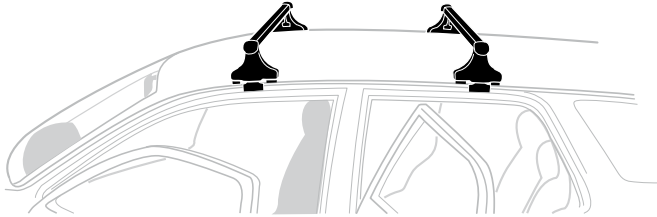

- GB/US** Tighten alternately
D Die Schrauben abwechselnd anziehen
F Serrer alternativement chaque côté
NL Afwisselend aan de linker- en de rechterkant aandraaien
I Alternare il serraggio delle viti
E Apretar alternativamente
PT Aperte alternadamente
S Dra åt växelvis
FIN Kierrä vuorotellen
EST Pinguldage vaheldumisi
LAT Pievelciet pamišus
LIT Užsukinėkite pakaitomis
PL Śruby dokręcaj naprzemiennie
RU Затягивайте попеременно

- CZ** Pokręťta bagazníka dokręcaj naprzemiennie.
SK Doťahujte striedavo
SLO Privijajte izmenično.
HR Naizmjenočno zategnite
HU Egymástól függetlenül szorítandó
GR Σφιγγετε εναλλάξ
TR Dönüşümlü sıkın
中文 交替拧紧

- 한국어** 번갈아 가며 조이십시오.
日本語 交互に締め付けてください。
ไทย ชับแบบสลับ

6

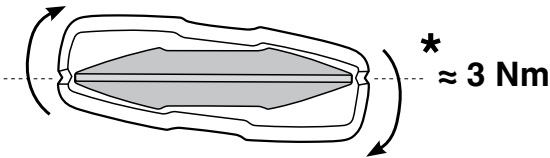
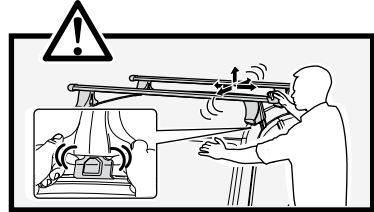
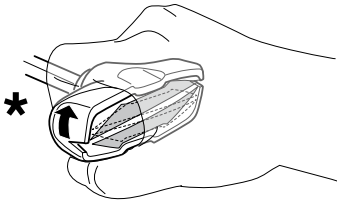
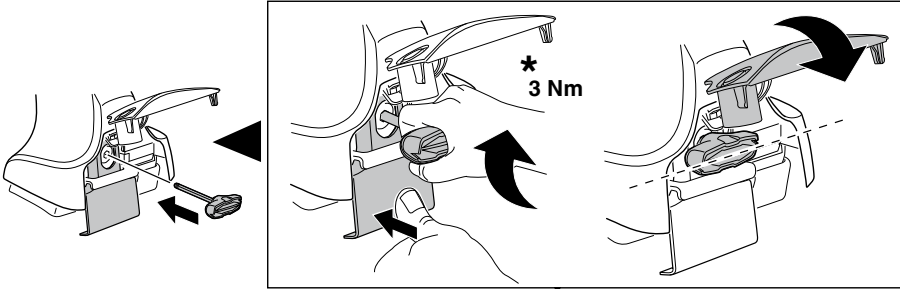
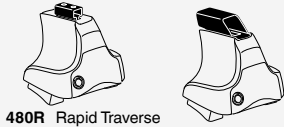

7

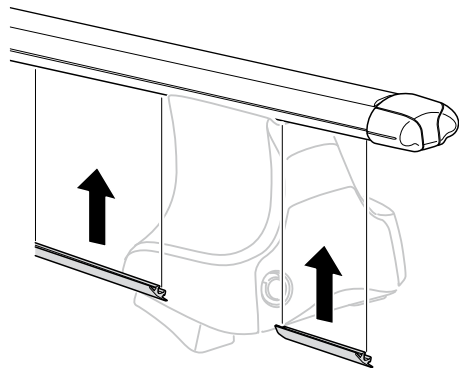
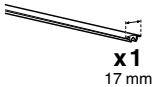

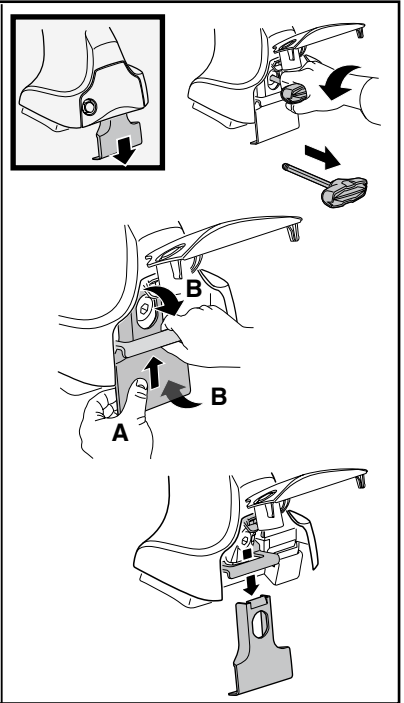
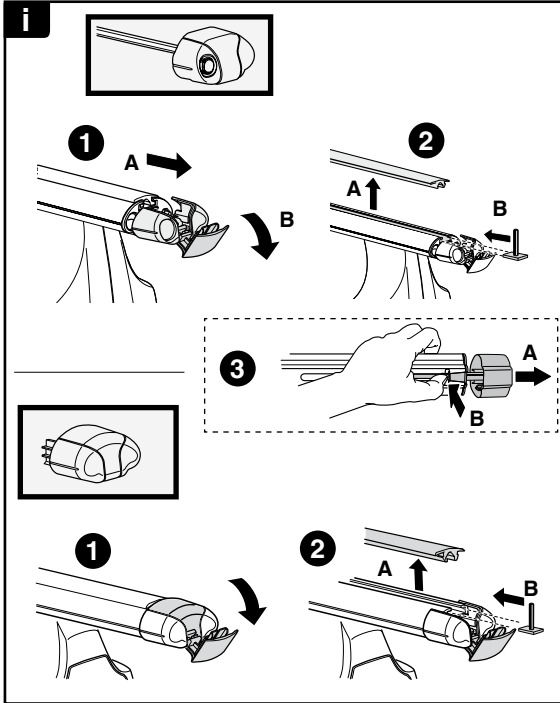

THULE
SWEDEN
**ONE
KEY
SYSTEM**

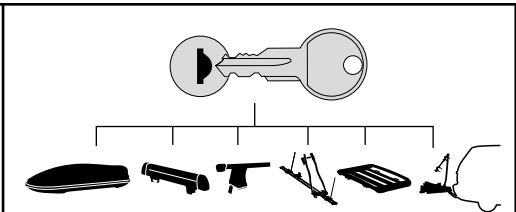

		(x4)
		(x6)
		(x8)
NA		(x10)
EUR		(x12)
ASIA		

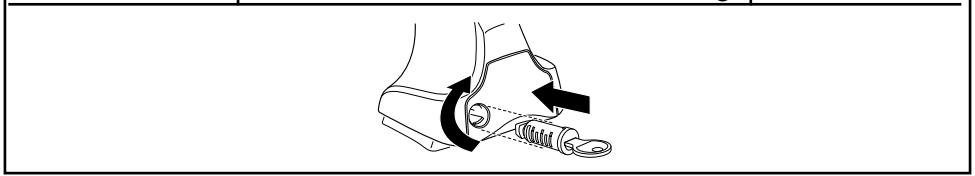

WW ▶ Thule Sweden AB, Box 69, 330 33 Hillerstorp, SWEDEN
NA ▶ Thule Inc., 42 Silvermine Road, Seymour, Connecticut 06483, USA

info@thule.com
customer.service@thule.com

www.thule.com