

# Kit 1577

HYUNDAI Sonata Y20, 4-dr Sedan, 10-  
HYUNDAI Sonata i40, 4-dr Sedan, 10-

480R  
754

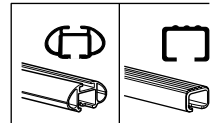
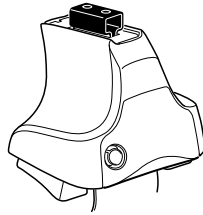

480

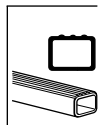
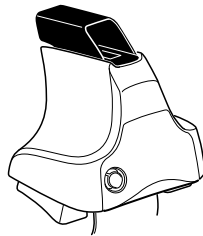

480R/754

480

x2	x2 23 mm	x2 17 mm	x2 23 mm	x2
x2	x2 23 mm	x2 23 mm	x2	x2
x4	x4	x2	x4	x2

x2	x1	x1	x1
x2	x1	x1	

**Kit**

1

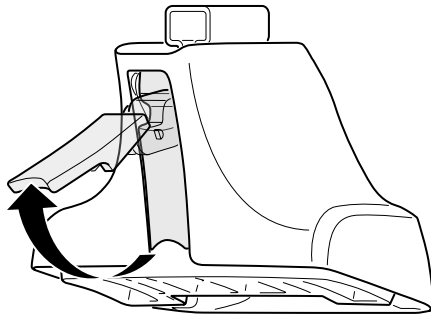
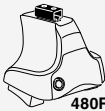

2

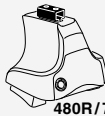

+

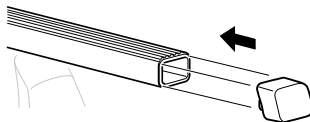
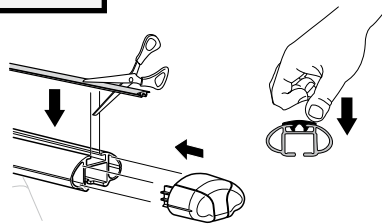
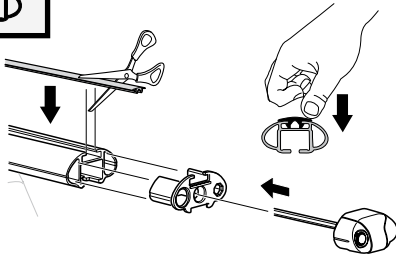
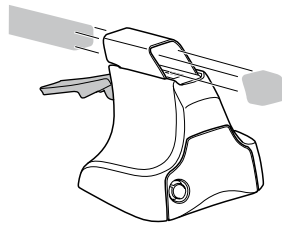
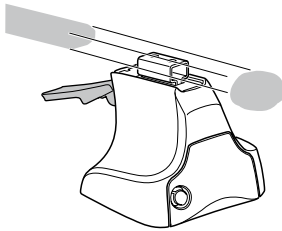

**3**

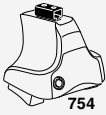

754

**1**

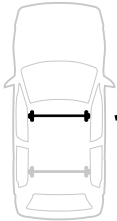

X

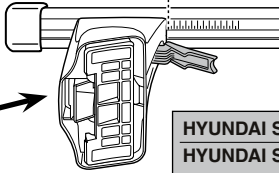

**2**

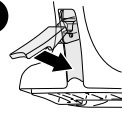

	X
HYUNDAI Sonata Y20, 4-dr Sedan, 10-	42
HYUNDAI Sonata i40, 4-dr Sedan, 10-	42

**1**



Y

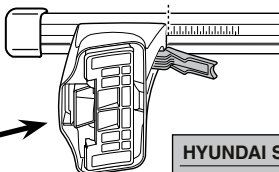

**2**

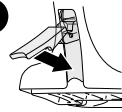

	Y
HYUNDAI Sonata Y20, 4-dr Sedan, 10-	40
HYUNDAI Sonata i40, 4-dr Sedan, 10-	40



480R

480

**1**

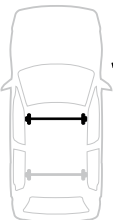

X inch/mm

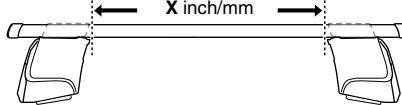

**2**

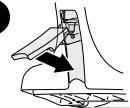

	X inch	X mm
HYUNDAI Sonata Y20, 4-dr Sedan, 10-	42 1/8"	1071 mm
HYUNDAI Sonata i40, 4-dr Sedan, 10-	42 1/8"	1071 mm

**1**



Y inch/mm

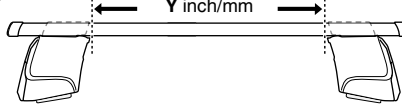

**2**

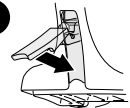

	Y inch	Y mm
HYUNDAI Sonata Y20, 4-dr Sedan, 10-	41 3/8"	1051 mm
HYUNDAI Sonata i40, 4-dr Sedan, 10-	41 3/8"	1051 mm

4



480R/754



480

HYUNDAI Sonata Y20, 4-dr Sedan, 10-  
HYUNDAI Sonata i40, 4-dr Sedan, 10-

336



1064



FL



336



1065



FR



337



1066



RL



337



1067



RR

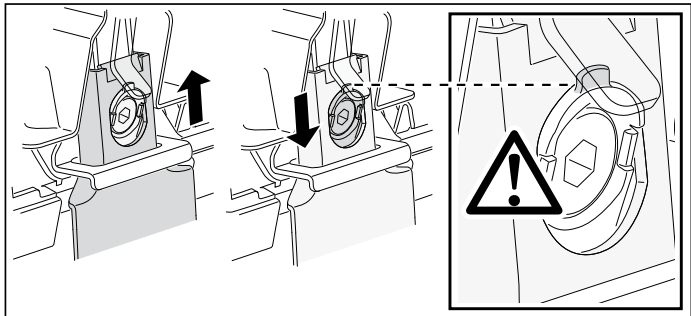
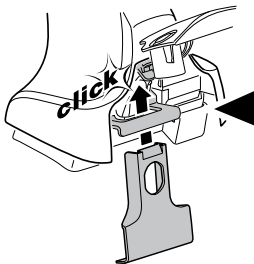
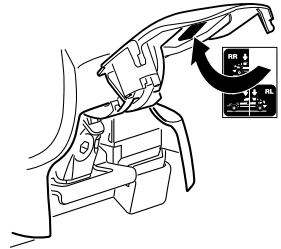
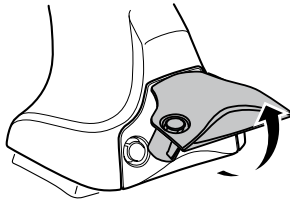
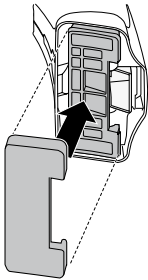

5

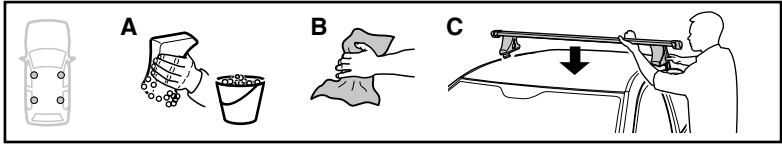

	X mm	Y mm	X inch	Y inch
HYUNDAI Sonata Y20, 4-dr Sedan, 10-	340 mm	700 mm	13 3/8"	27 1/2"
HYUNDAI Sonata i40, 4-dr Sedan, 10-	340 mm	700 mm	13 3/8"	27 1/2"

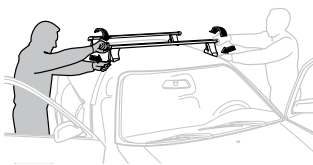
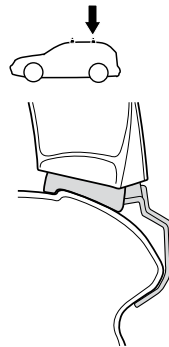
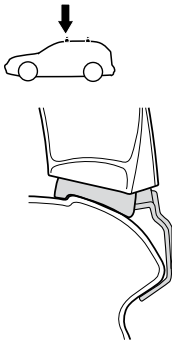
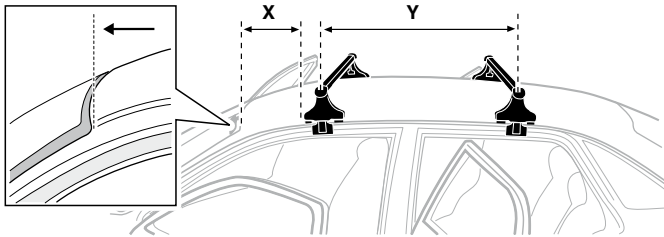

- GB/US** Tighten alternately  
**D** Die Schrauben abwechselnd anziehen  
**F** Serrer alternativement chaque côté  
**NL** Afwisselend aan de linker- en de rechterkant aandraaien  
**I** Alternare il serraggio delle viti  
**E** Apretar alternativamente  
**PT** Aperte alternadamente  
**S** Dra åt växelvis  
**FIN** Kierrä vuorotellen  
**EST** Pinguldage vaheldumisi  
**LAT** Pielieciet pamišus  
**LIT** Užsukinėkite pakaitomis  
**PL** Śruby dokręcaj naprzemiennie  
**RU** Затягивайте попеременно

- CZ** Pokrétla bagazníka dokręcaj dokręcaj naprzemiennie.  
**SK** Dofahujte striedavo  
**SLO** Privijajte izmenično.  
**HR** Naizmjenično zategnite  
**HU** Egymástól függetlenül szorítandó  
**GR** Σφιγγετε εναλλάξ  
**TR** Dönüşümlü sıkın

**中文** 交替拧紧

**한국어** 번갈아 가며 조이십시오.

**日本語** 交互に締め付けてください。

**ไทย** สลับขันแบบสลับ

6

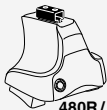

480R/754



480

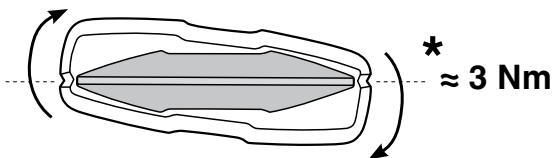
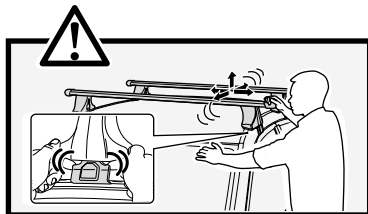
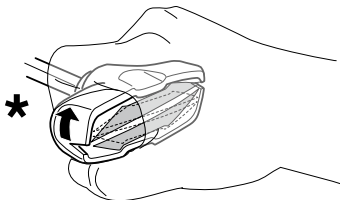
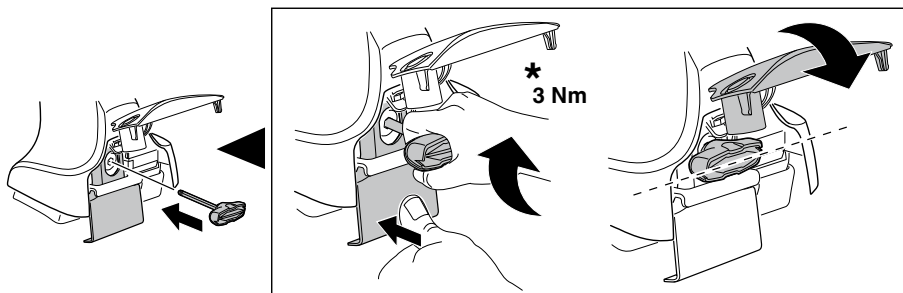

7

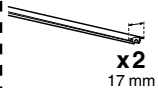

x2  
17 mm

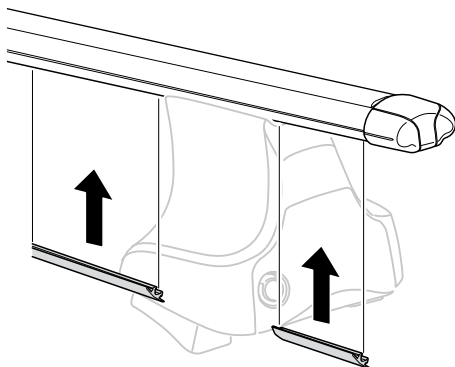

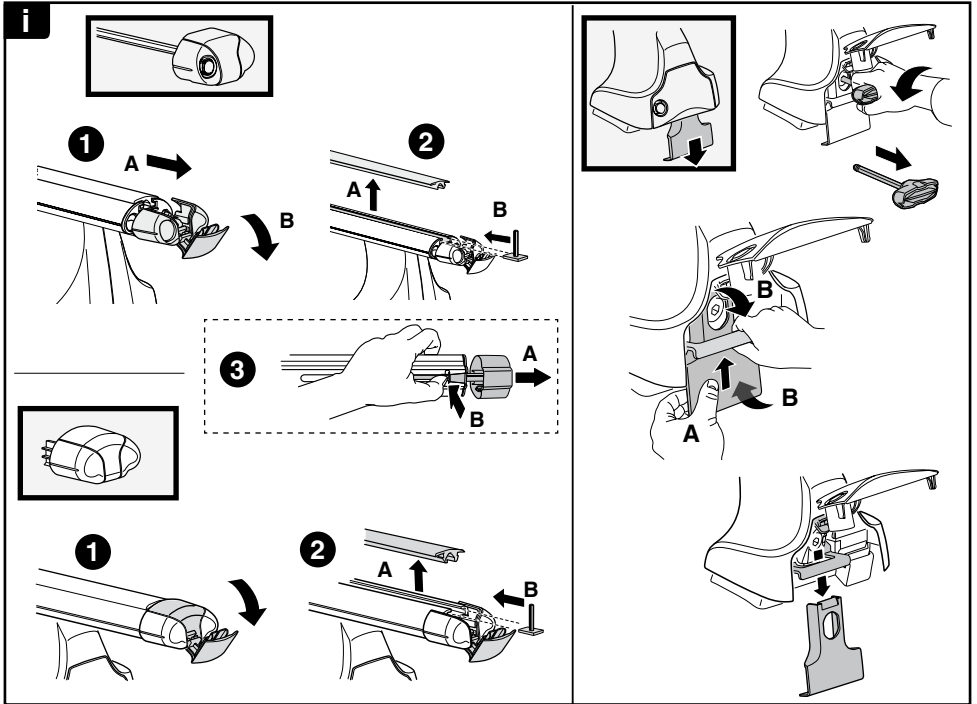
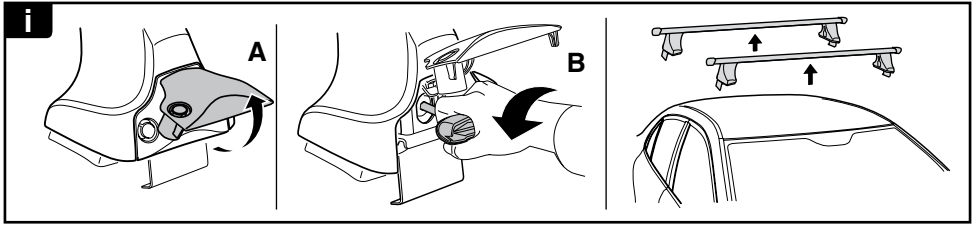

**THULE**  
SWEDEN

**ONE  
KEY  
SYSTEM**

544 (x4)

596 (x6)

588 (x8)

NA 510 (x10)

EUR 452 (x12)

ASIA

WW ▶ Thule Sweden AB, Box 69, 330 33 Hillerstorp, SWEDEN  
 NA ▶ Thule Inc., 42 Silvermine Road, Seymour, Connecticut 06483, USA

info@thule.com  
 customer.service@thule.com

www.thule.com