

Kit 1575

SAAB 9-5, 4-dr Sedan, 10-

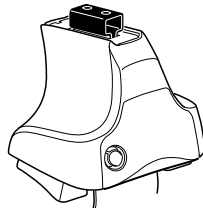

480R Rapid Traverse
754 Rapid System

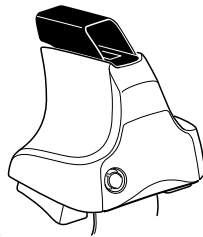
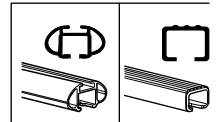

480 Traverse

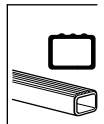

Kit

1

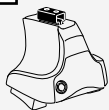

480R Rapid Traverse
754 Rapid System



480 Traverse

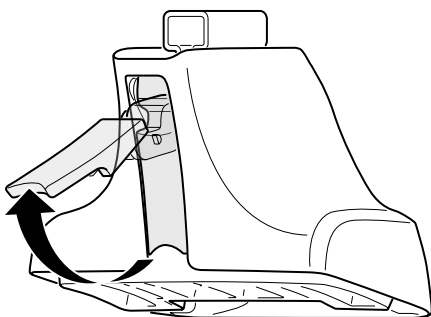

2

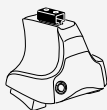

480R Rapid Traverse
754 Rapid System



480 Traverse

+

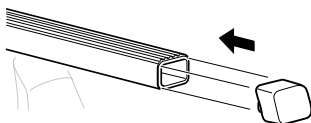
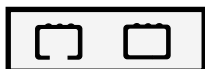
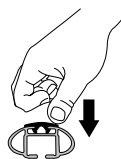
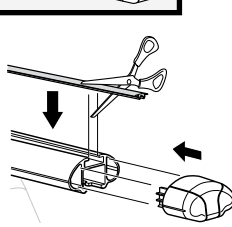
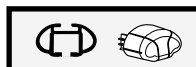
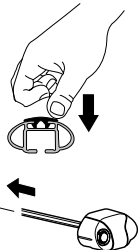
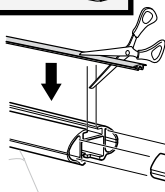
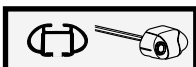
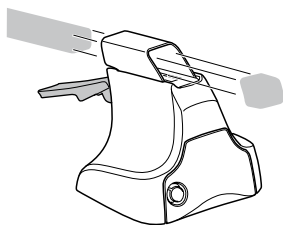
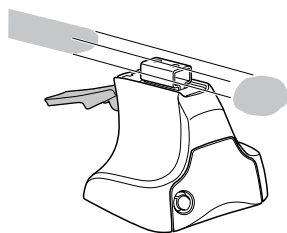

3

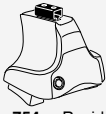

754 Rapid System

1

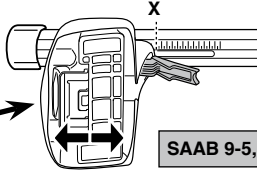
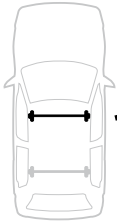

2

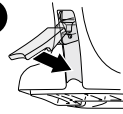

SAAB 9-5, 4-dr Sedan, 10-

X

41,5

1

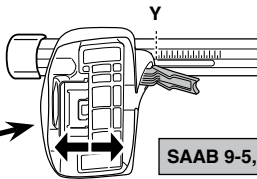
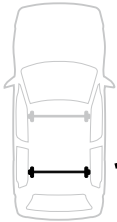

2

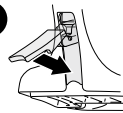

SAAB 9-5, 4-dr Sedan, 10-

Y

40



480R Rapid Traverse



480 Traverse

1

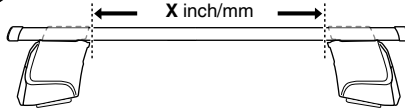

2

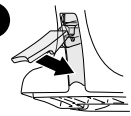

SAAB 9-5, 4-dr Sedan, 10-

X inch

X mm

42"

1066 mm

1

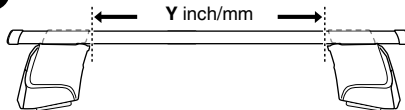

2

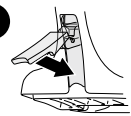

SAAB 9-5, 4-dr Sedan, 10-

Y inch

Y mm

41 3/8"

1051 mm

4

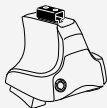

480R Rapid Traverse
754 Rapid System



480 Traverse

SAAB 9-5, 4-dr Sedan, 10-

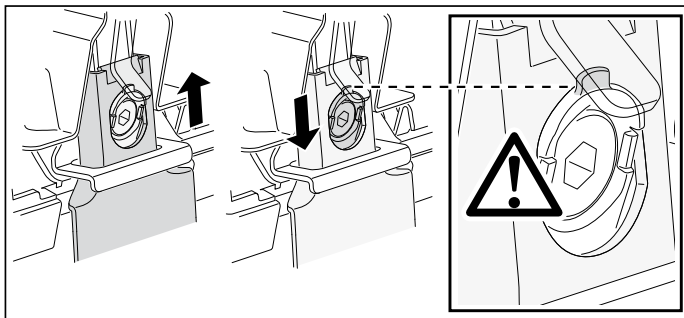
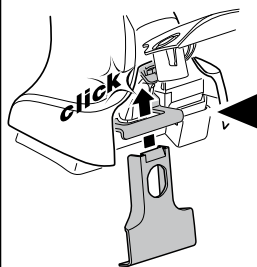
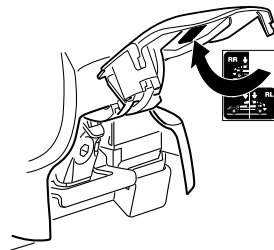
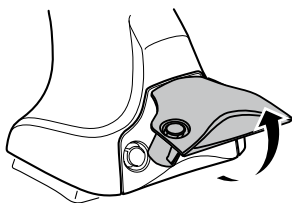
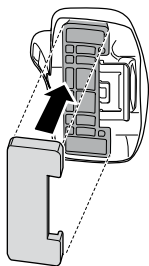
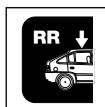
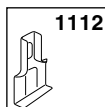
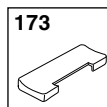
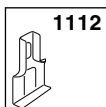
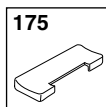
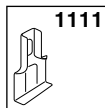
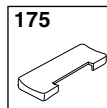
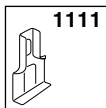
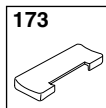

5



	X mm	Y mm	X inch	Y inch
SAAB 9-5, 4-dr Sedan, 10-	225 mm	770 mm	8 7/8"	30 3/8"

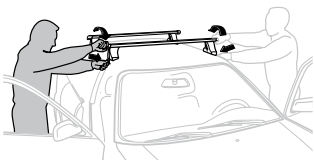
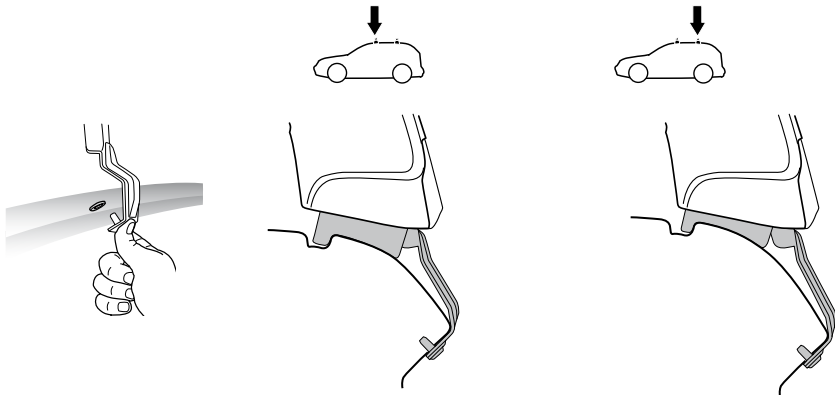
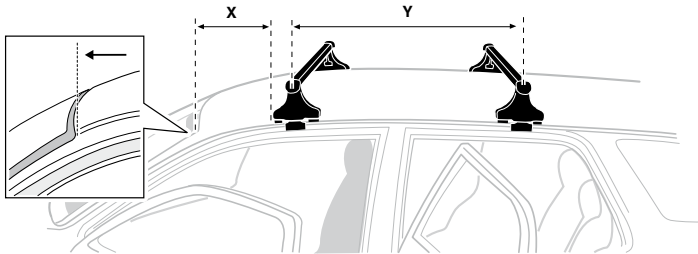

- | | | | |
|--------------|---|------------|---|
| GB/US | Tighten alternately | CZ | Pokreťta bagazníka dokrećaj dokrećaj naprzemiennie. |
| D | Die Schrauben abwechselnd anziehen | SK | Dofahujte striedavo |
| F | Serrer alternativement chaque côté | SLO | Privijajte izmenično. |
| NL | Afwisselend aan de linker- en de rechterkant aandraaien | HR | Naizmjenoćno zategnite |
| I | Alternare il serraggio delle viti | HU | Egymástól függetlenül szorítandó |
| E | Apretar alternativamente | GR | Σφιγγετε εναλλάξ |
| PT | Aperte alternadamente | TR | Dönüşümlü sıkın |
| S | Dra åt växelvis | 中文 | 交替拧紧 |
| FIN | Kierrä vuorotellen | 한국어 | 번갈아 가며 조이십시오. |
| EST | Pinguldage vaheldumisi | 日本語 | 交互に締め付けてください。 |
| LAT | Pievēlciēt pamāšus | ไทย | ขันในแบบสลับ |
| LIT | Užsukinėkite pakaitomis | | |
| PL | Śruby dokrećaj naprzemiennie | | |
| RU | Затягивайте попеременно | | |

6

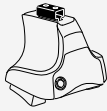

480R Rapid Traverse
754 Rapid System



480 Traverse

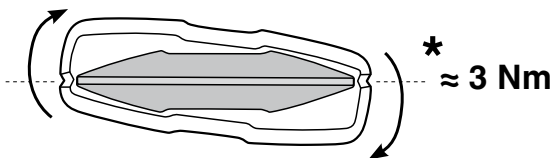
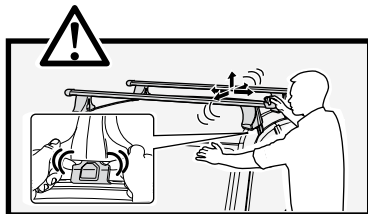
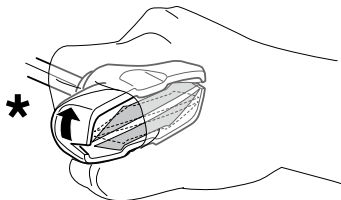
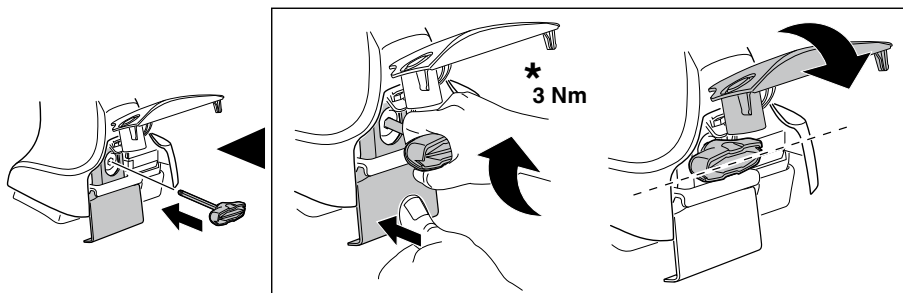

7

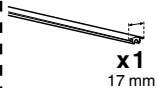



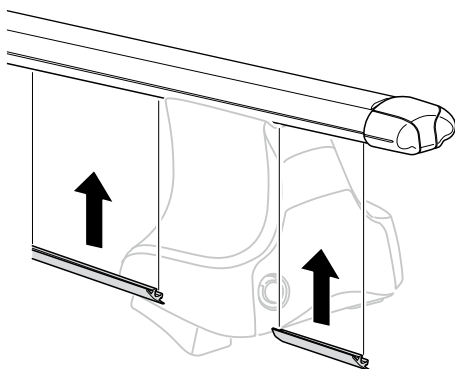

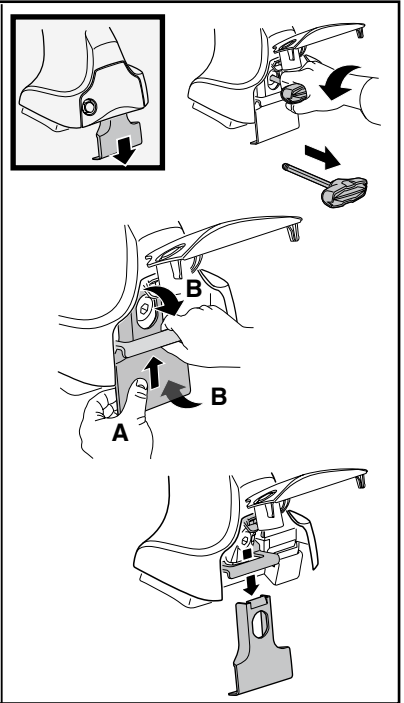
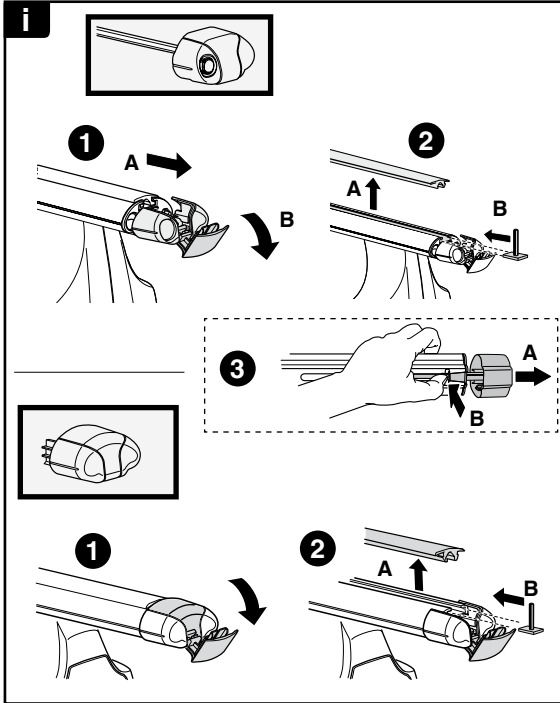
x1
17 mm



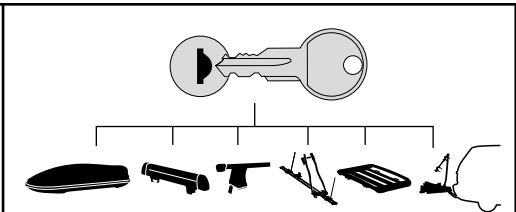

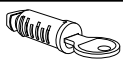
THULE
SWEDEN
**ONE
KEY
SYSTEM**



-  **544** (x4)
 -  **596** (x6)
 -  **588** (x8)
 -  **510** (x10)
 -  **452** (x12)
- NA
EUR
ASIA

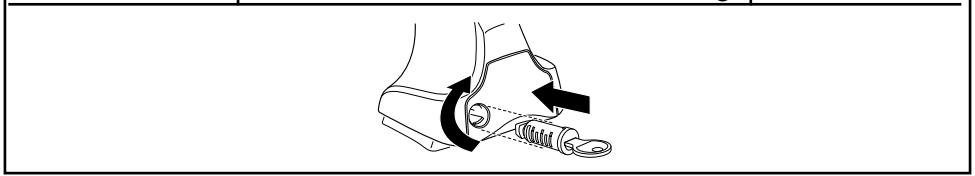

WW ▶ Thule Sweden AB, Box 69, 330 33 Hillerstorp, SWEDEN
NA ▶ Thule Inc., 42 Silvermine Road, Seymour, Connecticut 06483, USA

info@thule.com
customer.service@thule.com

 www.thule.com