

Kit 1554

HONDA Odyssey, 5-dr MPV, 09–

480R
754

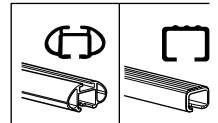
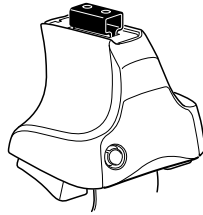

480

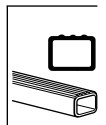
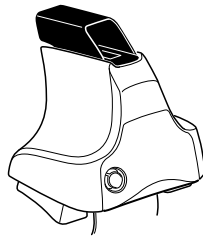

Kit

1

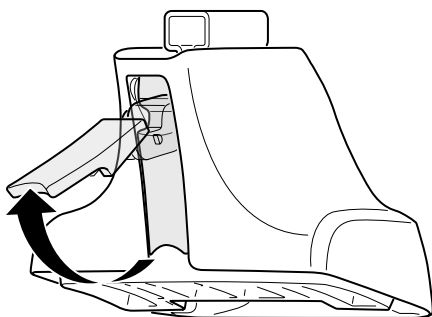
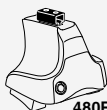

2



+

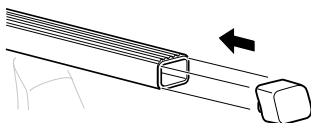
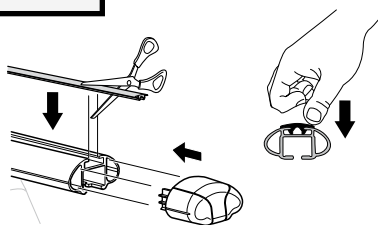
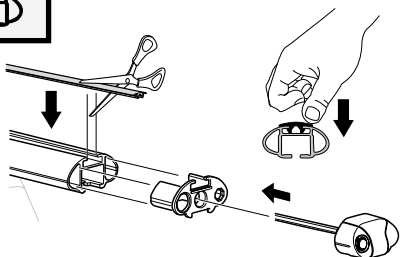
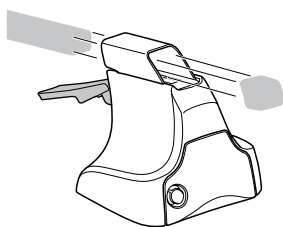
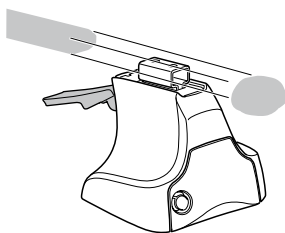

3

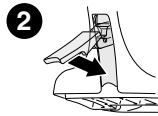
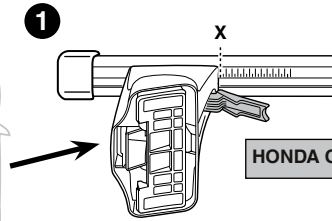
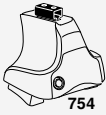

	X
HONDA Odyssey, 5-dr MPV, 09-	47,5

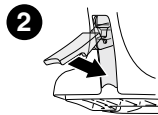
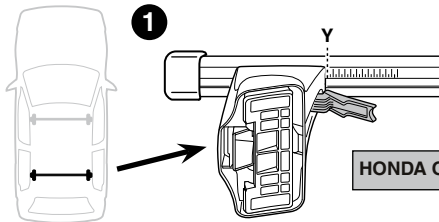

	Y
HONDA Odyssey, 5-dr MPV, 09-	42

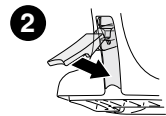
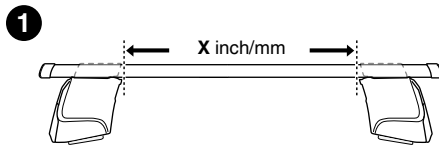
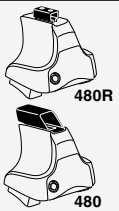

	X inch	X mm
HONDA Odyssey, 5-dr MPV, 09-	44 ³ / ₈ "	1126 mm

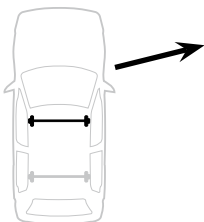

	Y inch	Y mm
HONDA Odyssey, 5-dr MPV, 09-	42 ¹ / ₈ "	1071 mm

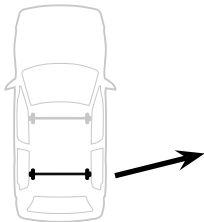

4

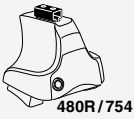

HONDA Odyssey, 5-dr MPV, 09-

04



1081



04



1081

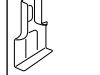

124



1082



124



1082

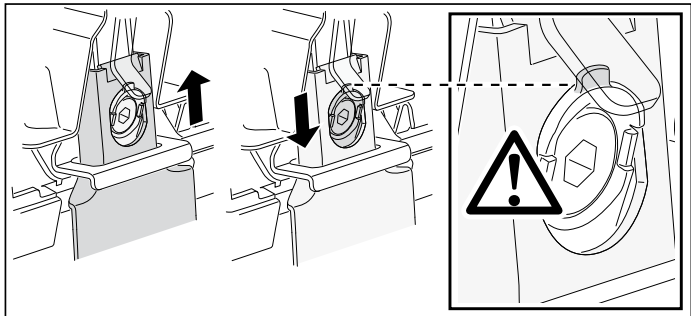
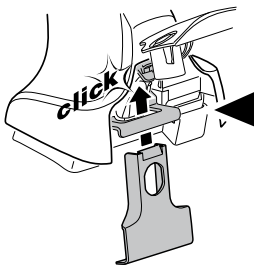
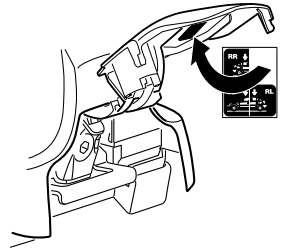
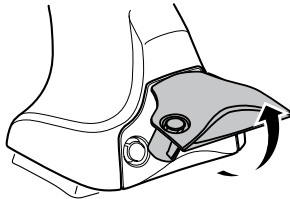
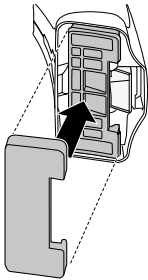
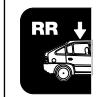

5



HONDA Odyssey, 5-dr MPV, 09-	X mm	Y mm	X inch	Y inch
	380 mm	715 mm	15"	28 1/8"

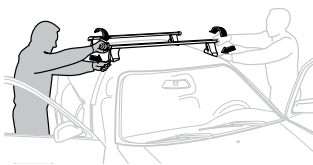
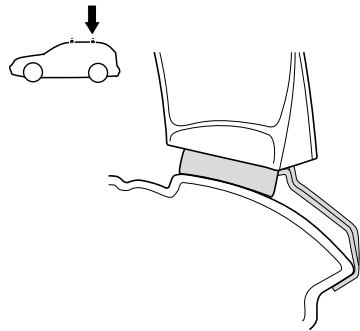
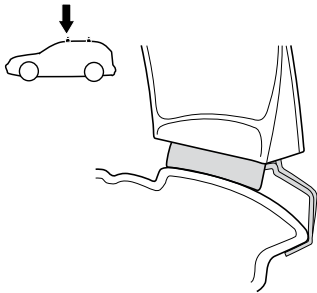
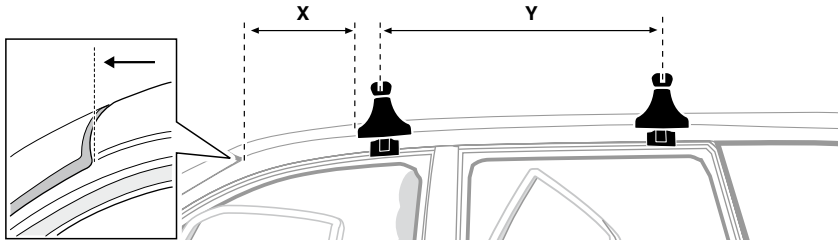

- | | | | |
|--------------|---|------------|--|
| GB/US | Tighten alternately | CZ | Pokřeřta bagážíka dokřeřcaj dokřeřcaj napřezemennie. |
| D | Die Schrauben abwechselnd anziehen | SK | Dotahujte striedavo |
| F | Serrer alternativement chaque cōtē | SLO | Privijajte izmenično. |
| NL | Afwisselend aan de linker- en de rechterkant aandraaien | HR | Naizmjenično zategnīte |
| I | Alternare il serraggio delle viti | HU | Egymástól függetlenül szorítandó |
| E | Apretar alternativamente | GR | Σφιγγετε εναλλάξ |
| PT | Aperte alternadamente | TR | Dönüşümlü sıkın |
| S | Dra åt växelvis | 中文 | 交替拧紧 |
| FIN | Kierrä vuorotellen | 한국어 | 번갈아 가며 조이십시오. |
| EST | Pinguldage vaheldumisi | 日本語 | 交互に締め付けてください。 |
| LAT | Pievēlciet pamišus | ไทย | ขันในแบบสลับ |
| LIT | Užsukinėkite pakaitomis | | |
| PL | Śruby dokręcaj naprzemiennie | | |
| RU | Затягивайте попеременно | | |

6

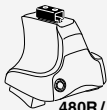

480R/754



480

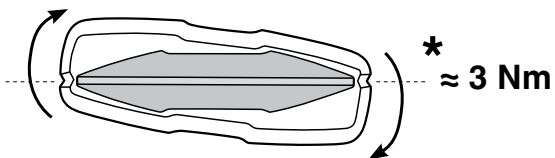
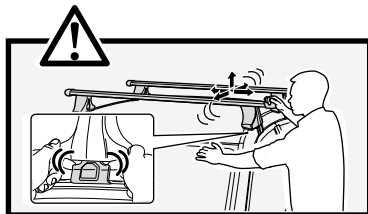
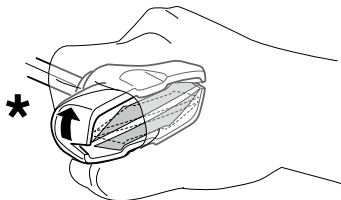
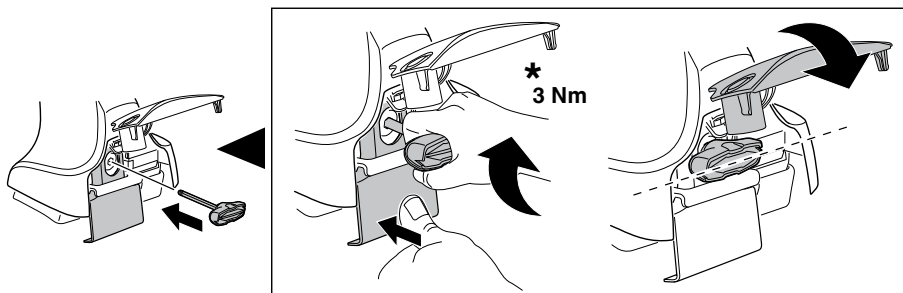

7

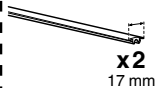

x2
17 mm

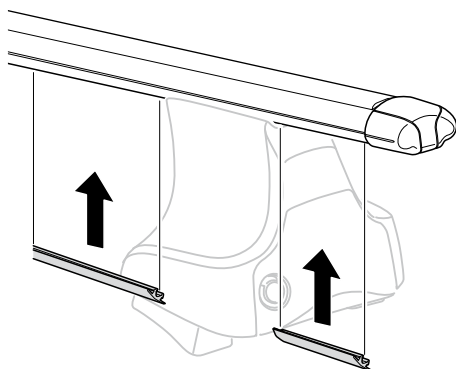

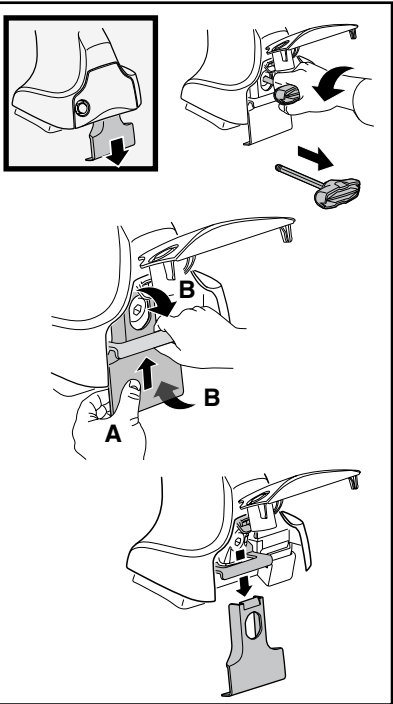
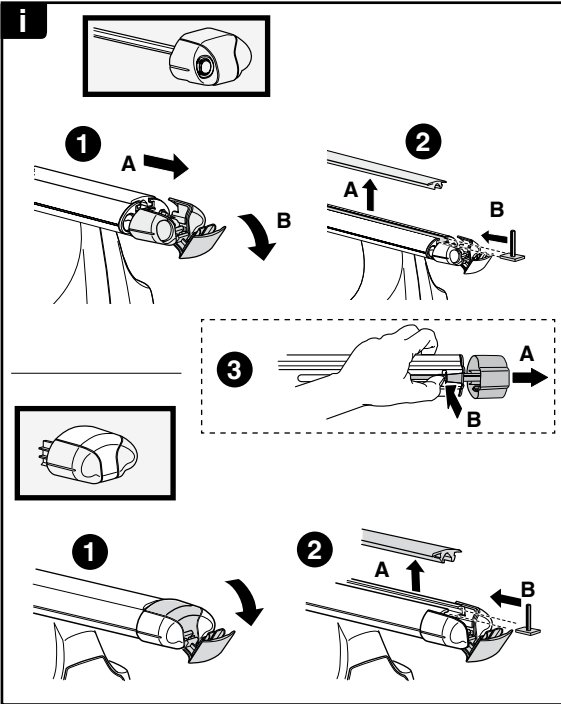
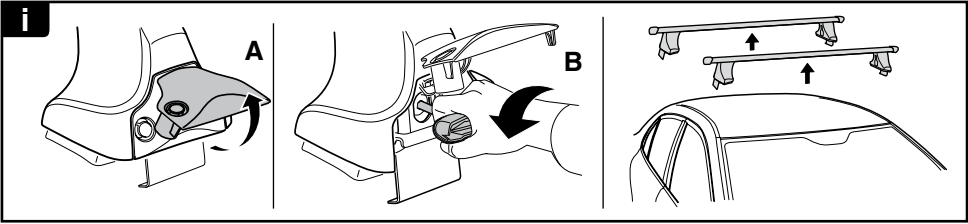

THULE
SWEDEN
**ONE
KEY
SYSTEM**

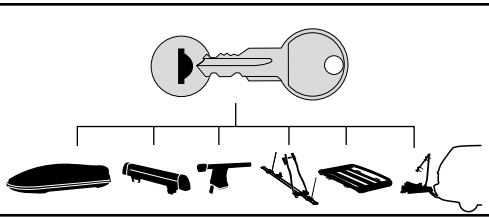

		544	(x4)
		596	(x6)
		588	(x8)
NA		510	(x10)
EUR		452	(x12)
ASIA			

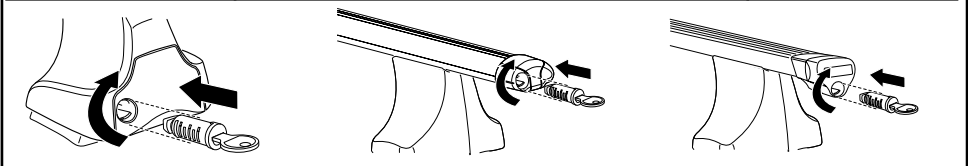

WW ▶ Thule Sweden AB, Box 69, 330 33 Hillerstorp, SWEDEN
NA ▶ Thule Inc., 42 Silvermine Road, Seymour, Connecticut 06483, USA

info@thule.com
 customer.service@thule.com

www.thule.com