

Kit 1529

FORD Fusion, 4-dr Sedan, 06-09 (NA)

LINCOLN MKZ, 4-dr Sedan, 07-09 (NA)

MERCURY Milan, 4-dr Sedan, 06-09 (NA)

480R
754

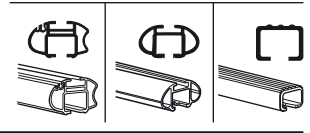
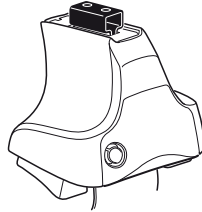

480

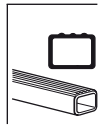
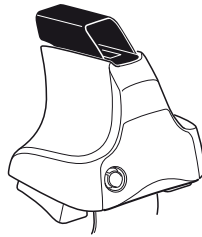

750

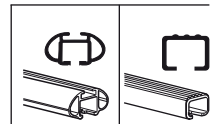
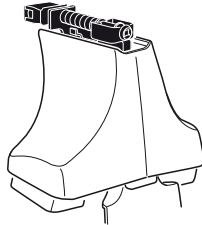

x2 x2 x2 x4	x2	x2 x2 x4 x4	x2 x2	x2	x2

Kit



3



754

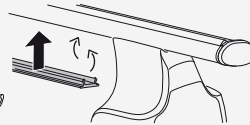
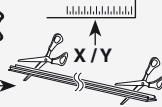

750

1

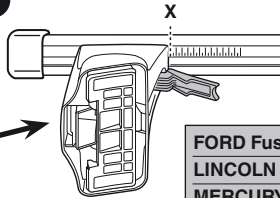
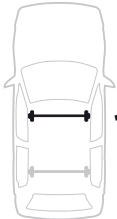

2

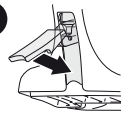

	X
FORD Fusion, 4-dr Sedan, 06-09 (NA)	38
LINCOLN MKZ, 4-dr Sedan, 07-09 (NA)	38
MERCURY Milan, 4-dr Sedan, 06-09 (NA)	38

1

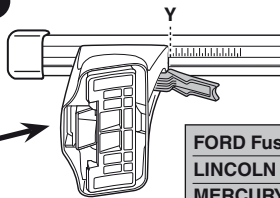
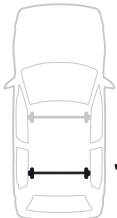

2

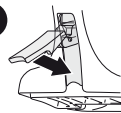

	Y
FORD Fusion, 4-dr Sedan, 06-09 (NA)	40,5
LINCOLN MKZ, 4-dr Sedan, 07-09 (NA)	40,5
MERCURY Milan, 4-dr Sedan, 06-09 (NA)	40,5



480R



480

1

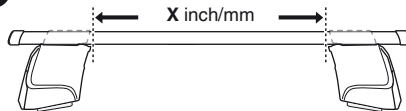

2

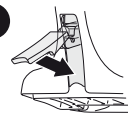

	X inch	X mm
FORD Fusion, 4-dr Sedan, 06-09 (NA)	40 ⁵/₈ "	1031 mm
LINCOLN MKZ, 4-dr Sedan, 07-09 (NA)	40 ⁵/₈ "	1031 mm
MERCURY Milan, 4-dr Sedan, 06-09 (NA)	40 ⁵/₈ "	1031 mm

1

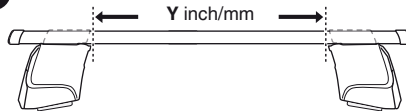

2

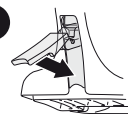

	Y inch	Y mm
FORD Fusion, 4-dr Sedan, 06-09 (NA)	41 ⁵/₈ "	1056 mm
LINCOLN MKZ, 4-dr Sedan, 07-09 (NA)	41 ⁵/₈ "	1056 mm
MERCURY Milan, 4-dr Sedan, 06-09 (NA)	41 ⁵/₈ "	1056 mm

4

FORD Fusion, 4-dr Sedan, 06-09 (NA)
 LINCOLN MKZ, 4-dr Sedan, 07-09 (NA)
 MERCURY Milan, 4-dr Sedan, 06-09 (NA)

267



733

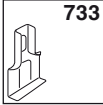

FL



266



733

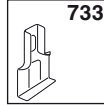

FR

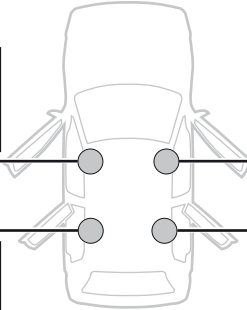

182



670

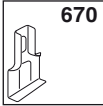

RL



182



670

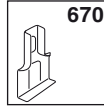

RR

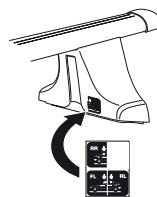
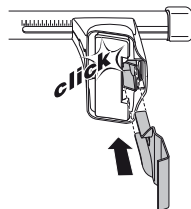
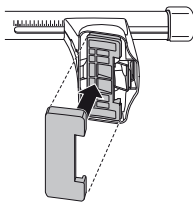
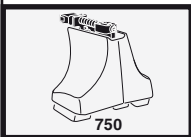
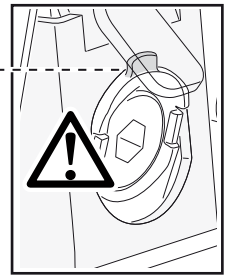
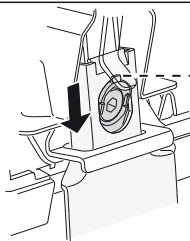
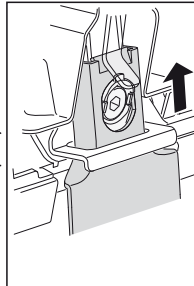
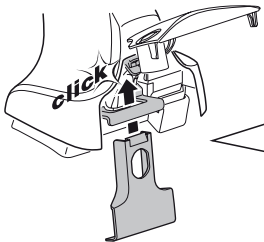
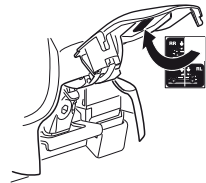
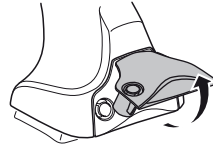
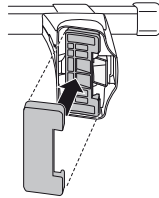
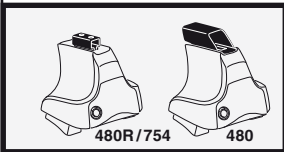

5



	X mm	Y mm	X inch	Y inch
FORD Fusion , 4-dr Sedan, 06-09 (NA)	200 mm	680 mm	7 7/8"	26 3/4"
LINCOLN MKZ , 4-dr Sedan, 07-09 (NA)	200 mm	680 mm	7 7/8"	26 3/4"
MERCURY Milan , 4-dr Sedan, 06-09 (NA)	200 mm	680 mm	7 7/8"	26 3/4"

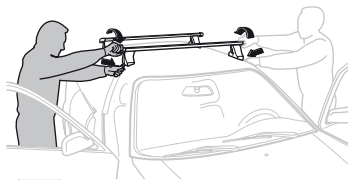
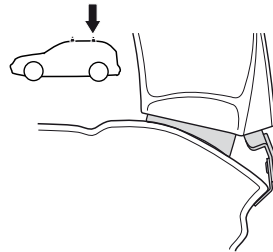
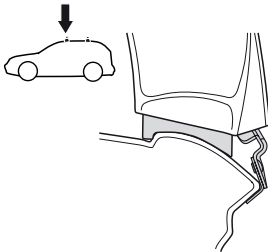
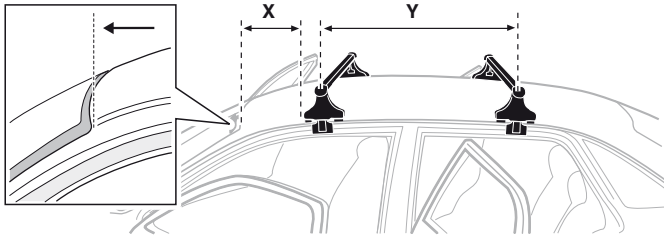

GB/US Tighten alternately

D Die Schrauben abwechselnd anziehen

F Serrer alternativement chaque côté

NL Afwisselend aan de linker- en de rechterkant aandraaien

I Alternare il serraggio delle viti

E Serrare alternativamente

PT Aperte alternadamente

S Dra åt växelvis

FIN Kierrä vuorotellen

EST Pinguldage vaheldumisi

LAT Pielieciet pamišus

LIT Užsukinėkite pakaitomis

PL Śruby dokręcaj naprzemiennie

RU Затягивайте попеременно

CZ Pokręťta bagażníka dokręcaj dokręcaj naprzemiennie.

SK Doťahujte striedavo

SLO Privijajte izmenično.

HR Naizmjenično zategnite

HU Egymástól függetlenül szorítandó

GR Σφιγγετε εναλλάξ

TR Dönüşümlü sıkın

中文 交替拧紧

한국어 번갈아 가며 조이십시오.

日本語 交互に締め付けてください。

ไทย ชั้ไนแบบสลับ

6



480R/754



480

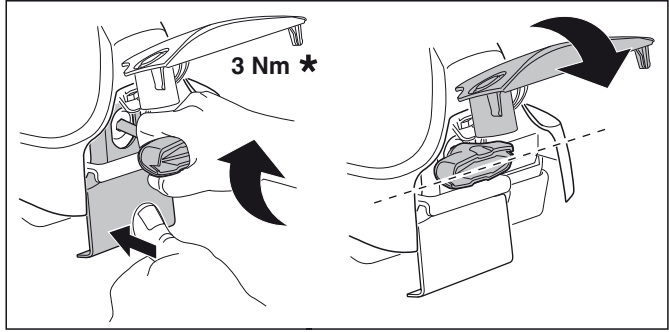
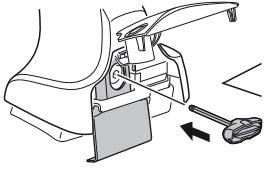

3 Nm *

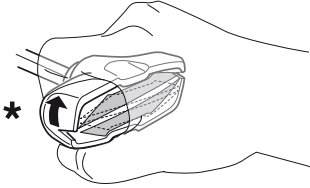

*

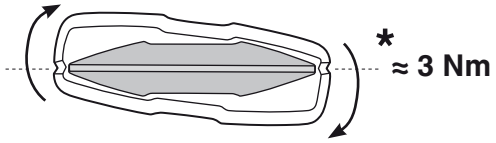

* ≈ 3 Nm



750

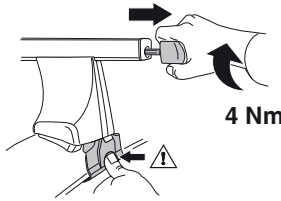

4 Nm

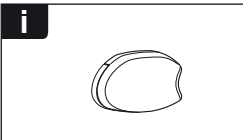
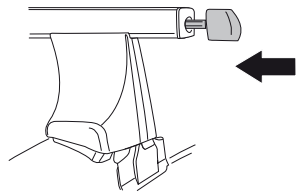

1

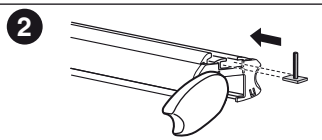

2

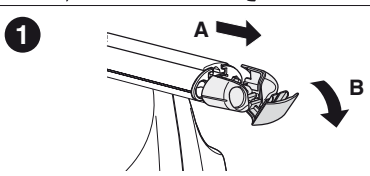
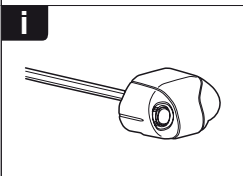

1

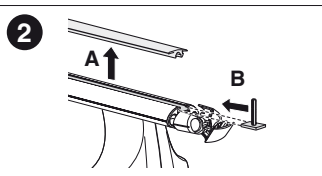

2

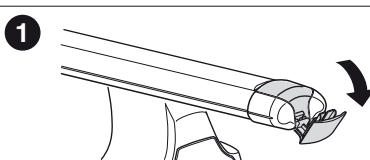
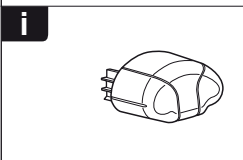

1

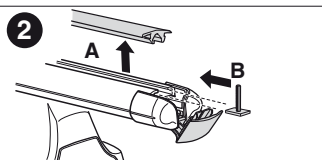

2



THULE
SWEDEN
**ONE
KEY
SYSTEM**



- 544 (x4)
- 596 (x6)
- 588 (x8)
- NA 510 (x10)
- EUR 452 (x12)
- ASIA



WW ▶ Thule Sweden AB, Box 69, 330 33 Hillerstorp, SWEDEN
NA ▶ Thule Inc., 42 Silvermine Road, Seymour, Connecticut 06483, USA

info@thule.com
customer.service@thule.com

www.thule.com