

Kit 1528

DODGE Durango, 5-dr SUV, 03-

DODGE Ram 1500, 2-dr Regular Cab, 02-08

DODGE Ram 1500, 4-dr Quad Cab, 02-08

DODGE Ram 1500, 4-dr Mega Cab, 02-08

DODGE Ram 2500/3500, 2-dr Regular Cab, 02-09

DODGE Ram 2500/3500, 4-dr Quad Cab, 02-09

DODGE Ram 2500/3500, 4-dr Mega Cab, 02-09

480R
754

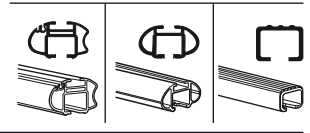
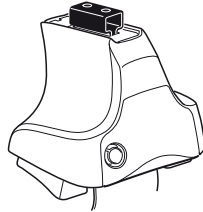

480

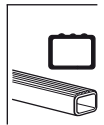
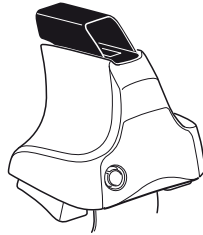

750

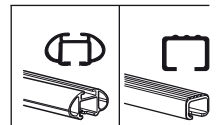
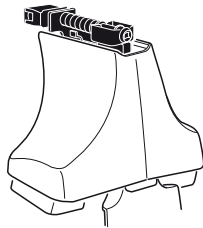

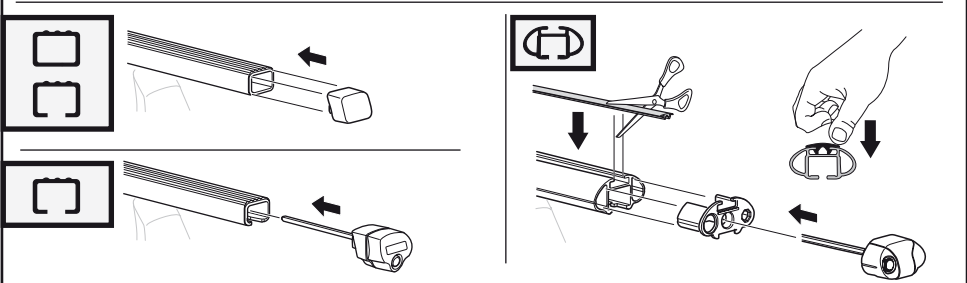
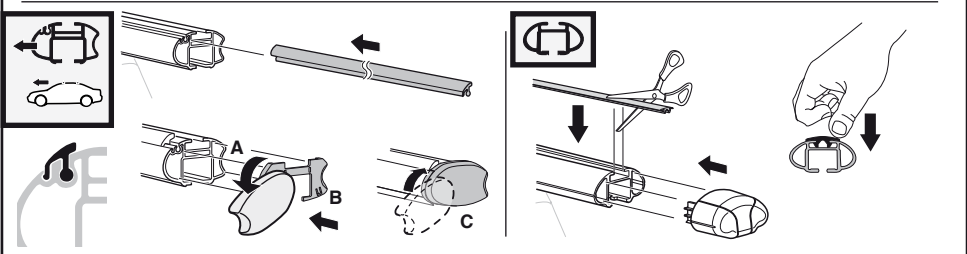
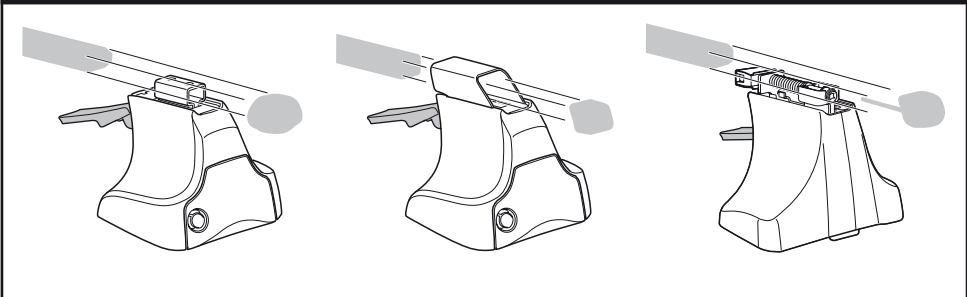
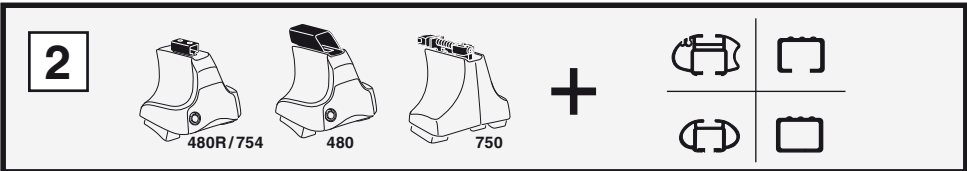
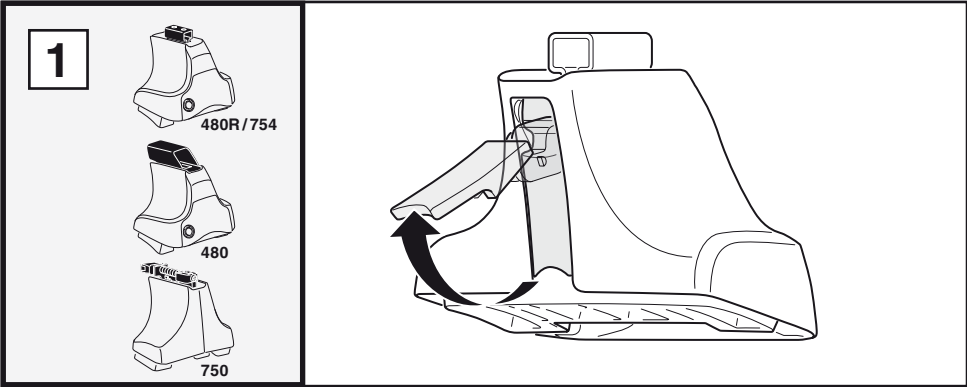

3

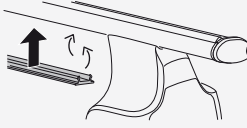
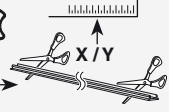

1

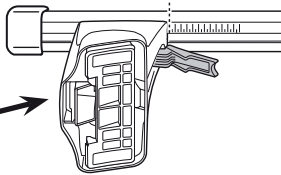

2

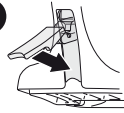

X

DODGE Durango, 5-dr SUV, 03-	46
DODGE Ram 1500, 2-dr Regular Cab, 02-08	48
DODGE Ram 1500, 4-dr Quad Cab, 02-08	48
DODGE Ram 1500, 4-dr Mega Cab, 02-08	48
DODGE Ram 2500/3500, 2-dr Regular Cab, 02-09	48
DODGE Ram 2500/3500, 4-dr Quad Cab, 02-09	48
DODGE Ram 2500/3500, 4-dr Mega Cab, 02-09	48

1

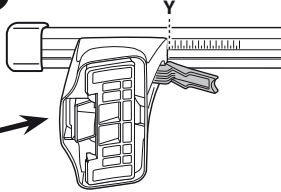

2

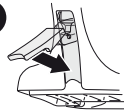

Y

DODGE Durango, 5-dr SUV, 03-	34,5
DODGE Ram 1500, 2-dr Regular Cab, 02-08	48
DODGE Ram 1500, 4-dr Quad Cab, 02-08	46
DODGE Ram 1500, 4-dr Mega Cab, 02-08	46
DODGE Ram 2500/3500, 2-dr Regular Cab, 02-09	48
DODGE Ram 2500/3500, 4-dr Quad Cab, 02-09	46
DODGE Ram 2500/3500, 4-dr Mega Cab, 02-09	46

3



480R



480

1

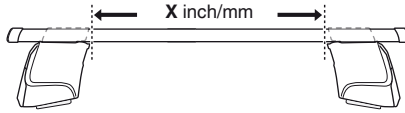

2

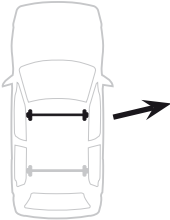

	X inch	X mm
DODGE Durango, 5-dr SUV, 03-	39 ³/₄"	1011 mm
DODGE Ram 1500, 2-dr Regular Cab, 02-08	44 ¹/₂"	1131 mm
DODGE Ram 1500, 4-dr Quad Cab, 02-08	44 ¹/₂"	1131 mm
DODGE Ram 1500, 4-dr Mega Cab, 02-08	44 ¹/₂"	1131 mm
DODGE Ram 2500/3500, 2-dr Regular Cab, 02-09	44 ¹/₂"	1131 mm
DODGE Ram 2500/3500, 4-dr Quad Cab, 02-09	44 ¹/₂"	1131 mm
DODGE Ram 2500/3500, 4-dr Mega Cab, 02-09	44 ¹/₂"	1131 mm

1

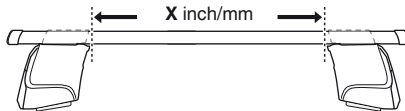

2

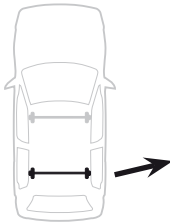

	X inch	X mm
DODGE Durango, 5-dr SUV, 03-	39 ¹/₄"	996 mm
DODGE Ram 1500, 2-dr Regular Cab, 02-08	44 ¹/₂"	1131 mm
DODGE Ram 1500, 4-dr Quad Cab, 02-08	43 ³/₄"	1111 mm
DODGE Ram 1500, 4-dr Mega Cab, 02-08	43 ³/₄"	1111 mm
DODGE Ram 2500/3500, 2-dr Regular Cab, 02-09	44 ¹/₂"	1131 mm
DODGE Ram 2500/3500, 4-dr Quad Cab, 02-09	43 ³/₄"	1111 mm
DODGE Ram 2500/3500, 4-dr Mega Cab, 02-09	43 ³/₄"	1111 mm

4

DODGE Durango, 5-dr SUV, 03-
DODGE Ram 1500, 2-dr Regular Cab, 02-08
DODGE Ram 1500, 4-dr Quad Cab, 02-08
DODGE Ram 1500, 4-dr Mega Cab, 02-08

DODGE Ram 2500/3500, 2-dr Regular Cab, 02-09
DODGE Ram 2500/3500, 4-dr Quad Cab, 02-09
DODGE Ram 2500/3500, 4-dr Mega Cab, 02-09

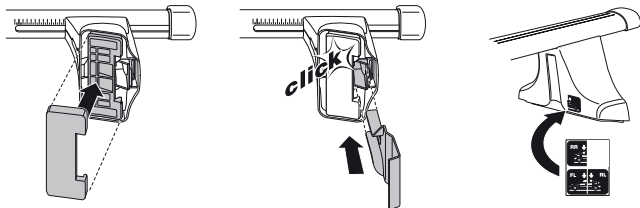
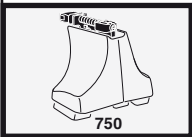
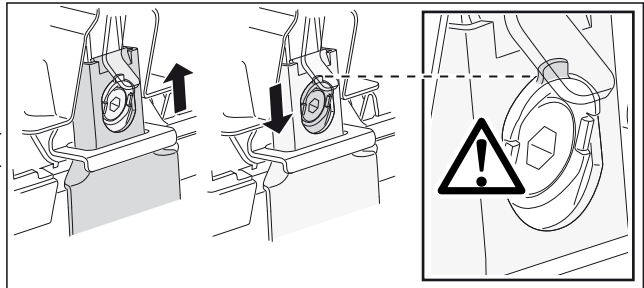
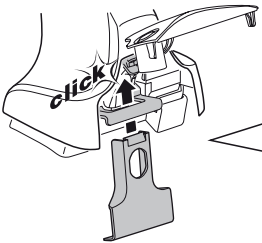
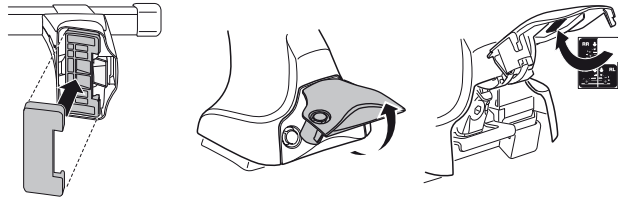
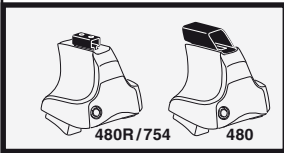
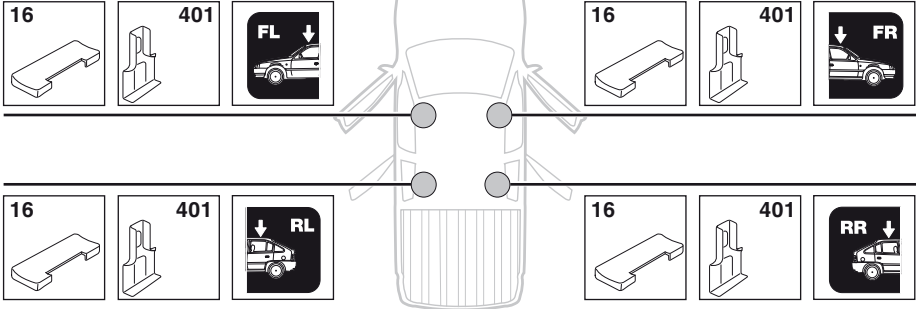

5

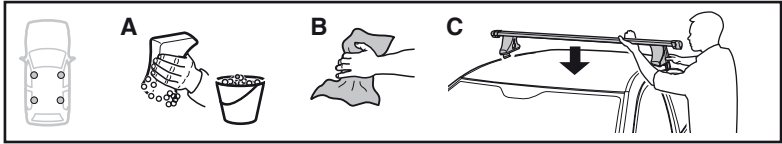

	X mm	Y mm	X inch	Y inch
DODGE Durango, 5-dr SUV, 03-	406 mm	946 mm	16"	37 1/4"
DODGE Ram 1500, 2-dr Regular Cab, 02-08	140 mm	381 mm	5 1/2"	15"
DODGE Ram 1500, 4-dr Quad Cab, 02-08	393 mm	700 mm	15 1/2"	27 1/2"
DODGE Ram 1500, 4-dr Mega Cab, 02-08	393 mm	700 mm	15 1/2"	27 1/2"
DODGE Ram 2500/3500, 2-dr Regular Cab, 02-09	140 mm	381 mm	5 1/2"	15"
DODGE Ram 2500/3500, 4-dr Quad Cab, 02-09	393 mm	700 mm	15 1/2"	27 1/2"
DODGE Ram 2500/3500, 4-dr Mega Cab, 02-09	393 mm	700 mm	15 1/2"	27 1/2"

DODGE Ram 1500, 2-dr Regular Cab, 02-08
DODGE Ram 2500/3500, 2-dr Regular Cab, 02-09

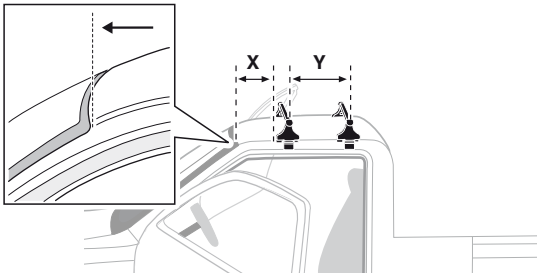

DODGE Durango, 5-dr SUV, 03-
DODGE Ram 1500, 4-dr Quad Cab, 02-08
DODGE Ram 1500, 4-dr Mega Cab, 02-08
DODGE Ram 2500/3500, 4-dr Quad Cab, 02-09
DODGE Ram 2500/3500, 4-dr Mega Cab, 02-09

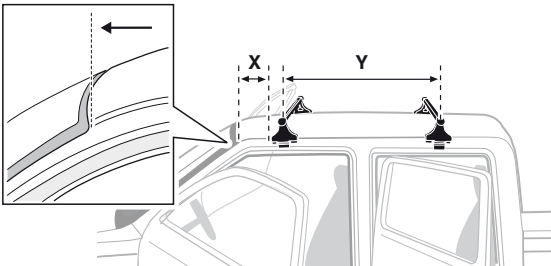

6

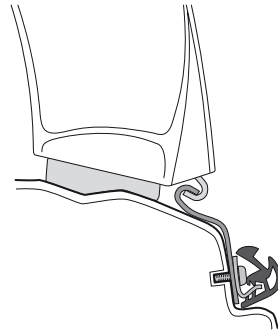
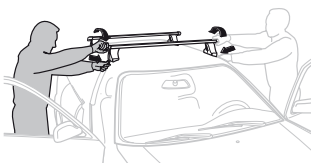
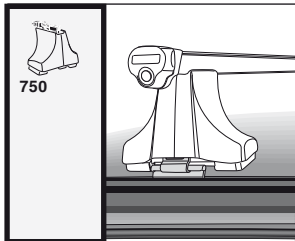
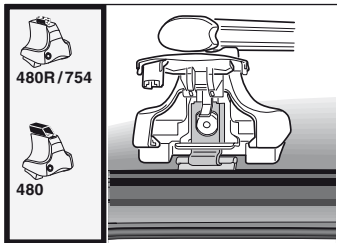
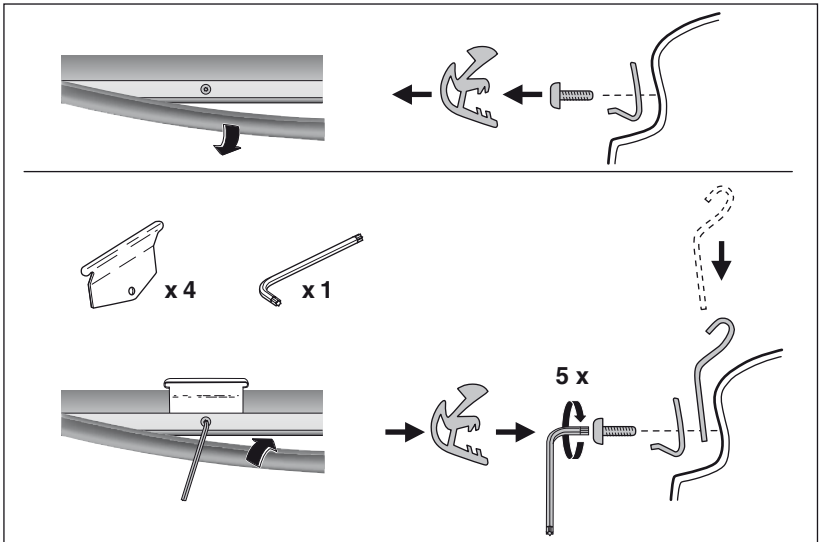

- GB/US** Tighten alternately
D Die Schrauben abwechselnd anziehen
F Serrer alternativement chaque côté
NL Afwisselend aan de linker- en de rechterkant aandraaien
I Alternare il serraggio delle viti
E Apretar alternativamente
PT Aperte alternadamente
S Dra åt växelvis
FIN Kierrä vuorotellen
EST Pinguldage vaheldumisi
LAT Pievelciēt pamišus
LIT Užsukinėkite pakaitomis
PL Śruby dokręcaj naprzemiennie
RU Затягивайте попеременно

- CZ** Pokrétla багаžníka dokręcaj dokręcaj naprzemiennie.
SK Dotiahujte striedavo
SLO Privijajte izmenično.
HR Naizmjenično zategnite
HU Egy mástól függetlenül szorítandó

- GR** Σφιγίετε εναλλάξ
TR Dönüşümlü sıkın

中文 交替拧紧

한국어 번갈아 가며 조이십시오.

日本語 交互に締め付けてください。

ไทย ขันในแบบสลับ

7



480R/754



480

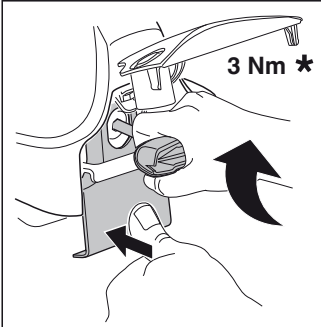
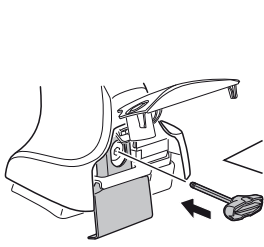

3 Nm *

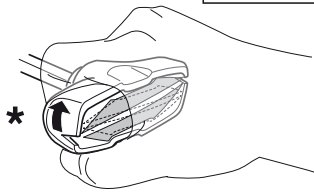
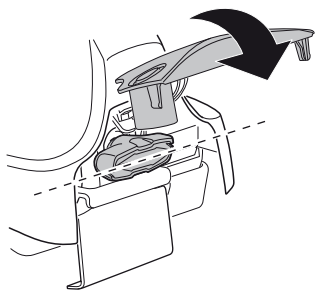

*

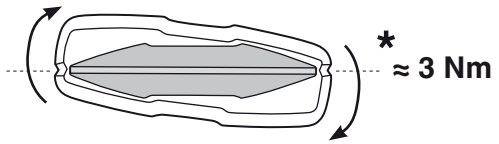

*

≈ 3 Nm

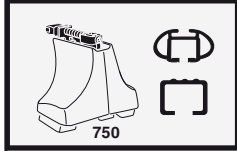

750

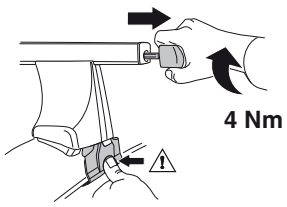



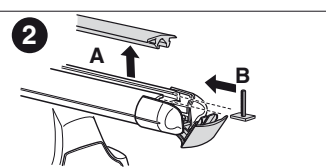
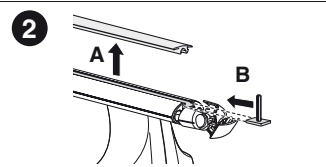
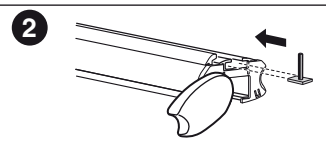
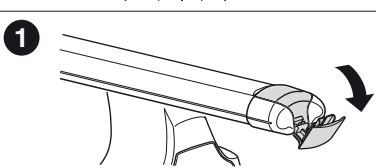
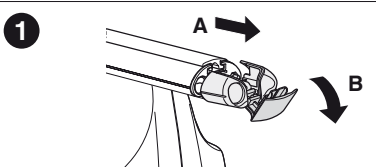
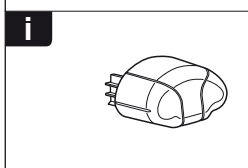
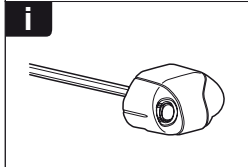
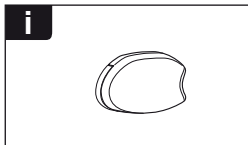
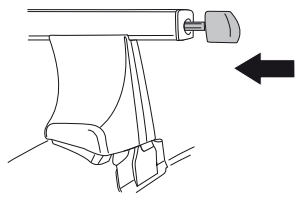

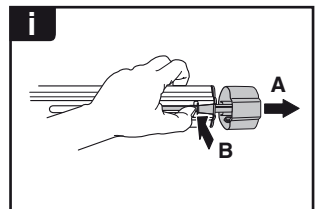
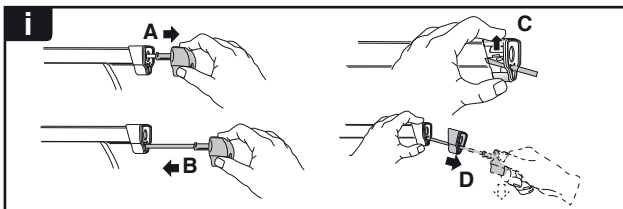
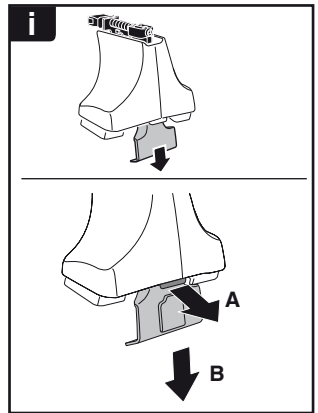
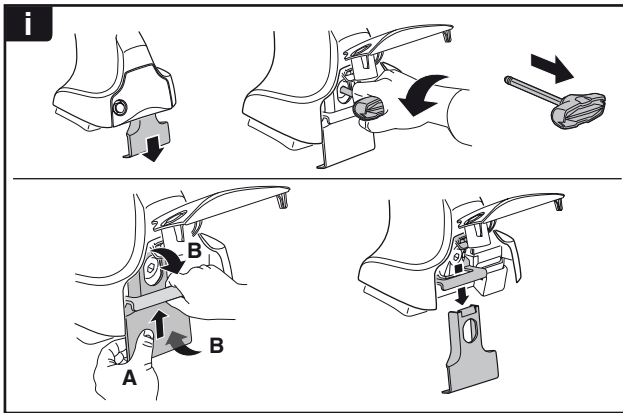
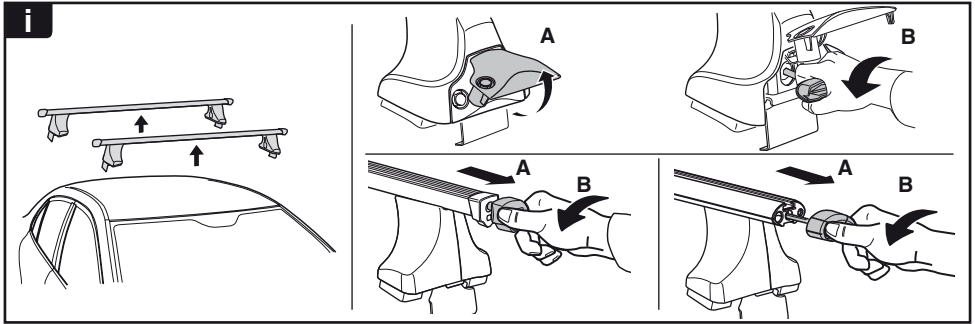

4 Nm

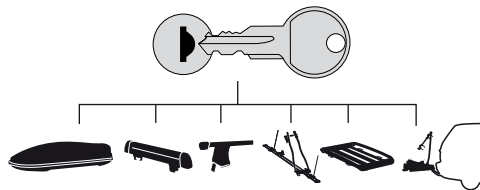



THULE
SWEDEN
**ONE
KEY
SYSTEM**



-  **544** (x4)
-  **596** (x6)
-  **588** (x8)
- NA  **510** (x10)
- EUR  **452** (x12)
- ASIA

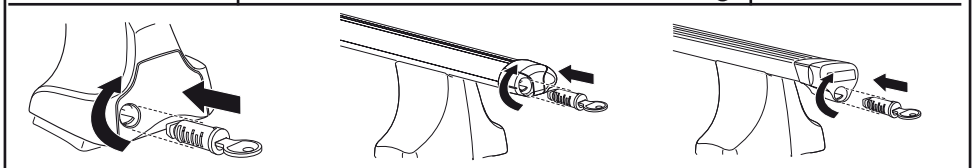

WW ▶ Thule Sweden AB, Box 69, 330 33 Hillerstorp, SWEDEN
NA ▶ Thule Inc., 42 Silvermine Road, Seymour, Connecticut 06483, USA

info@thule.com
customer.service@thule.com

 www.thule.com