

Kit 1430

NISSAN Kingcab, 4-dr Pickup Double cab, 05-*

NISSAN Navara, 4-dr Pickup Double cab, 05-*

NISSAN Pathfinder, 5-dr SUV, 05-*

* Without roofrailing

480R
754

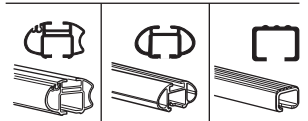
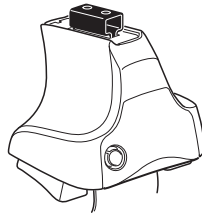

480

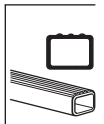
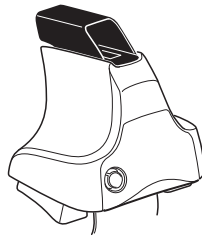

750

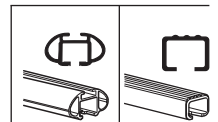
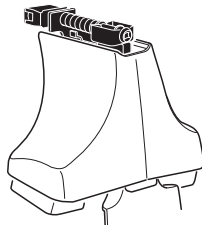

x2 x2 x2 x4	x2	x2 x2 x4 x4	x2 x2	x2

771 x 2
 864 x 2
 174 x 4
 x 1

Kit

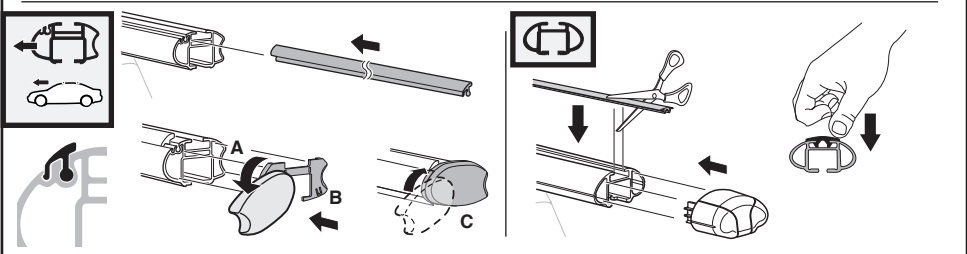

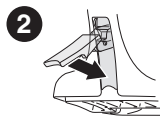
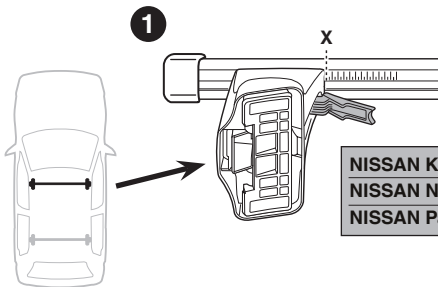
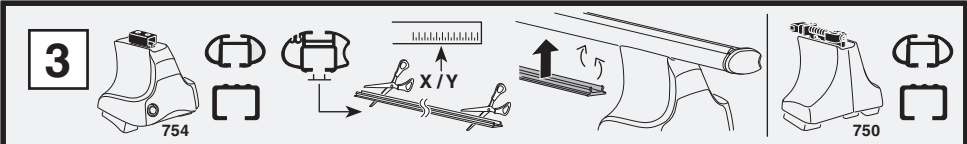

	X
NISSAN Kingcab, 4-dr Pickup Double cab, 05-	46,5
NISSAN Navara, 4-dr Pickup Double cab, 05-	46,5
NISSAN Pathfinder, 5-dr SUV, 05-	46,5

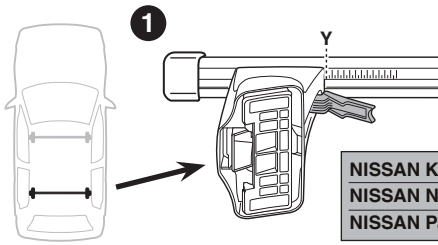

	Y
NISSAN Kingcab, 4-dr Pickup Double cab, 05-	45
NISSAN Navara, 4-dr Pickup Double cab, 05-	45
NISSAN Pathfinder, 5-dr SUV, 05-	45

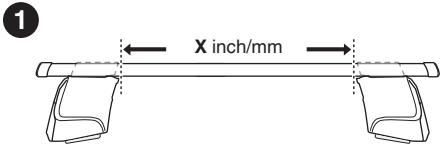
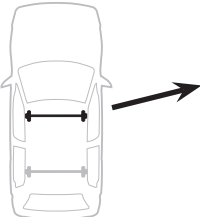
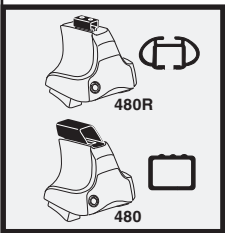

	X inch	X mm
NISSAN Kingcab, 4-dr Pickup Double cab, 05-	43 ⁷ / ₈ "	1116 mm
NISSAN Navara, 4-dr Pickup Double cab, 05-	43 ⁷ / ₈ "	1116 mm
NISSAN Pathfinder, 5-dr SUV, 05-	43 ⁷ / ₈ "	1116 mm

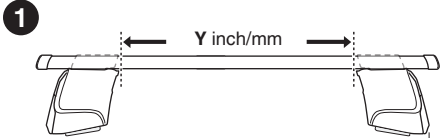
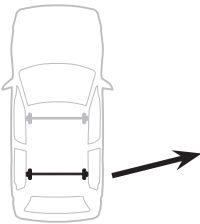

	Y inch	Y mm
NISSAN Kingcab, 4-dr Pickup Double cab, 05-	43 ³ / ₈ "	1101 mm
NISSAN Navara, 4-dr Pickup Double cab, 05-	43 ³ / ₈ "	1101 mm
NISSAN Pathfinder, 5-dr SUV, 05-	43 ³ / ₈ "	1101 mm

4

NISSAN Kingcab, 4-dr Pickup Double cab, 05-
NISSAN Navara, 4-dr Pickup Double cab, 05-
NISSAN Pathfinder, 5-dr SUV, 05-

174



771

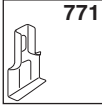

FL



174



771

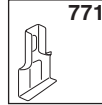

FR



174



864

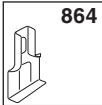

RL



174



864

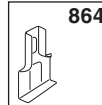

RR



480R/754



480

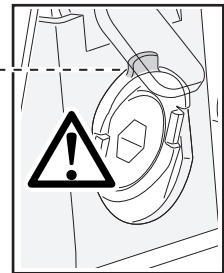
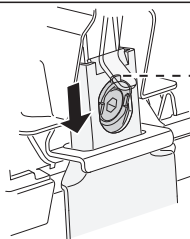
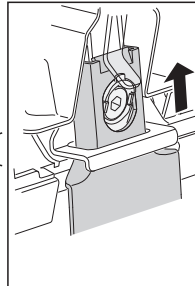
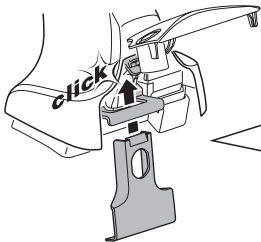
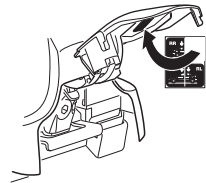
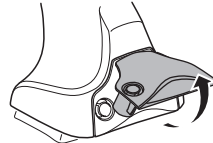
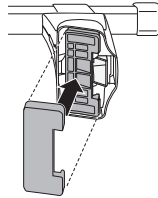

750

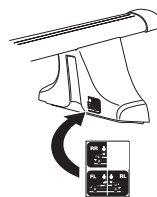
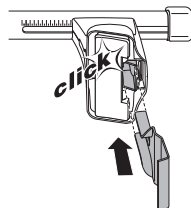
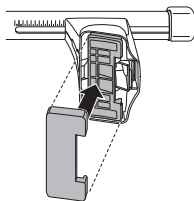

5

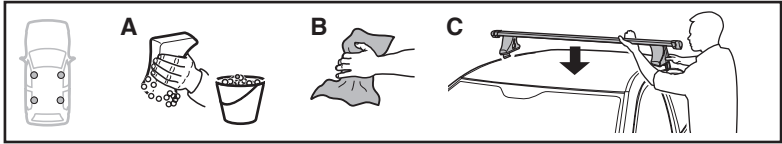

	X mm	Y mm	X inch	Y inch
NISSAN Kingcab, 4-dr Pickup Double cab, 05-	260 mm	750 mm	10 1/4"	29 1/2"
NISSAN Navara, 4-dr Pickup Double cab, 05-	260 mm	750 mm	10 1/4"	29 1/2"
NISSAN Pathfinder, 5-dr SUV, 05-	260 mm	750 mm	10 1/4"	29 1/2"

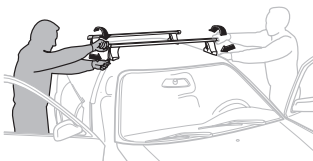
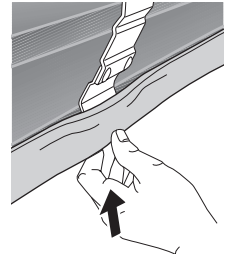
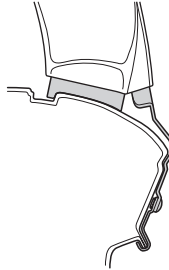
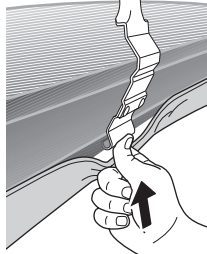
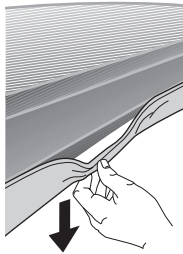
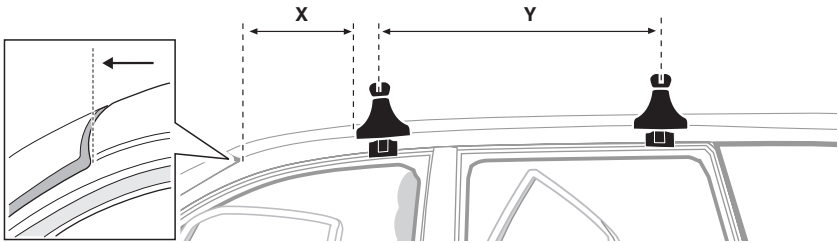

GB/US Tighten alternately
D Die Schrauben abwechselnd anziehen
F Serrer alternativement chaque côté
NL Afwisselend aan de linker- en de rechterkant aandraaien
I Alternare il serraggio delle viti
E Apretar alternativamente
PT Aperte alternadamente
S Dra åt växelvis
FIN Kierrä vuorotellen
EST Pinguldage vaheldumisi
LAT Pievelciēt pamīšus
LIT Užsukinėkite pakaitomis
PL Śruby dokręcaj naprzemiennie
RU Затягивайте попеременно

CZ Pokręťta багаžníka dokręcaj dokręcaj naprzemiennie.
SK Doťahujte striedavo
SLO Privijajte izmenično.
HR Naizmjenično zategnite
HU Egymástól függetlenül szorítandó
GR Σφιγγετε εναλλάξ
TR Dönüşümlü sıkın

中文 交替拧紧

한국어 번갈아 가며 조이십시오.

日本語 交互に締め付けてください。

ไทย ขันน๊อตแบบสลับ

6



480R/754



480

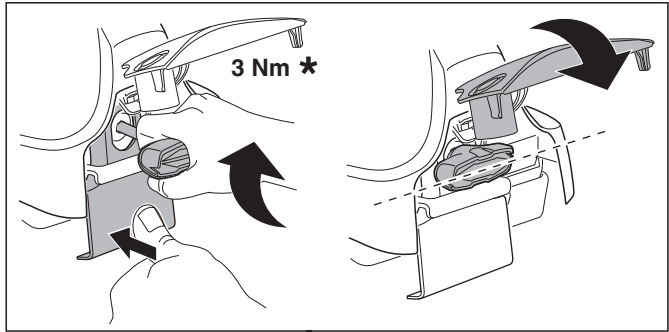
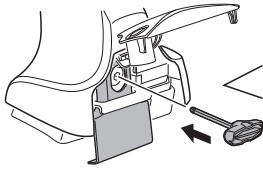

3 Nm *

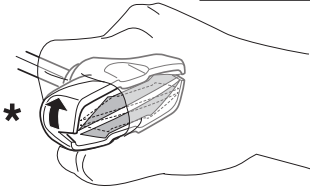

*

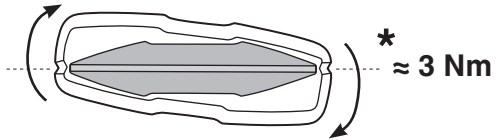

* ≈ 3 Nm



750

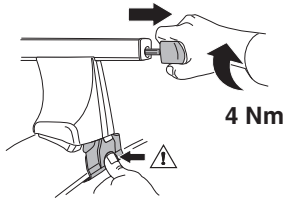

4 Nm

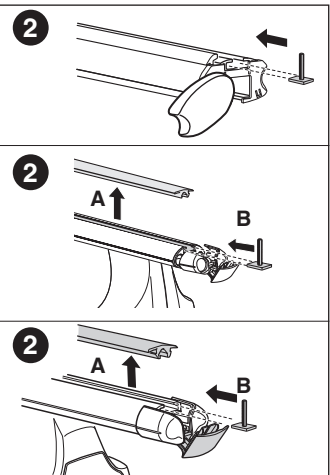
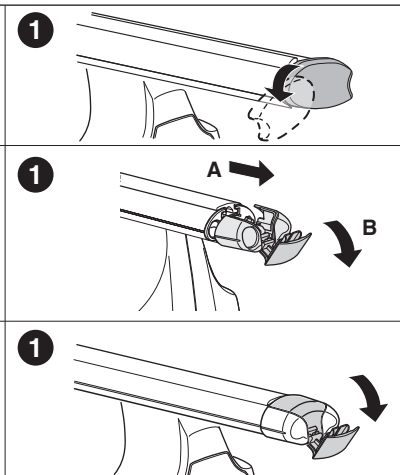
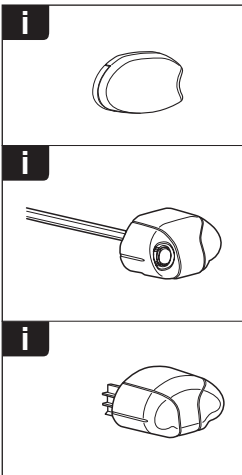
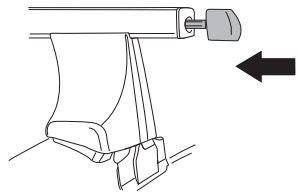

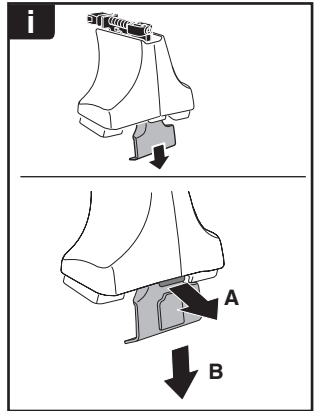
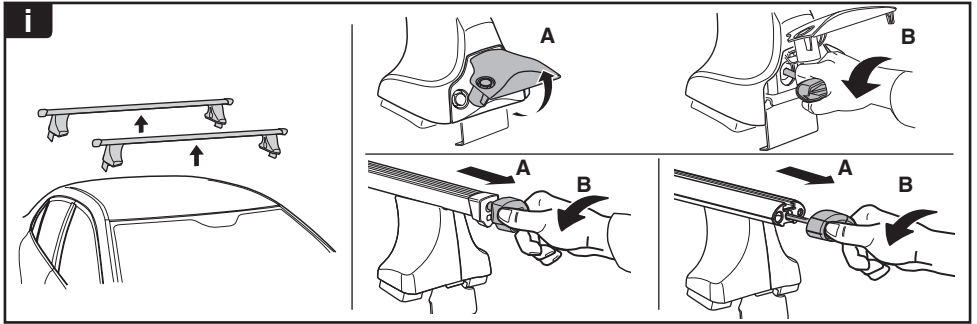

THULE
SWEDEN
**ONE
KEY
SYSTEM**



- 544 (x4)
- 596 (x6)
- 588 (x8)
- NA 510 (x10)
- EUR 452 (x12)
- ASIA



WW ▶ Thule Sweden AB, Box 69, 330 33 Hillerstorp, SWEDEN
NA ▶ Thule Inc., 42 Silvermine Road, Seymour, Connecticut 06483, USA

info@thule.com
customer.service@thule.com

www.thule.com