

# Kit 1292

**FORD Ranger**, 2-dr Single Cab, 98-02, 03-  
**FORD Ranger**, 4-dr Double Cab, 98-02, 03-  
**FORD Ranger**, 4-dr Super Cab, 98-02, 03-  
**MAZDA B-series**, 2-dr Single Cab, 98-  
**MAZDA B-series**, 4-dr Double Cab, 98-  
**MAZDA BT-50**, 2-dr Single Cab, 07-  
**MAZDA BT-50**, 4-dr Crew Cab, 07-  
**MAZDA BT-50**, 4-dr Double Cab, 07-  
**MAZDA Freestyle**, 4-dr Maxi Cab, 03-

480R  
754

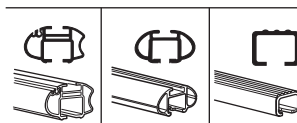
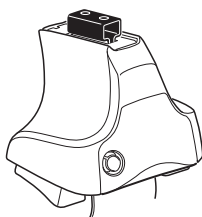

480

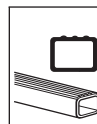
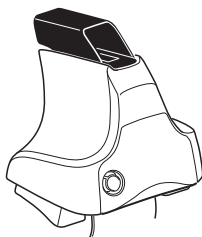

750

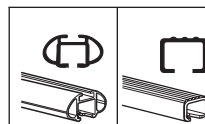
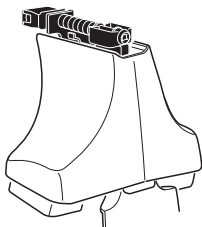

**THULE**<sup>®</sup>  
SWEDEN

x2 x2 x2 x4	x2	x2 x2 x4 x4	x2 x2	x2

**473** x 4

**01** x 4

x 1

**Kit**

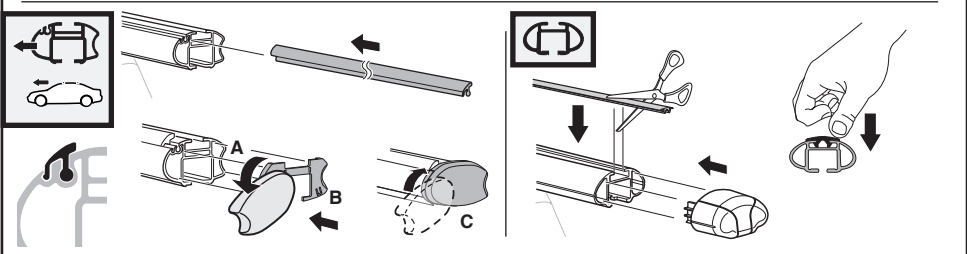
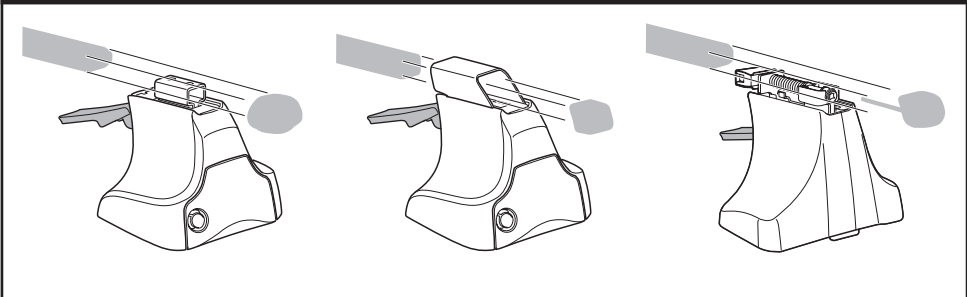

3

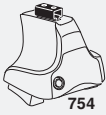

754

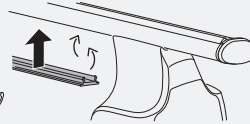
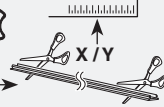

750

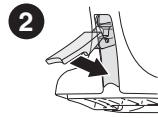
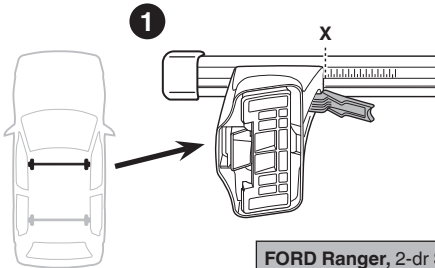

	X
<b>FORD Ranger, 2-dr Single Cab, 98-02, 03-</b>	<b>33</b>
<b>FORD Ranger, 4-dr Double Cab, 98-02, 03-</b>	<b>32,5</b>
<b>FORD Ranger, 4-dr Super Cab, 98-02, 03-</b>	<b>32,5</b>
<b>MAZDA B-series, 2-dr Single Cab, 98-</b>	<b>33</b>
<b>MAZDA B-series, 4-dr Double Cab, 98-</b>	<b>32,5</b>
<b>MAZDA BT-50, 2-dr Single Cab, 07-</b>	<b>33,5</b>
<b>MAZDA BT-50, 4-dr Crew Cab, 07-</b>	<b>33,5</b>
<b>MAZDA BT-50, 4-dr Double Cab, 07-</b>	<b>33,5</b>
<b>MAZDA Freestyle, 4-dr Maxi Cab, 03-</b>	<b>32,5</b>

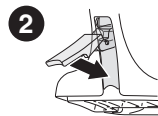
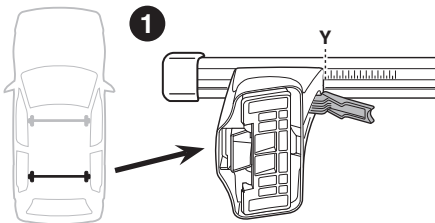

	Y
<b>FORD Ranger, 2-dr Single Cab, 98-02, 03-</b>	<b>-</b>
<b>FORD Ranger, 4-dr Double Cab, 98-02, 03-</b>	<b>32,5</b>
<b>FORD Ranger, 4-dr Super Cab, 98-02, 03-</b>	<b>32,5</b>
<b>MAZDA B-series, 2-dr Single Cab, 98-</b>	<b>-</b>
<b>MAZDA B-series, 4-dr Double Cab, 98-</b>	<b>32,5</b>
<b>MAZDA BT-50, 2-dr Single Cab, 07-</b>	<b>-</b>
<b>MAZDA BT-50, 4-dr Crew Cab, 07-</b>	<b>32,5</b>
<b>MAZDA BT-50, 4-dr Double Cab, 07-</b>	<b>32,5</b>
<b>MAZDA Freestyle, 4-dr Maxi Cab, 03-</b>	<b>32,5</b>

**3**

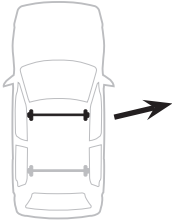
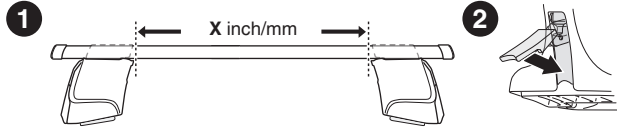

	X inch	X mm
<b>FORD Ranger, 2-dr Single Cab, 98-02, 03-</b>	<b>38 <sup>5</sup>/<sub>8</sub> "</b>	<b>981 mm</b>
<b>FORD Ranger, 4-dr Double Cab, 98-02, 03-</b>	<b>38 <sup>3</sup>/<sub>8</sub> "</b>	<b>976 mm</b>
<b>FORD Ranger, 4-dr Super Cab, 98-02, 03-</b>	<b>38 <sup>3</sup>/<sub>8</sub> "</b>	<b>976 mm</b>
<b>MAZDA B-series, 2-dr Single Cab, 98-</b>	<b>38 <sup>5</sup>/<sub>8</sub> "</b>	<b>981 mm</b>
<b>MAZDA B-series, 4-dr Double Cab, 98-</b>	<b>38 <sup>7</sup>/<sub>8</sub> "</b>	<b>986 mm</b>
<b>MAZDA BT-50, 2-dr Single Cab, 07-</b>	<b>38 <sup>7</sup>/<sub>8</sub> "</b>	<b>986 mm</b>
<b>MAZDA BT-50, 4-dr Crew Cab, 07-</b>	<b>38 <sup>7</sup>/<sub>8</sub> "</b>	<b>986 mm</b>
<b>MAZDA BT-50, 4-dr Double Cab, 07-</b>	<b>38 <sup>7</sup>/<sub>8</sub> "</b>	<b>986 mm</b>
<b>MAZDA Freestyle, 4-dr Maxi Cab, 03-</b>	<b>38 <sup>3</sup>/<sub>8</sub> "</b>	<b>976 mm</b>

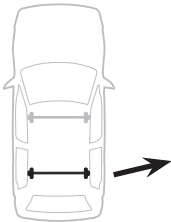
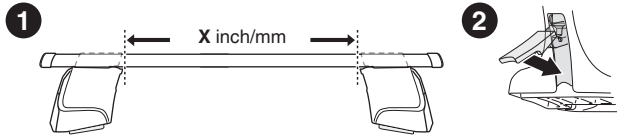

	X inch	X mm
<b>FORD Ranger, 2-dr Single Cab, 98-02, 03-</b>	-	-
<b>FORD Ranger, 4-dr Double Cab, 98-02, 03-</b>	<b>38 <sup>3</sup>/<sub>8</sub> "</b>	<b>976 mm</b>
<b>FORD Ranger, 4-dr Super Cab, 98-02, 03-</b>	<b>38 <sup>3</sup>/<sub>8</sub> "</b>	<b>976 mm</b>
<b>MAZDA B-series, 2-dr Single Cab, 98-</b>	-	-
<b>MAZDA B-series, 4-dr Double Cab, 98-</b>	<b>38 <sup>3</sup>/<sub>8</sub> "</b>	<b>976 mm</b>
<b>MAZDA BT-50, 2-dr Single Cab, 07-</b>	-	-
<b>MAZDA BT-50, 4-dr Crew Cab, 07-</b>	<b>38 <sup>3</sup>/<sub>8</sub> "</b>	<b>976 mm</b>
<b>MAZDA BT-50, 4-dr Double Cab, 07-</b>	<b>38 <sup>3</sup>/<sub>8</sub> "</b>	<b>976 mm</b>
<b>MAZDA Freestyle, 4-dr Maxi Cab, 03-</b>	<b>38 <sup>3</sup>/<sub>8</sub> "</b>	<b>976 mm</b>

**4**

**FORD Ranger, 2-dr Single Cab, 98-02, 03-**  
**MAZDA B-series, 2-dr Single Cab, 98-**  
**MAZDA BT-50, 2-dr Single Cab, 07-**

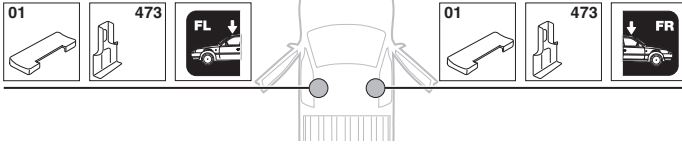

**FORD Ranger, 4-dr Double Cab, 98-02, 03-**  
**FORD Ranger, 4-dr Super Cab, 98-02, 03-**  
**MAZDA B-series, 4-dr Double Cab, 98-**  
**MAZDA BT-50, 4-dr Crew Cab, 07-**  
**MAZDA BT-50, 4-dr Double Cab, 07-**  
**MAZDA Freestyle, 4-dr Maxi Cab, 03-**

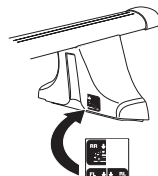
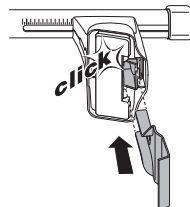
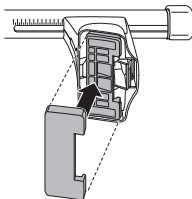
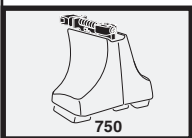
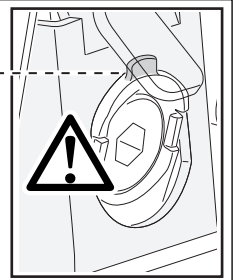
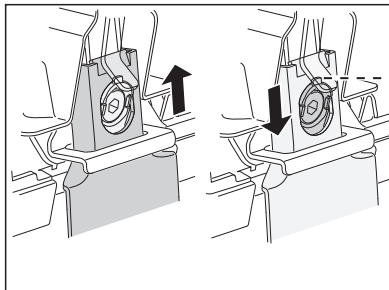
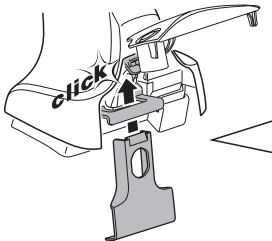
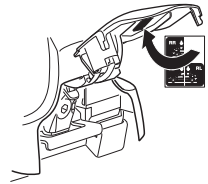
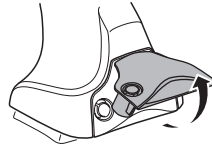
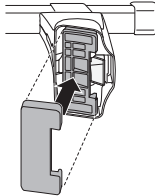
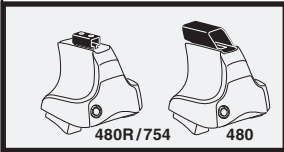
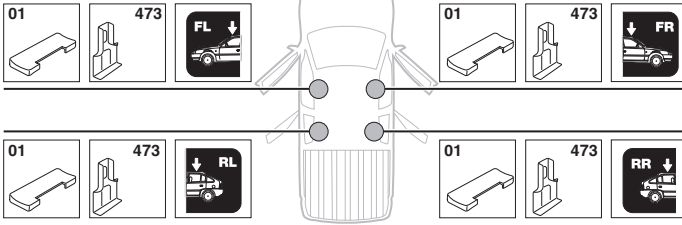

5

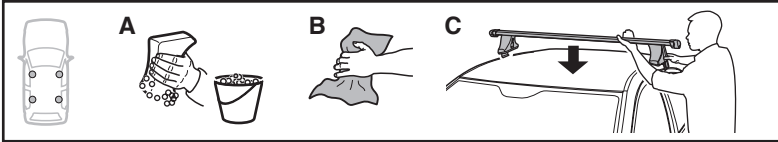

	X mm	Y mm	X inch	Y inch
<b>FORD Ranger, 2-dr Single Cab, 98-02, 03-</b>	320 mm	-	12 <sup>5</sup> / <sub>8</sub> "	-
<b>MAZDA B-series, 2-dr Single Cab, 98-</b>	320 mm	-	12 <sup>5</sup> / <sub>8</sub> "	-
<b>MAZDA BT-50, 2-dr Single Cab, 07-</b>	320 mm	-	12 <sup>5</sup> / <sub>8</sub> "	-

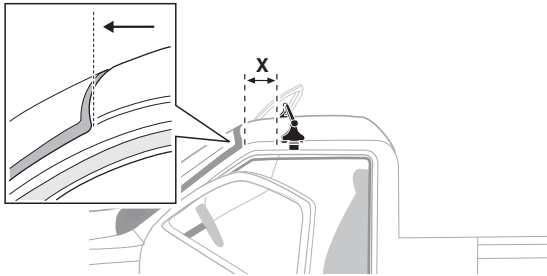

	X mm	Y mm	X inch	Y inch
<b>FORD Ranger, 4-dr Double Cab, 98-02, 03-</b>	320 mm	750 mm	12 <sup>5</sup> / <sub>8</sub> "	29 <sup>1</sup> / <sub>2</sub> "
<b>FORD Ranger, 4-dr Super Cab, 98-02, 03-</b>	320 mm	750 mm	12 <sup>5</sup> / <sub>8</sub> "	29 <sup>1</sup> / <sub>2</sub> "
<b>MAZDA B-series, 4-dr Double Cab, 98-</b>	320 mm	750 mm	12 <sup>5</sup> / <sub>8</sub> "	29 <sup>1</sup> / <sub>2</sub> "
<b>MAZDA BT-50, 4-dr Crew Cab, 07-</b>	320 mm	750 mm	12 <sup>5</sup> / <sub>8</sub> "	29 <sup>1</sup> / <sub>2</sub> "
<b>MAZDA BT-50, 4-dr Double Cab, 07-</b>	320 mm	750 mm	12 <sup>5</sup> / <sub>8</sub> "	29 <sup>1</sup> / <sub>2</sub> "
<b>MAZDA Freestyle, 4-dr Maxi Cab, 03-</b>	320 mm	750 mm	12 <sup>5</sup> / <sub>8</sub> "	29 <sup>1</sup> / <sub>2</sub> "

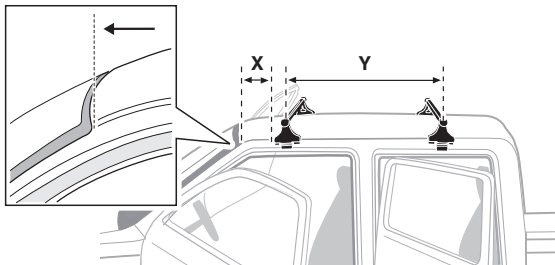

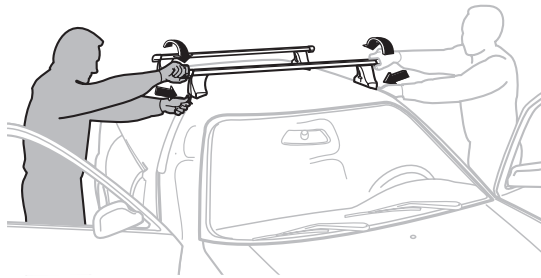
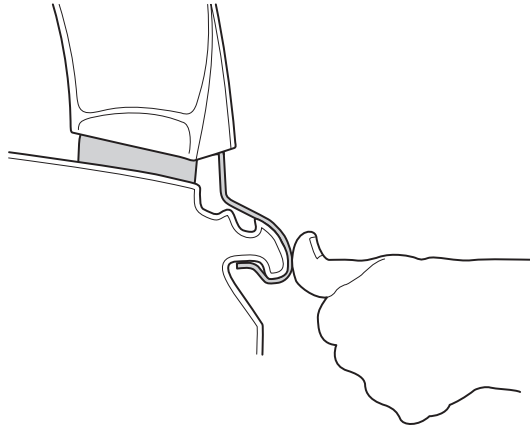
**6****GB/US** Tighten alternately**D** Die Schrauben abwechselnd anziehen**F** Serrer alternativement chaque côté**NL** Afwisselend aan de linker- en de rechterkant aandraaien**I** Alternare il serraggio delle viti**E** Serrare alternativamente**PT** Aperte alternadamente**S** Dra åt växelvis**FIN** Kierrä vuorotellen**EST** Pinguldage vaheldumisi**LAT** Pievelciet pamišus**LIT** Užsukinėkite pakaitomis**PL** Śruby dokręcaj naprzemiennie**RU** Затягивайте попеременно**CZ** Pokręťta bagažníka dokręcaj dokręcaj naprzemiennie.**SK** Doťahujte striedavo**SLO** Privijajte izmenično.**HR** Naizmjenično zategnite**HU** Egymástól függetlenül szorítandó**GR** Σφίγγετε εναλλάξ**TR** Dönüşümlü sıkın**中文** 交替拧紧**한국어** 번갈아 가며 조이십시오.**日本語** 交互に締め付けてください。**ไทย** ชันในแบบสลับ



7

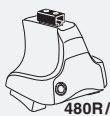

480R/754



480

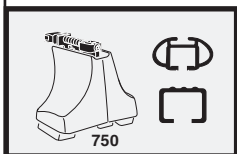
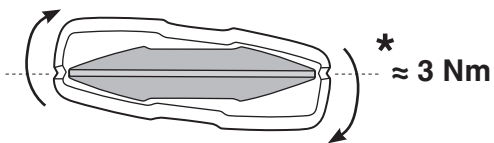
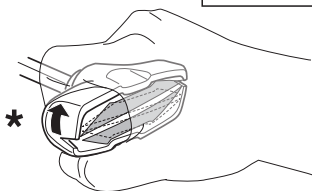
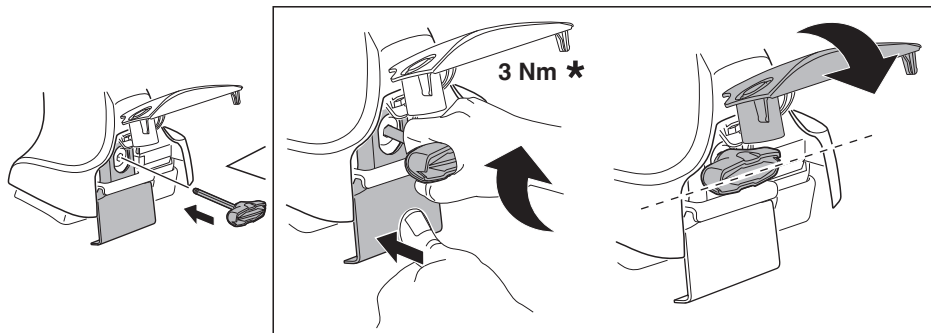

750

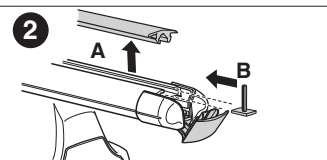
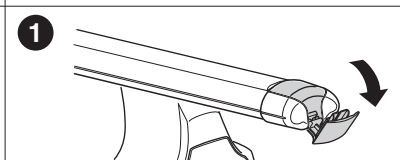
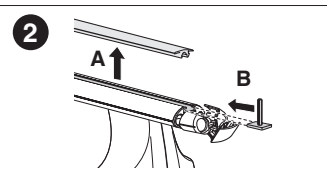
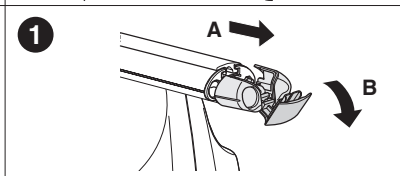
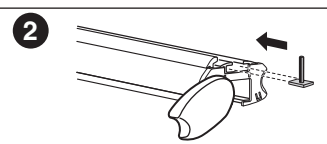
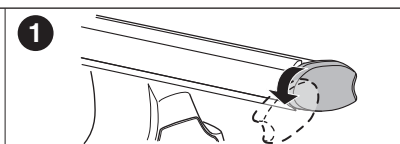
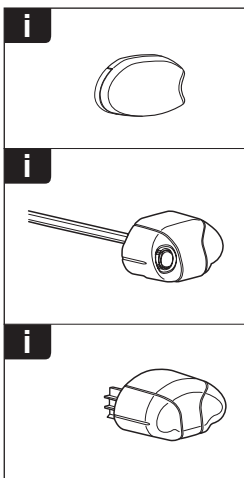
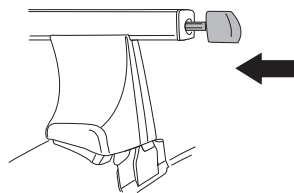
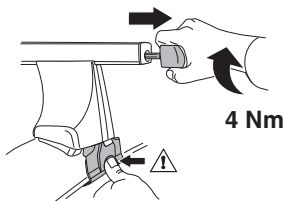

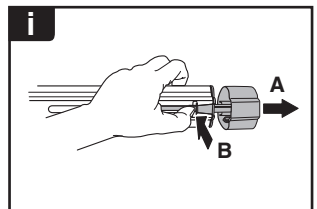
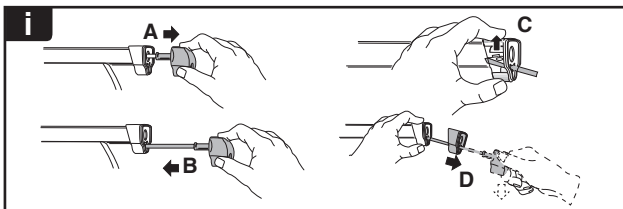
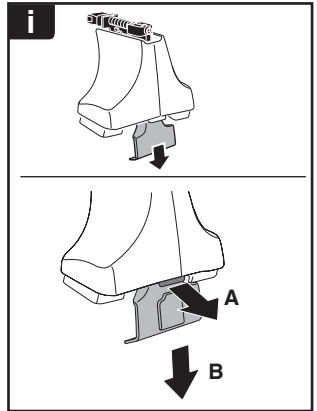
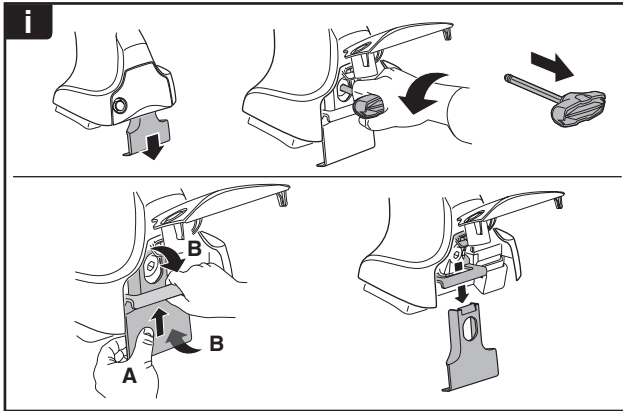
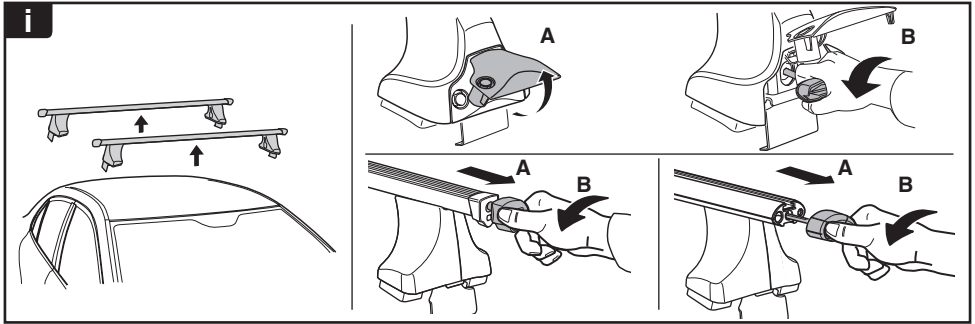

**THULE**  
SWEDEN  
**ONE  
KEY  
SYSTEM**

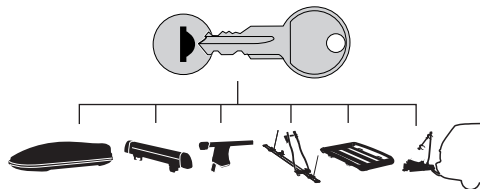

- 544 (x4)
- 596 (x6)
- 588 (x8)
- NA 510 (x10)
- EUR 452 (x12)
- ASIA

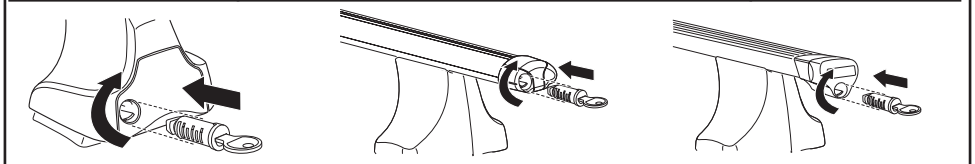

WW ▶ Thule Sweden AB, Box 69, 330 33 Hillerstorp, SWEDEN  
NA ▶ Thule Inc., 42 Silvermine Road, Seymour, Connecticut 06483, USA



info@thule.com  
customer.service@thule.com

www.thule.com



 [www.thuleprofessional.com](http://www.thuleprofessional.com)

 [info@thule.com](mailto:info@thule.com)  
[customer.service@thule.com](mailto:customer.service@thule.com)

 Thule Inc., 42 Silvermine Road, Seymour, Connecticut 06483, USA  
 Thule Sweden AB, Box 69, 330 33 Hillerstorp, SWEDEN

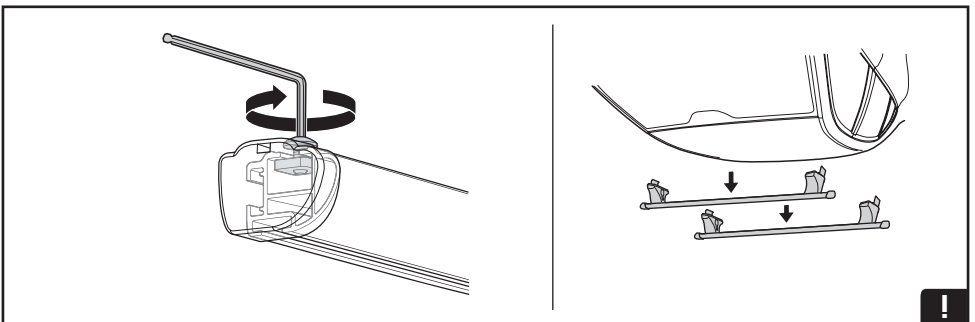
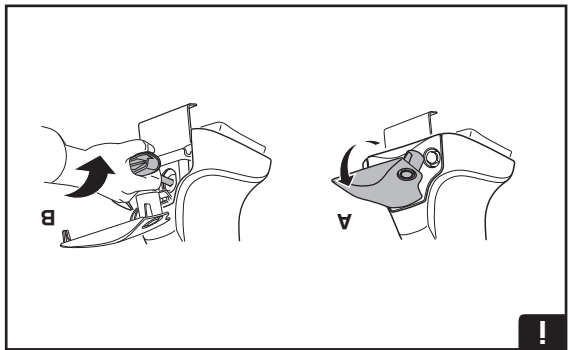
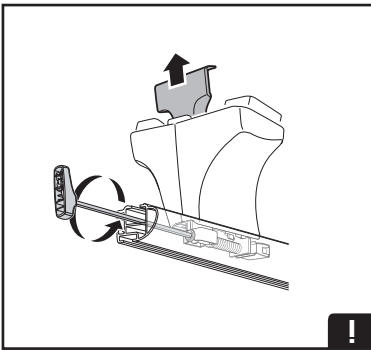
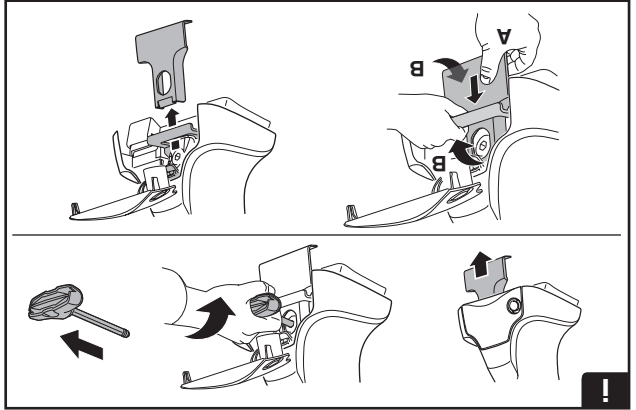
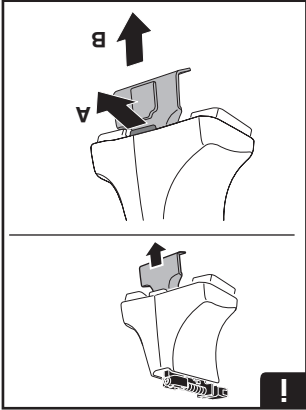

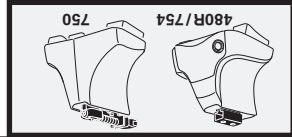
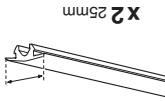
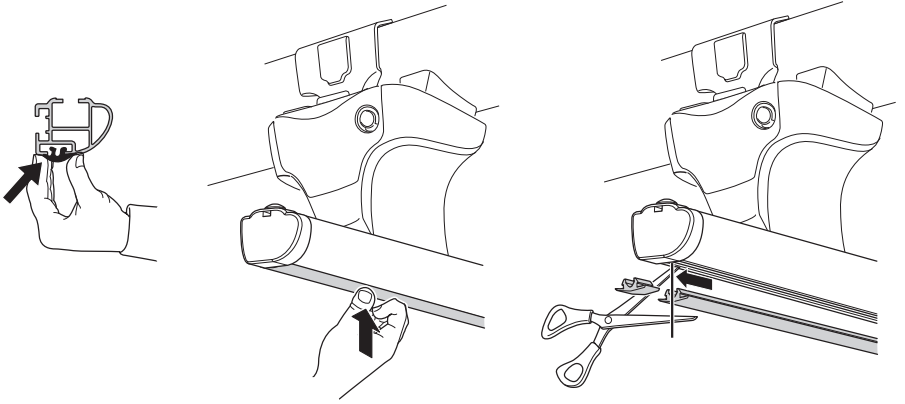

9

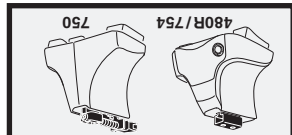
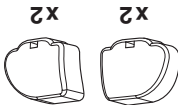
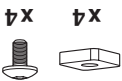
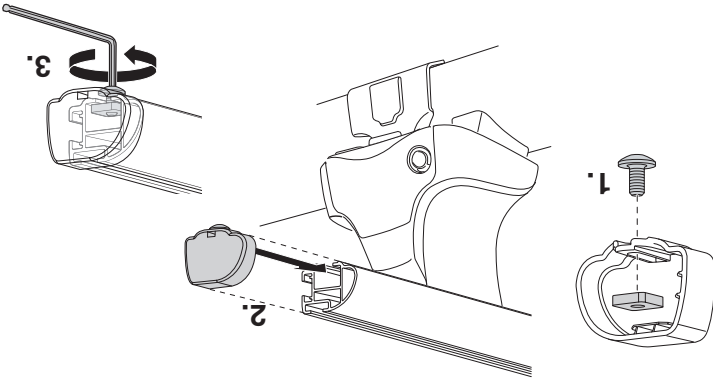

8

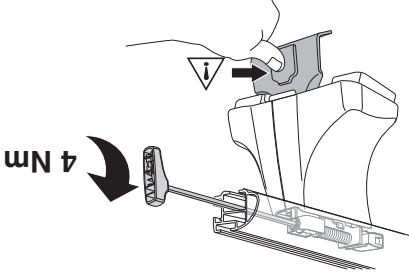
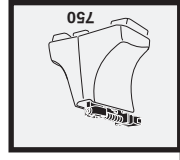

4 Nm

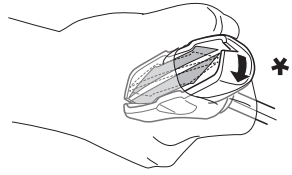

\*

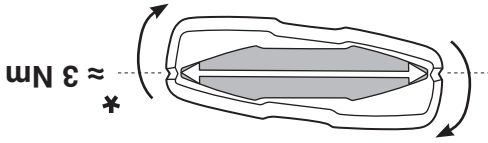

≈ 3 Nm

\*

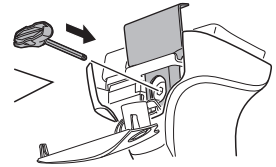
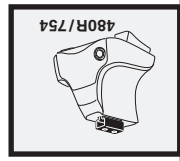

3 Nm \*

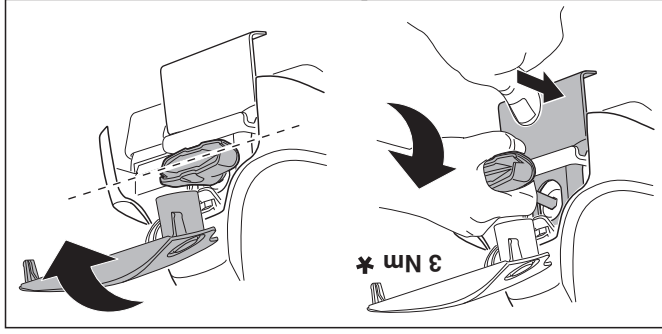

- |            |                                                        |
|------------|--------------------------------------------------------|
| GB/US      | Tighten alternately                                    |
| D          | Die Schrauben abwechselnd                              |
| F          | Serrer alternativement chaque côté                     |
| NL         | Afwisselend aan de linker- en de rechterkant aandraken |
| I          | Alternare il serraggio delle viti                      |
| E          | Serrare alternativamente                               |
| PT         | Aperte alternadamente                                  |
| S          | Dra åt växelvis                                        |
| FIN        | Kierrä vuorotellen                                     |
| EST        | Pinguldage vaheldumisi                                 |
| LAT        | Pievēciēt pārkārtām                                    |
| LIT        | Užsukinėkite pakaitomis                                |
| PL         | Słubę dokręcaj naprzemiennie                           |
| RU         | Затягивайте попеременно                                |
| CZ         | Pokřetla bagazníka dokręcaj                            |
| SK         | Dotahujte striedavo                                    |
| SLO        | Privijajte izmenično.                                  |
| HR         | Nazmjenično zategnite                                  |
| HU         | Egyenlősen fuggelentül                                 |
| GR         | Zpifyete evadáf                                        |
| TR         | Donuşunmlu skın                                        |
| 中文         | 交替拧紧                                                   |
| 한국어        | 편갈아 가며 조이십시오.                                          |
| 日本語        | 交互に締め付けてください。                                          |
| Українська |                                                        |

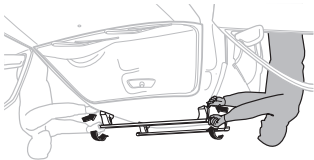
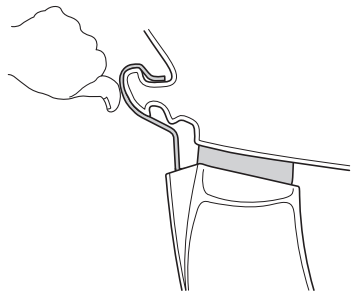

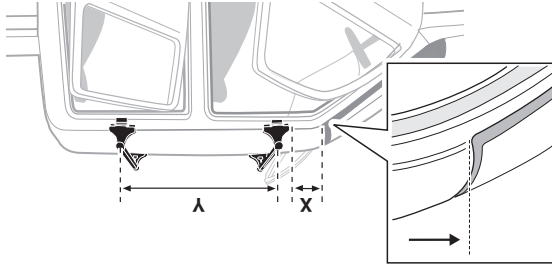

MAZDA Freestyle, 4-dr Maxi Cab, 03-	320 mm	750 mm	12 5/8"	29 1/2"
MAZDA BT-50, 4-dr Double Cab, 07-	320 mm	750 mm	12 5/8"	29 1/2"
MAZDA BT-50, 4-dr Crew Cab, 07-	320 mm	750 mm	12 5/8"	29 1/2"
MAZDA B-series, 4-dr Double Cab, 98-	320 mm	750 mm	12 5/8"	29 1/2"
FORD Ranger, 4-dr Super Cab, 98-02, 03-	320 mm	750 mm	12 5/8"	29 1/2"
FORD Ranger, 4-dr Double Cab, 98-02, 03-	320 mm	750 mm	12 5/8"	29 1/2"

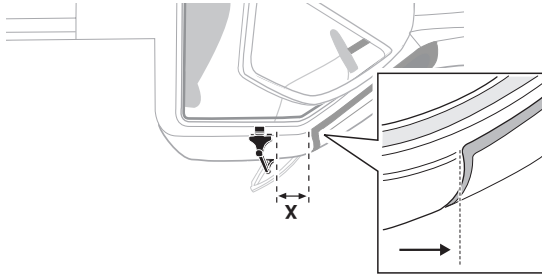

MAZDA BT-50, 2-dr Single Cab, 07-	320 mm	-	12 5/8"	-
MAZDA B-series, 2-dr Single Cab, 98-	320 mm	-	12 5/8"	-
FORD Ranger, 2-dr Single Cab, 98-02, 03-	320 mm	-	12 5/8"	-

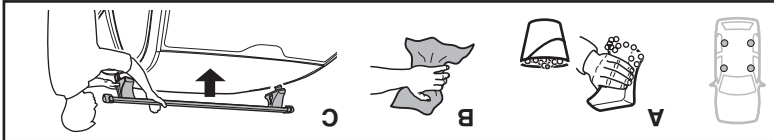

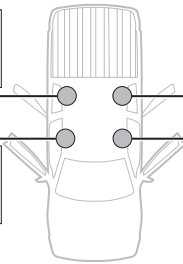
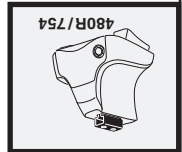
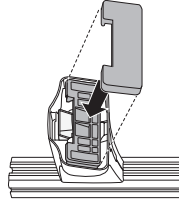
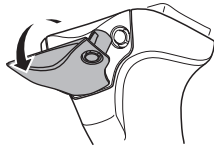
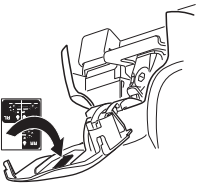
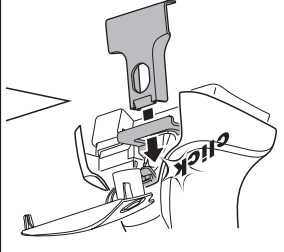
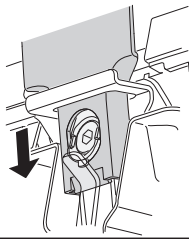
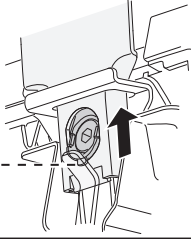
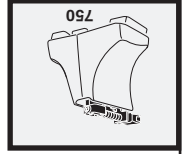
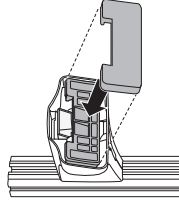
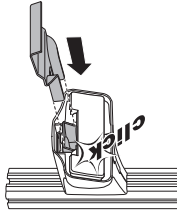
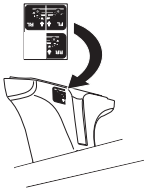

**FORD Ranger**, 4-dr Double Cab, 98-02, 03-  
**FORD Ranger**, 4-dr Super Cab, 98-02, 03-  
**MAZDA B-series**, 4-dr Double Cab, 98-  
**MAZDA BT-50**, 4-dr Crew Cab, 07-  
**MAZDA BT-50**, 4-dr Double Cab, 07-  
**MAZDA Freestyle**, 4-dr Maxi Cab, 03-

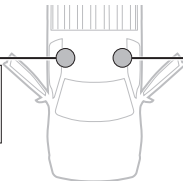

**FORD Ranger**, 2-dr Single Cab, 98-02, 03-  
**MAZDA B-series**, 2-dr Single Cab, 98-  
**MAZDA BT-50**, 2-dr Single Cab, 07-



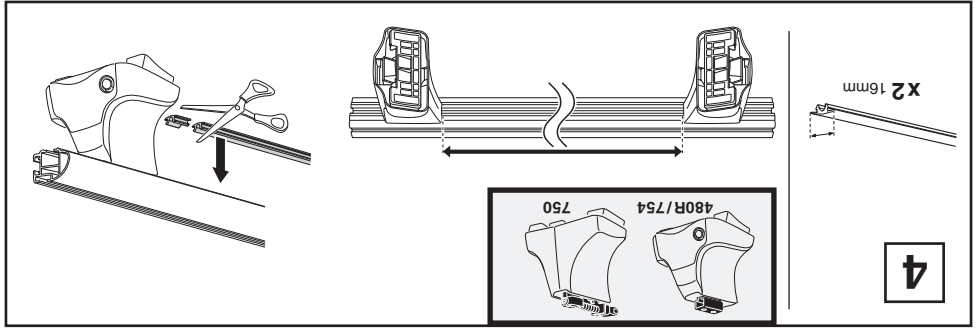

38 3/8"	976 mm	FORD Ranger, 2-dr Single Cab, 98-02, 03-
38 3/8"	976 mm	FORD Ranger, 4-dr Double Cab, 98-02, 03-
38 3/8"	976 mm	FORD Ranger, 4-dr Super Cab, 98-02, 03-
38 3/8"	976 mm	MAZDA B-series, 2-dr Single Cab, 98-
38 3/8"	976 mm	MAZDA B-series, 4-dr Double Cab, 98-
38 3/8"	976 mm	MAZDA BT-50, 2-dr Single Cab, 07-
38 3/8"	973 mm	MAZDA BT-50, 4-dr Crew Cab, 07-
38 3/8"	973 mm	MAZDA BT-50, 4-dr Double Cab, 07-
38 3/8"	976 mm	MAZDA Freestyle, 4-dr Maxi Cab, 03-

**1**

38 7/8"	981 mm	FORD Ranger, 2-dr Single Cab, 98-02, 03-
38 3/8"	976 mm	FORD Ranger, 4-dr Double Cab, 98-02, 03-
38 3/8"	976 mm	FORD Ranger, 4-dr Super Cab, 98-02, 03-
38 3/8"	981 mm	MAZDA B-series, 2-dr Single Cab, 98-
38 3/8"	976 mm	MAZDA B-series, 4-dr Double Cab, 98-
38 7/8"	986 mm	MAZDA BT-50, 2-dr Single Cab, 07-
38 7/8"	986 mm	MAZDA BT-50, 4-dr Crew Cab, 07-
38 7/8"	986 mm	MAZDA BT-50, 4-dr Double Cab, 07-
38 7/8"	976 mm	MAZDA Freestyle, 4-dr Maxi Cab, 03-

**2**

**3**

**4**

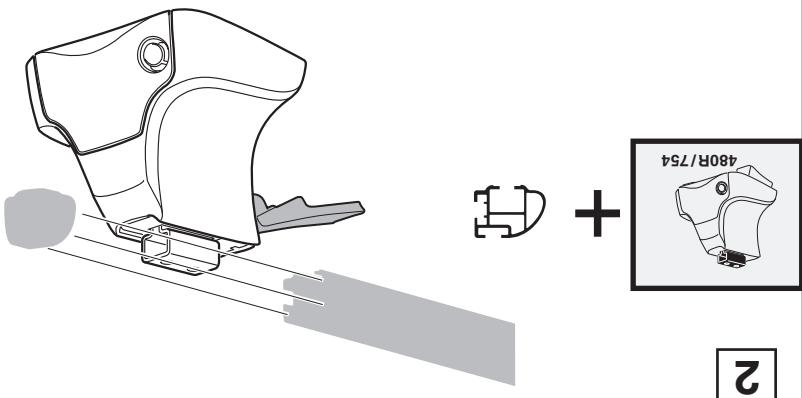
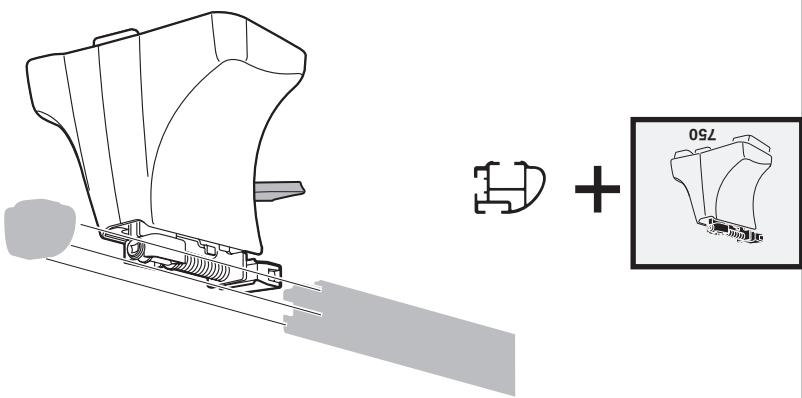

2

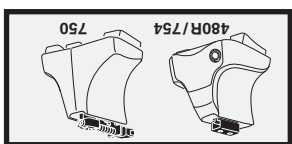
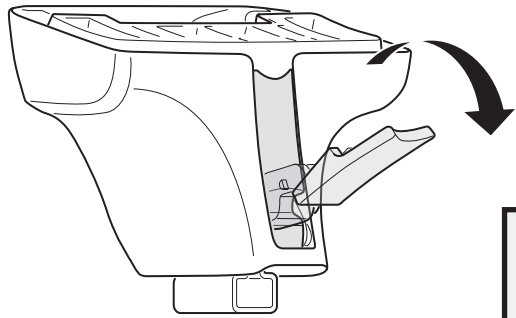

1

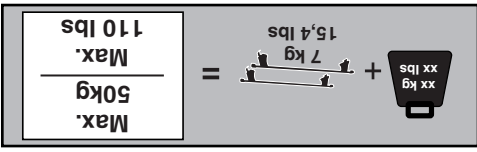
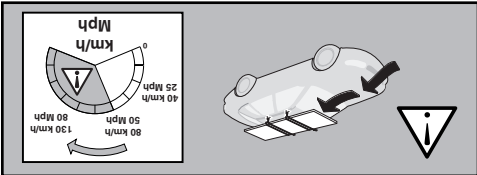
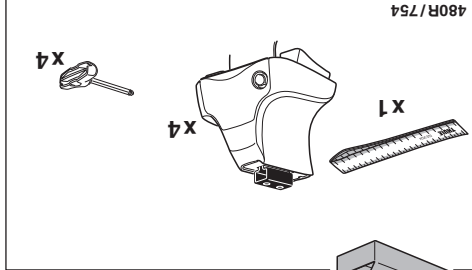
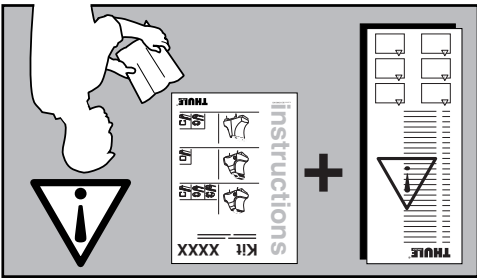
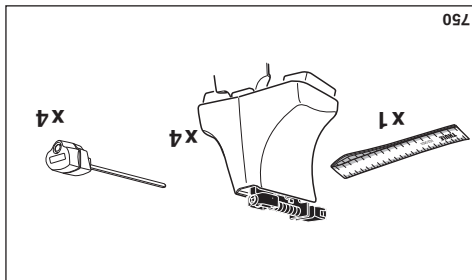
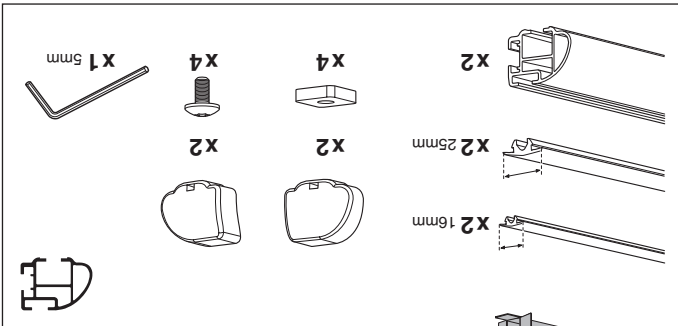
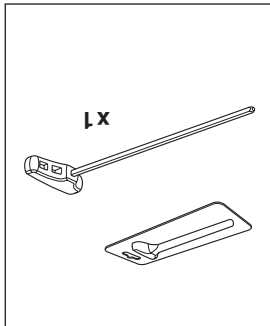
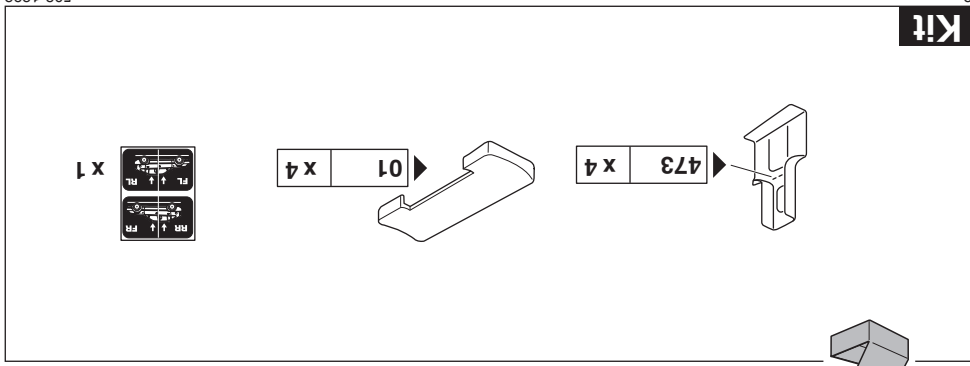

# instructions

© 20090622 503-1292

ISO 11154-E

PROFESSIONAL

**THULE**  
SWEDEN

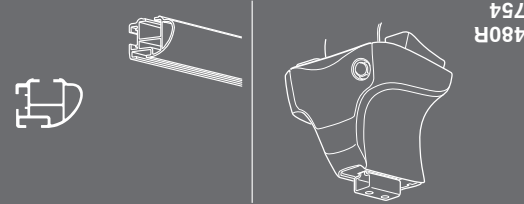
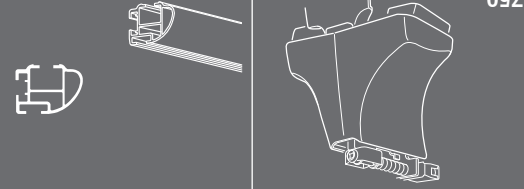

FORD Ranger, 2-dr Single Cab, 98-02, 03-  
FORD Ranger, 4-dr Double Cab, 98-02, 03-  
FORD Ranger, 4-dr Super Cab, 98-02, 03-  
MAZDA B-series, 2-dr Single Cab, 98-  
MAZDA B-series, 4-dr Double Cab, 98-  
MAZDA BT-50, 2-dr Single Cab, 07-  
MAZDA BT-50, 4-dr Crew Cab, 07-  
MAZDA BT-50, 4-dr Double Cab, 07-  
MAZDA Freestyle, 4-dr Maxi Cab, 03-

# Kit 1292