

# Kit 1202

HYUNDAI Trajet, 5-dr MPV, 99-03, 04-08\*

\* Without roof railing

480R  
754

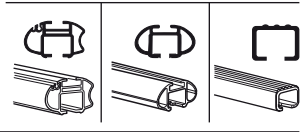
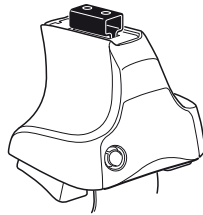

480

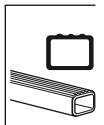
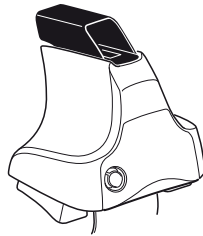

750

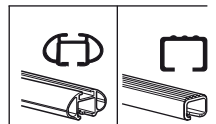
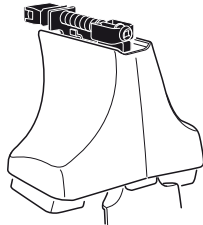

480R/754	
480	
750	

--------------	--	--------------	----------	--

**Kit**



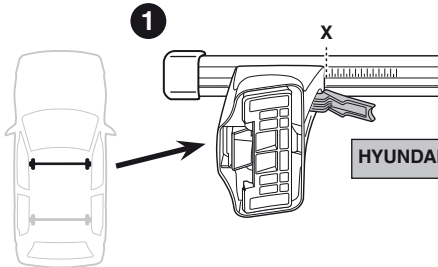

<b>1</b>	<b>X</b>
<b>HYUNDAI Trajet, 5-dr MPV, 99-03, 04-08</b>	<b>45</b>

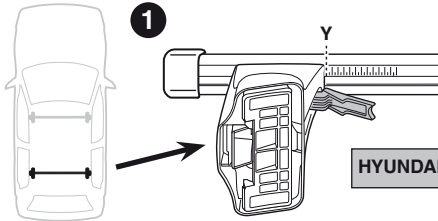

<b>1</b>	<b>Y</b>
<b>HYUNDAI Trajet, 5-dr MPV, 99-03, 04-08</b>	<b>43</b>

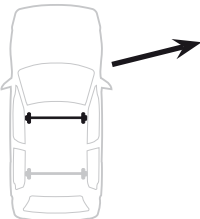

<b>1</b>	<b>X inch/mm</b>	<b>2</b>
<b>HYUNDAI Trajet, 5-dr MPV, 99-03, 04-08</b>	<b>X inch</b>	<b>X mm</b>
	<b>43 3/8"</b>	<b>1101 mm</b>

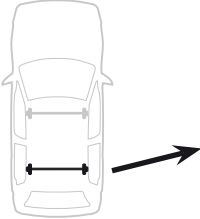

<b>1</b>	<b>Y inch/mm</b>	<b>2</b>
<b>HYUNDAI Trajet, 5-dr MPV, 99-03, 04-08</b>	<b>Y inch</b>	<b>Y mm</b>
	<b>42 1/2"</b>	<b>1081 mm</b>

# 4

HYUNDAI Trajet, 5-dr MPV, 99-03, 04-08

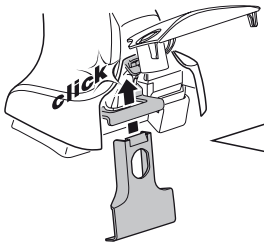
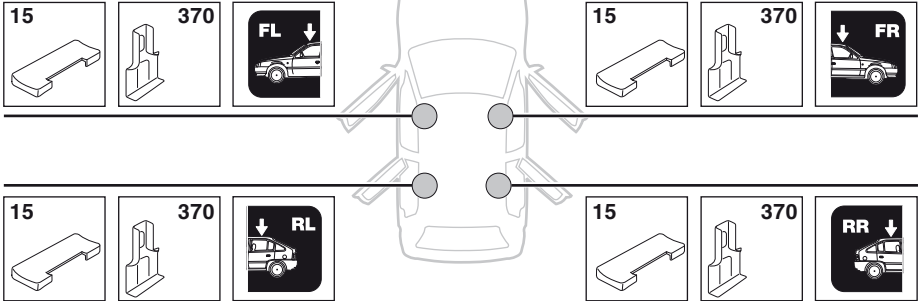

5



	X mm	Y mm	X inch	Y inch
HYUNDAI Trajet, 5-dr MPV, 99-03, 04-08	370 mm	700 mm	14 5/8"	27 1/2"

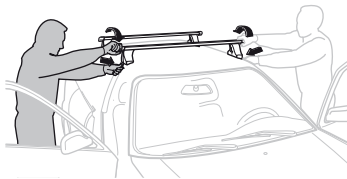
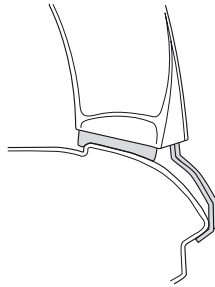
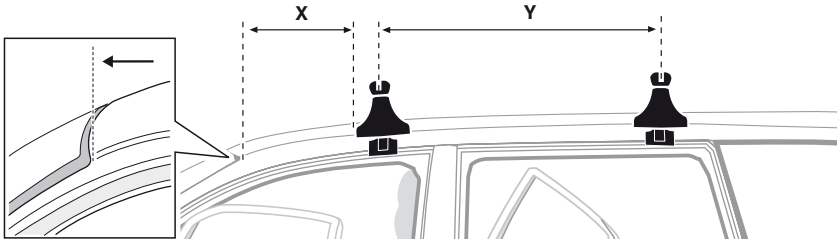

**GB/US** Tighten alternately

**D** Die Schrauben abwechselnd anziehen

**F** Serrer alternativement chaque côté

**NL** Afwisselend aan de linker- en de rechterkant aandraaien

**I** Alternare il serraggio delle viti

**E** Apertar alternativamente

**PT** Aperte alternadamente

**S** Dra åt växelvis

**FIN** Kierrä vuorotellen

**EST** Pinguldage vaheldumisi

**LAT** Pielieciet pamišus

**LIT** Užsukinėkite pakaitomis

**PL** Śruby dokręcaj naprzemiennie

**RU** Затягивайте попеременно

**CZ** Pokręťta bagažníka dokręcaj dokręcaj naprzemiennie.

**SK** Doťahujte striedavo

**SLO** Privijajte izmenično.

**HR** Naizmjenično zategnite

**HU** Egymástól függetlenül szorítandó

**GR** Σφιγγετε εναλλάξ

**TR** Dönüşümlü sıkın

**中文** 交替拧紧

**한국어** 번갈아 가며 조이십시오.

**日本語** 交互に締め付けてください。

**ไทย** ชันโนแบบสลับ

6



480R/754



480

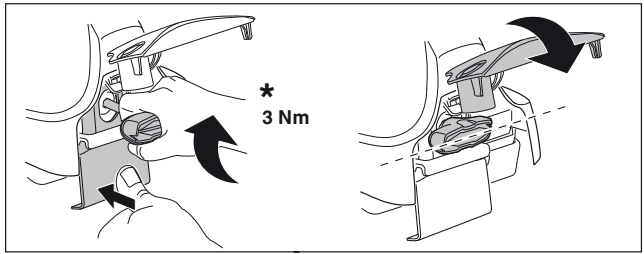
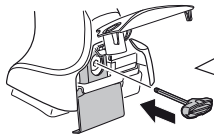

\*  
3 Nm



\*

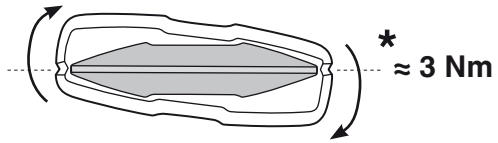

\*  
≈ 3 Nm

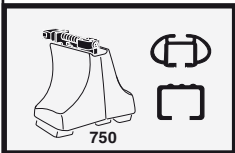
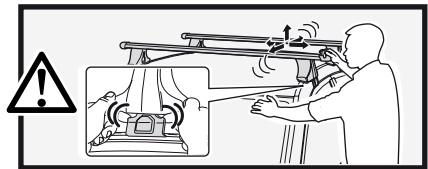

750

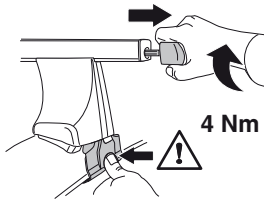

4 Nm

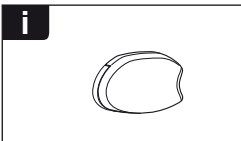
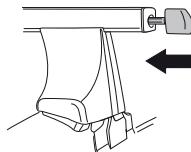

i

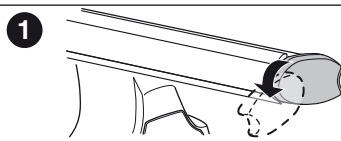

1

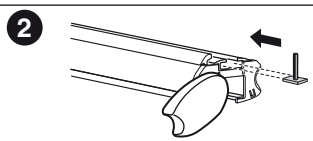

2

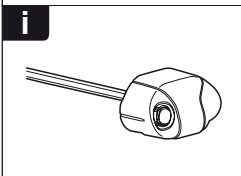

i

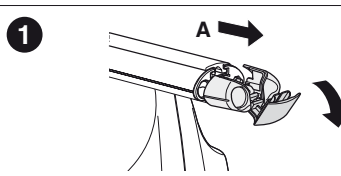

1

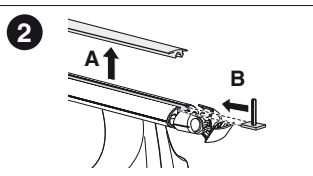

2

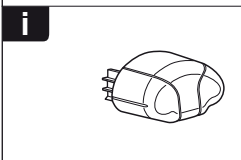

i

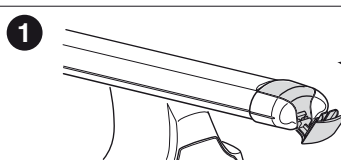

1

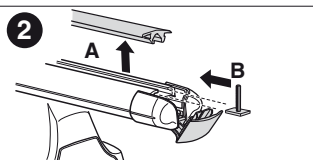

2

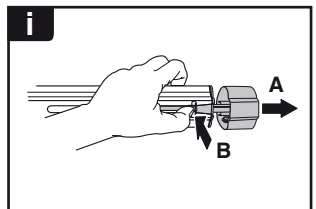
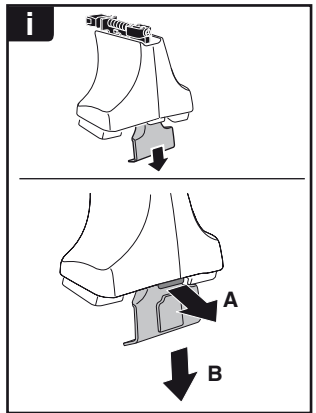

**THULE**  
SWEDEN  
**ONE  
KEY  
SYSTEM**



- 544 (x4)
- 596 (x6)
- 588 (x8)
- NA 510 (x10)
- EUR 452 (x12)
- ASIA 452 (x12)

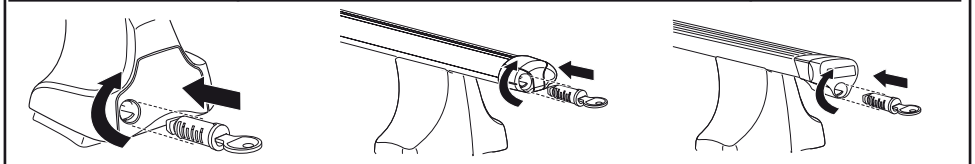

WW ▶ Thule Sweden AB, Box 69, 330 33 Hillerstorp, SWEDEN  
NA ▶ Thule Inc., 42 Silvermine Road, Seymour, Connecticut 06483, USA

info@thule.com  
customer.service@thule.com

www.thule.com