

Kit 1153

TOYOTA Granvia, 5-dr MPV, 95–
TOYOTA Hi Ace Regius, 5-dr MPV, 97–

480R
754

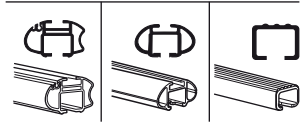
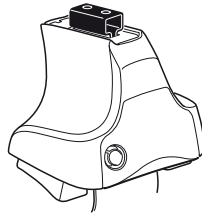

480

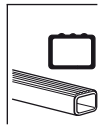
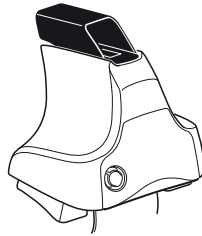

750

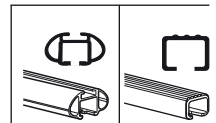
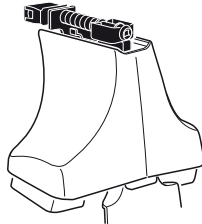

Kit



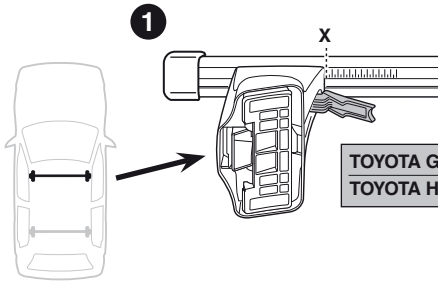

	X
TOYOTA Granvia, 5-dr MPV, 95–	43,5
TOYOTA Hi Ace Regius, 5-dr MPV, 97–	32,5

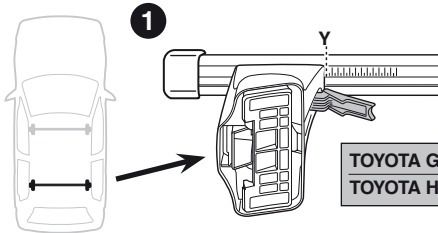

	Y
TOYOTA Granvia, 5-dr MPV, 95–	43,5
TOYOTA Hi Ace Regius, 5-dr MPV, 97–	32,5

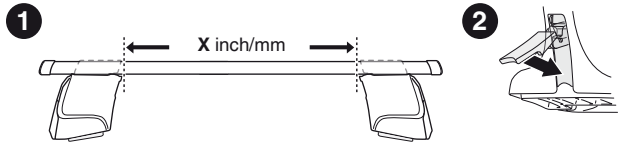
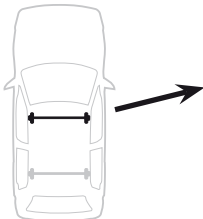
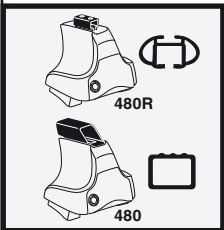

	X inch	X mm
TOYOTA Granvia, 5-dr MPV, 95–	42 ³ / ₄ "	1086 mm
TOYOTA Hi Ace Regius, 5-dr MPV, 97–	38 ³ / ₈ "	976 mm

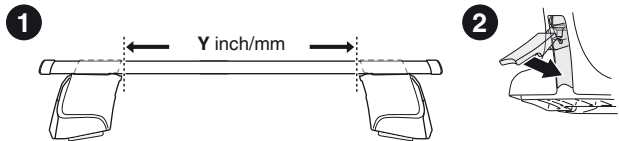
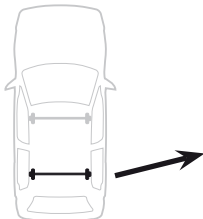

	Y inch	Y mm
TOYOTA Granvia, 5-dr MPV, 95–	42 ³ / ₈ "	1086 mm
TOYOTA Hi Ace Regius, 5-dr MPV, 97–	38 ³ / ₈ "	976 mm

4

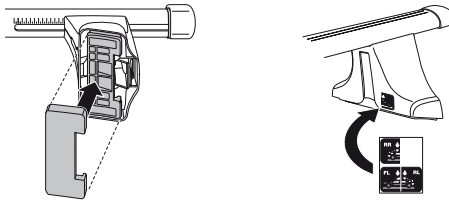
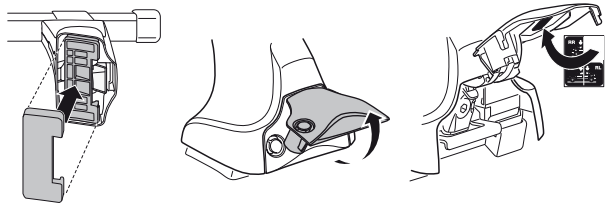
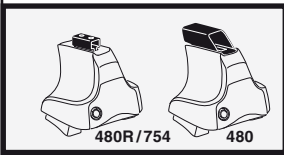
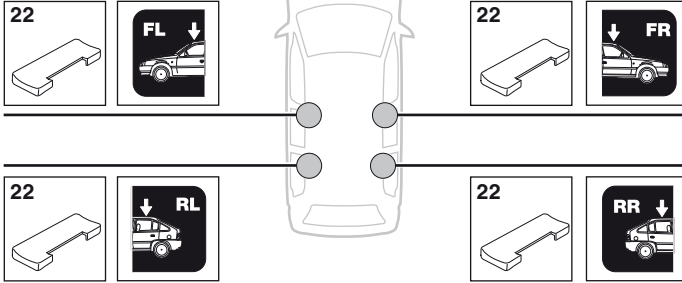

5

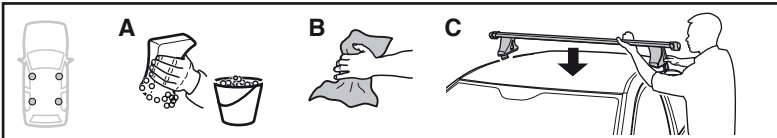

	X mm	Y mm	Z mm	X inch	Y inch	Z inch
TOYOTA Granvia, 5-dr MPV, 95-	1020 mm	600 mm	620 mm	40 1/8"	23 5/8"	24 3/8"
TOYOTA Hi Ace Regius, 5-dr MPV, 97-	1020 mm	600 mm	620 mm	40 1/8"	23 5/8"	24 3/8"

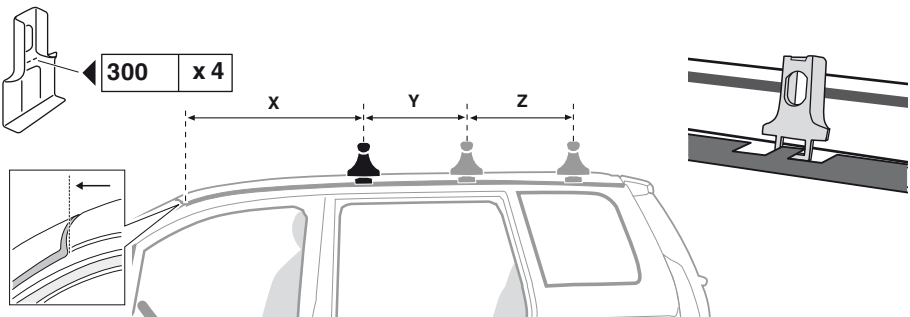

6

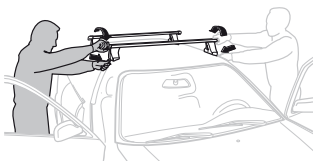
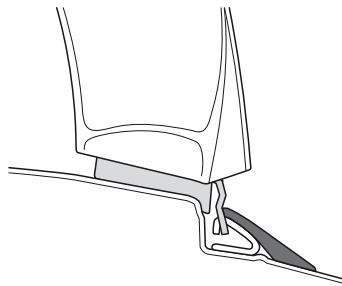
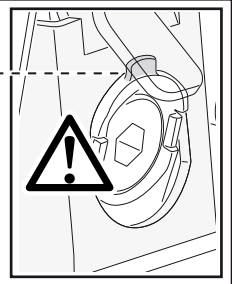
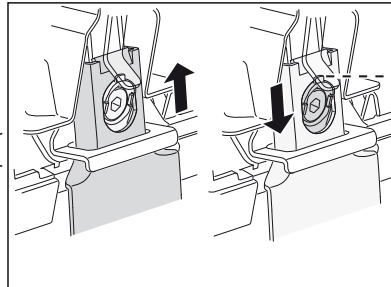
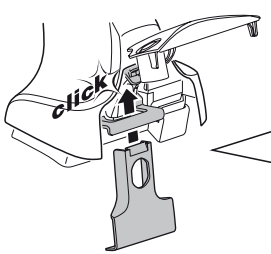
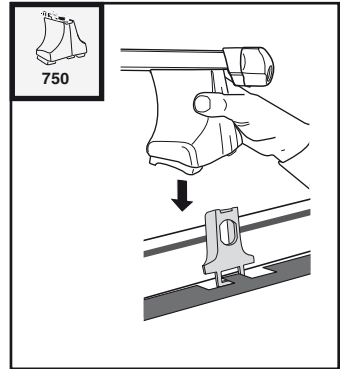
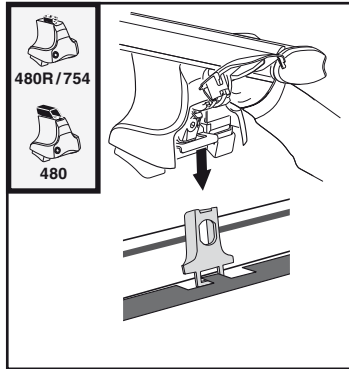

- GB/US** Tighten alternately
D Die Schrauben abwechselnd anziehen
F Serrer alternativement chaque côté
NL Afwisselend aan de linker- en de rechterkant aandraaien
I Alternare il serraggio delle viti
E Apretar alternativamente
PT Aperte alternadamente
S Dra åt växelvis
FIN Kierrä vuorotellen
EST Pinguldage vaheldumisi
LAT Pievelciēt pamišus
LIT Užsukinėkite pakaitomis
PL Śruby dokręcaj naprzemiennie
RU Затягивайте попеременно

- CZ** Pокрѣtla багажника dokręcaj naprzemiennie.
SK Dofahujte striedavo
SLO Privijajte izmenično.
HR Naizmjenično zategnite
HU Egymástól függetlenül szorítandó
GR Σφιγγετε εναλλάξ
TR Dönüşümlü sıkın

中文 交替拧紧

한국어 번갈아 가며 조이십시오.

日本語 交互に締め付けてください。

ไทย ชั้สลับแบบสลับ

7



480R/754



480

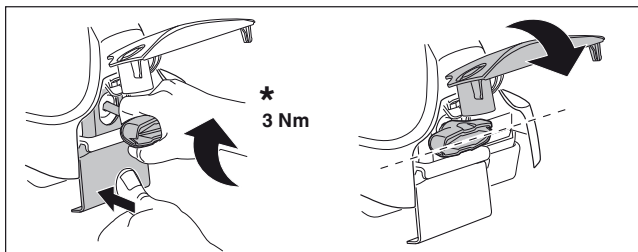
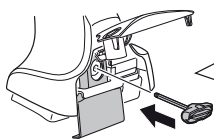

*
3 Nm

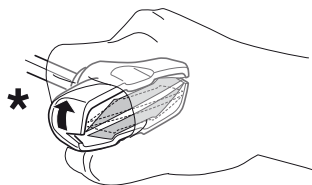

*

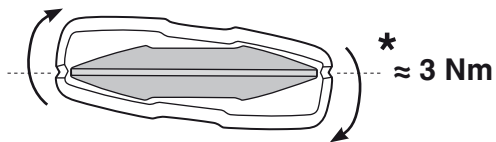

*
≈ 3 Nm

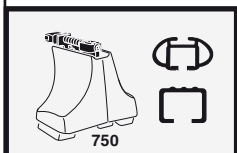
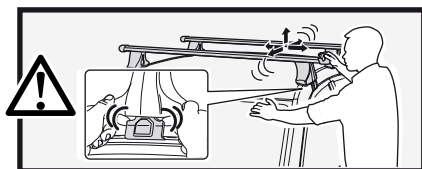

750

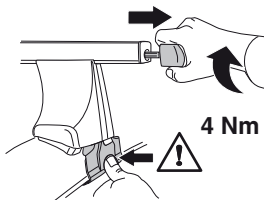

4 Nm

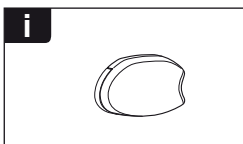
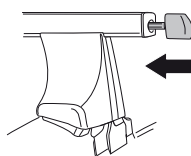

i

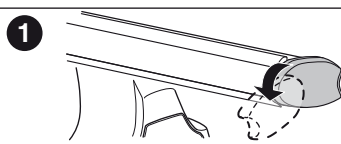

1

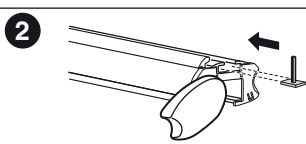

2

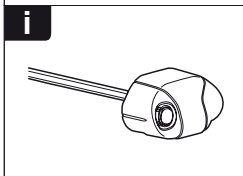

i

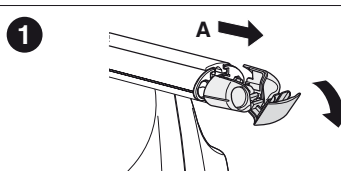

1

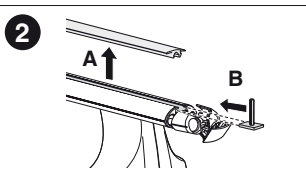

2

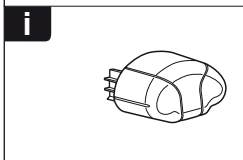

i

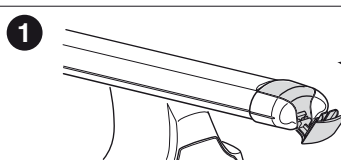

1

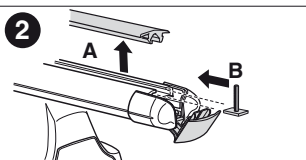

2

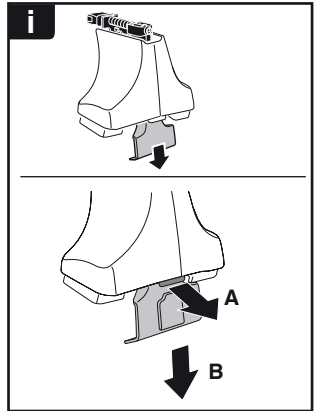
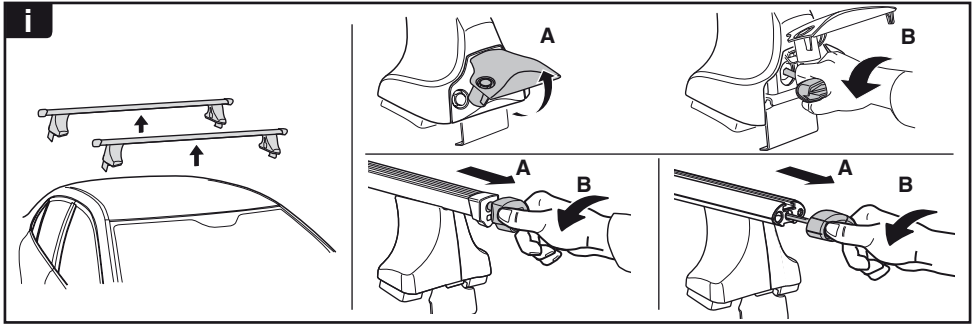

THULE
SWEDEN
**ONE
KEY
SYSTEM**



- 544 (x4)
- 596 (x6)
- 588 (x8)
- NA 510 (x10)
- EUR 452 (x12)
- ASIA



WW ▶ Thule Sweden AB, Box 69, 330 33 Hillerstorp, SWEDEN
NA ▶ Thule Inc., 42 Silvermine Road, Seymour, Connecticut 06483, USA

info@thule.com
customer.service@thule.com

www.thule.com