

Kit 1052

SEAT Arosa, 3-dr Hatchback, 98-00, 01-05
VOLKSWAGEN Lupo, 3-dr Hatchback, 97-05

480R
754

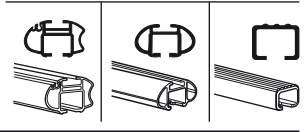
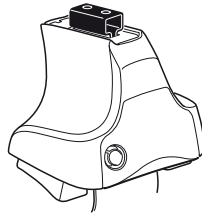

480

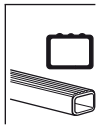
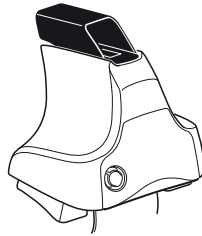

750

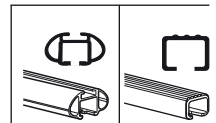
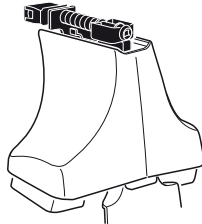

Kit



3

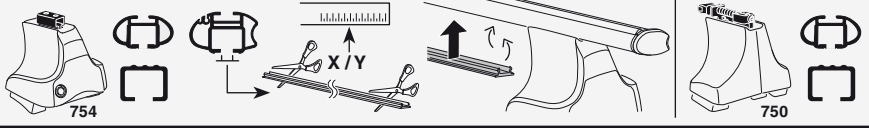

1

2

	X
SEAT Arosa, 3-dr Hatchback, 98-00, 01-05	31,5
VOLKSWAGEN Lupo, 3-dr Hatchback, 97-05	31,5

1

2

	Y
SEAT Arosa, 3-dr Hatchback, 98-00, 01-05	25,5
VOLKSWAGEN Lupo, 3-dr Hatchback, 97-05	25,5

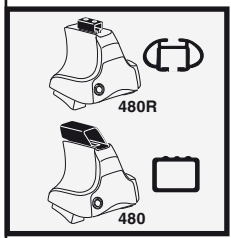

1

2

	X inch	X mm
SEAT Arosa, 3-dr Hatchback, 98-00, 01-05	38"	966 mm
VOLKSWAGEN Lupo, 3-dr Hatchback, 97-05	38"	966 mm

1

2

	Y inch	Y mm
SEAT Arosa, 3-dr Hatchback, 98-00, 01-05	35 ⁵ / ₈ "	906 mm
VOLKSWAGEN Lupo, 3-dr Hatchback, 97-05	35 ⁵ / ₈ "	906 mm

4

SEAT Arosa, 3-dr Hatchback, 98-00, 01-05
VOLKSWAGEN Lupo, 3-dr Hatchback, 97-05

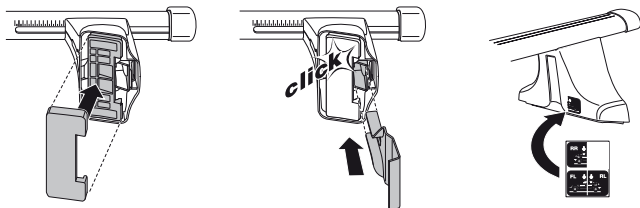
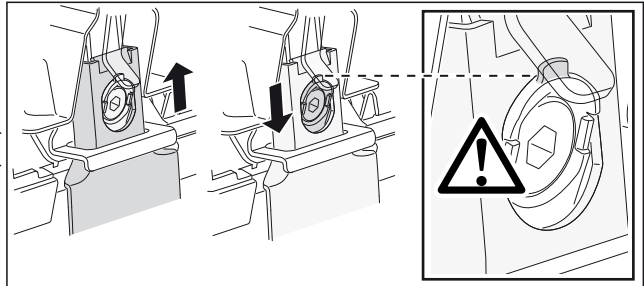
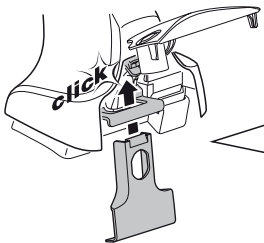
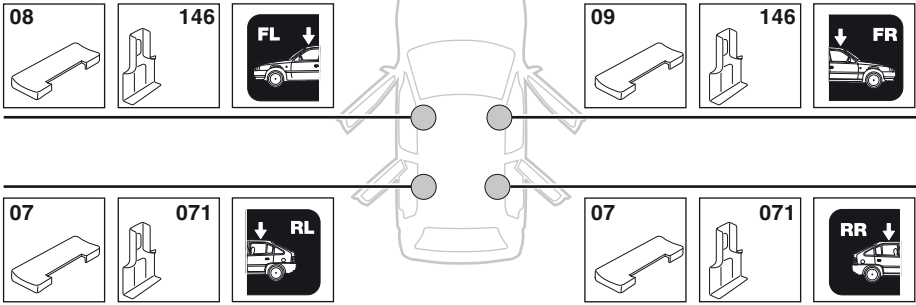

5

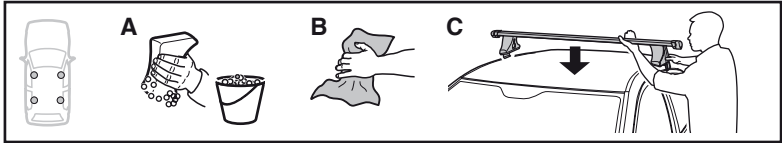

	X mm	Y mm	X inch	Y inch
SEAT Arosa, 3-dr Hatchback, 98-00, 01-05	260 mm	740 mm	10 1/4"	29 1/8"
VOLKSWAGEN Lupo, 3-dr Hatchback, 97-05	260 mm	740 mm	10 1/4"	29 1/8"

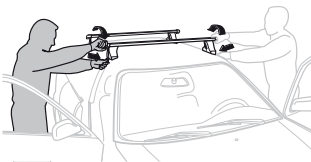
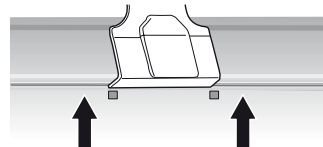
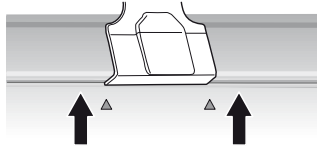
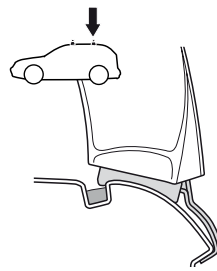
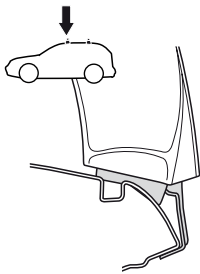
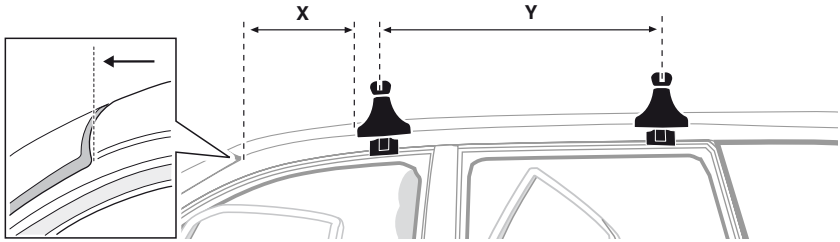

GB/US Tighten alternately
D Die Schrauben abwechselnd anziehen
F Serrer alternativement chaque côté
NL Afwisselend aan de linker- en de rechterkant aandraaien
I Alternare il serraggio delle viti
E Apretar alternativamente
PT Aperte alternadamente
S Dra åt växelvis
FIN Kierrä vuorotellen
EST Pinguldage vaheldumisi
LAT Pievelciēt pamišus
LIT Užsukinėkite pakaitomis
PL Śruby dokręcaj naprzemiennie
RU Затягивайте попеременно

CZ Pokręťta багаžníka dokręcaj dokręcaj naprzemiennie.
SK Doťahujte striedavo
SLO Privijajte izmenično.
HR Naizmjenično zategnite
HU Egymástól függetlenül szorítandó
GR Σφίγγετε εναλλάξ
TR Dönüşümlü sıkın

中文 交替拧紧
한국어 번갈아 가며 조이십시오.
日本語 交互に締め付けてください。
ไทย ชั้ในแบบสลับ

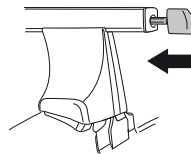
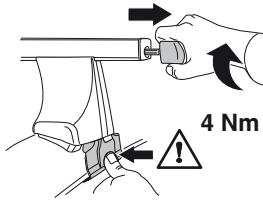
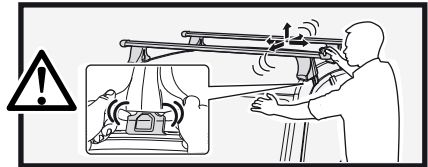
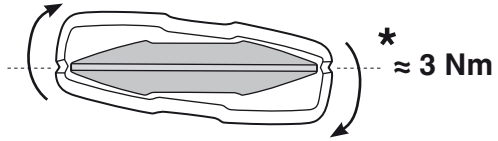
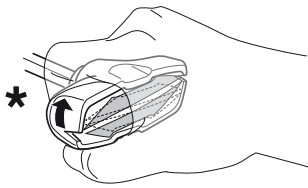
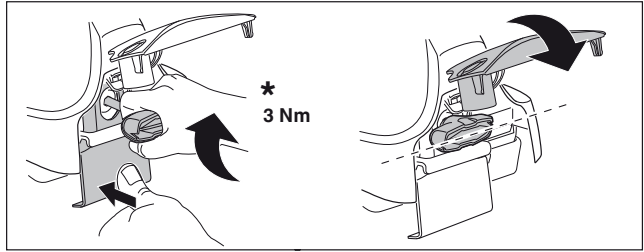
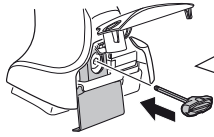
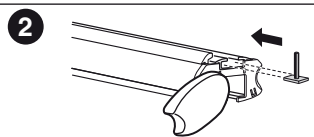
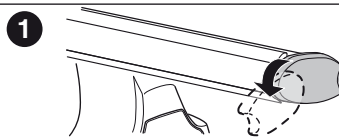
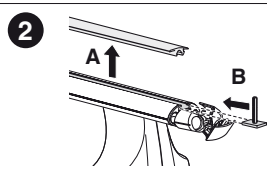
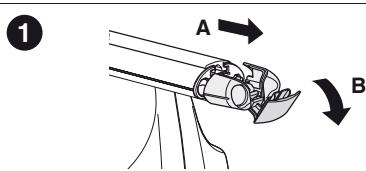
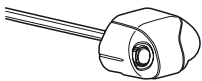
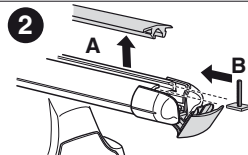
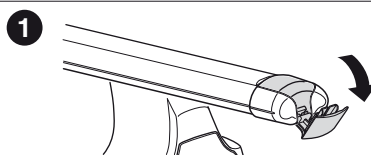
6**i****i****i**



THULE
SWEDEN
**ONE
KEY
SYSTEM**



- 544 (x4)
- 596 (x6)
- 588 (x8)
- NA 510 (x10)
- EUR 452 (x12)
- ASIA



WW ▶ Thule Sweden AB, Box 69, 330 33 Hillerstorp, SWEDEN
NA ▶ Thule Inc., 42 Silvermine Road, Seymour, Connecticut 06483, USA

info@thule.com
customer.service@thule.com

www.thule.com