

Kit 1605

CITROËN C3, 5-dr Hatchback, 02-09

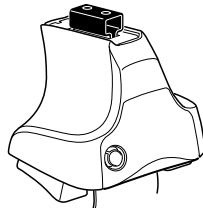

480R Rapid Traverse
754 Rapid System

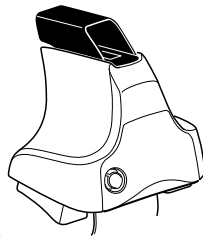
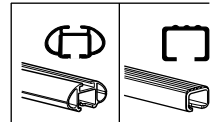

480 Traverse



	23 mm	17 mm	23 mm	
	23 mm	23 mm		

Kit

1

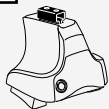

480R Rapid Traverse
754 Rapid System



480 Traverse

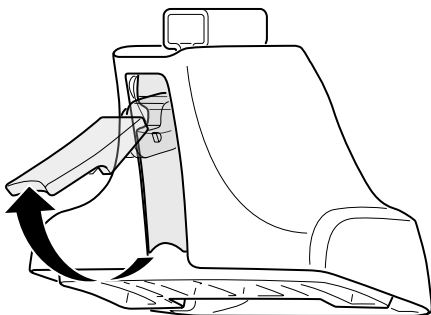

2

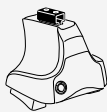

480R Rapid Traverse
754 Rapid System



480 Traverse

+

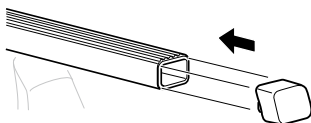
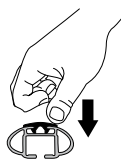
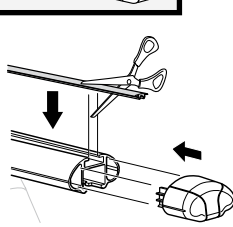
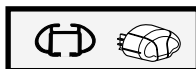
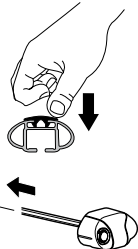
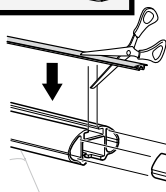
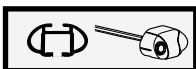
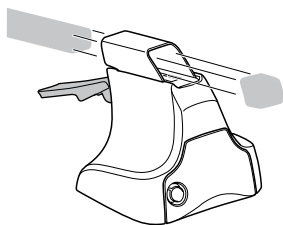
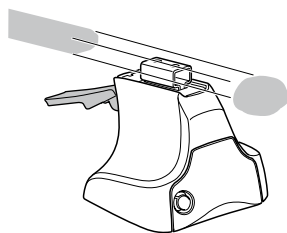

3

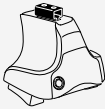

754 Rapid System

1

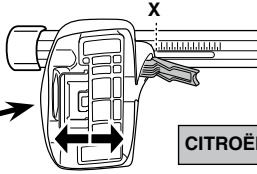
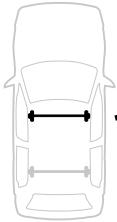

2

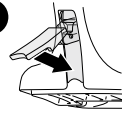

CITROËN C3, 5-dr Hatchback, 02-09

X

33,5

1

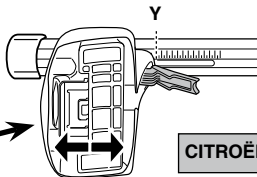
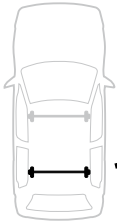

2

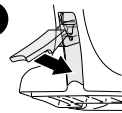

CITROËN C3, 5-dr Hatchback, 02-09

Y

29,5



480R Rapid Traverse



480 Traverse

1

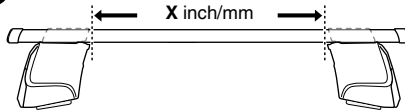

2

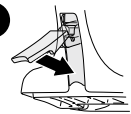

CITROËN C3, 5-dr Hatchback, 02-09

X inch

X mm

38 ⁷/₈"

986 mm

1

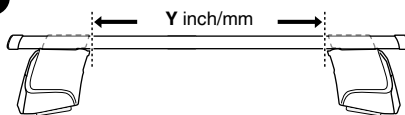

2

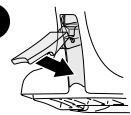

CITROËN C3, 5-dr Hatchback, 02-09

Y inch

Y mm

37 ¹/₄"

946 mm

4



480R Rapid Traverse
754 Rapid System



480 Traverse

CITROËN C3, 5-dr Hatchback, 02-09

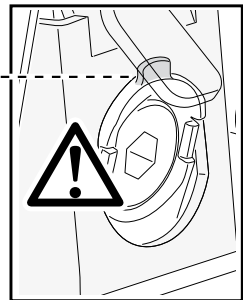
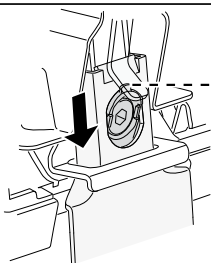
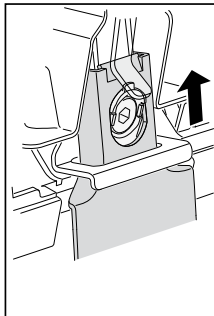
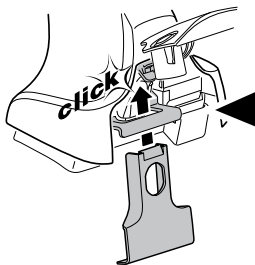
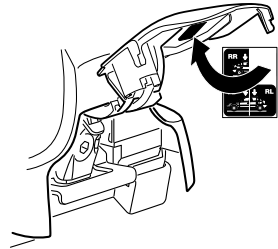
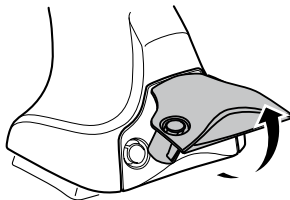
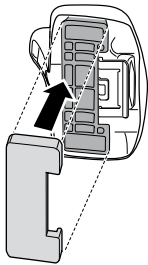
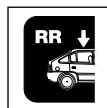
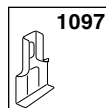
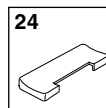
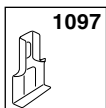
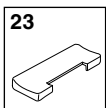
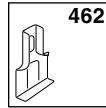
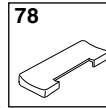
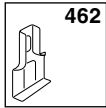
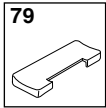

5



	X mm	Y mm	X inch	Y inch
CITROËN C3, 5-dr Hatchback, 02-09	280 mm	650 mm	11"	25 5/8"

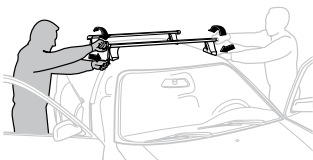
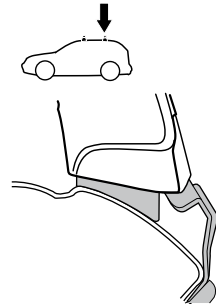
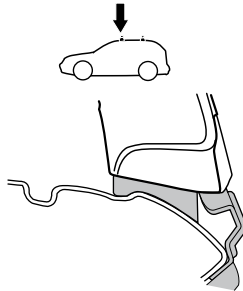
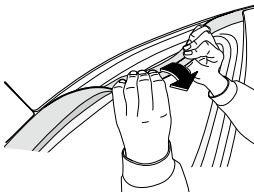
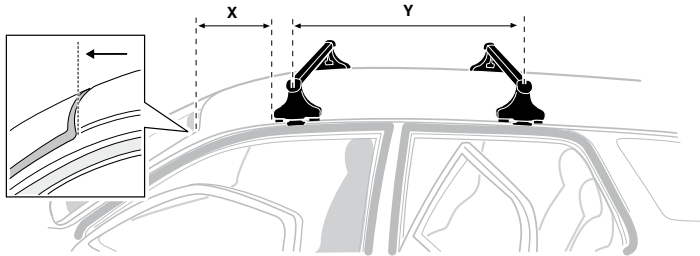

- GB/US** Tighten alternately
D Die Schrauben abwechselnd anziehen
F Serrer alternativement chaque côté
NL Afwisselend aan de linker- en de rechterkant aandraaien
I Alternare il serraggio delle viti
E Apretar alternativamente
PT Aperte alternadamente
S Dra åt växelvis
FIN Kierrä vuorotellen
EST Pinguldage vaheldumisi
LAT Pievelciēt pamīšus
LIT Užsukinėkite pakaitomis
PL Śruby dokręcaj naprzemiennie
RU Затягивайте попеременно

- CZ** Pokrétla bagazníka dokręcaj dokręcaj naprzemiennie.
SK Dotahujte striedavo
SLO Privijajte izmenično.
HR Naizmjениčno zategnite
HU Egymástól függetlenül szorítandó
GR Σφιγγετε εναλλάξ
TR Dönüşümlü sıkın

中文 交替拧紧

한국어 번갈아 가며 조이십시오.

日本語 交互に締め付けてください。

ไทย ชนั้ในแบบสลับ

6

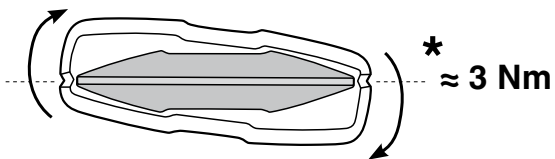
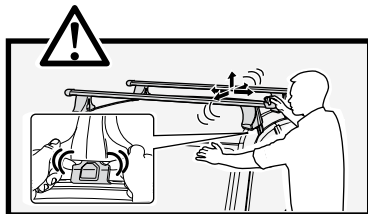
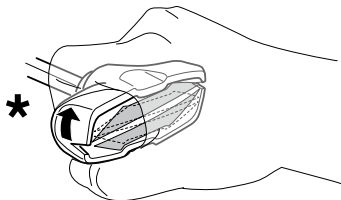
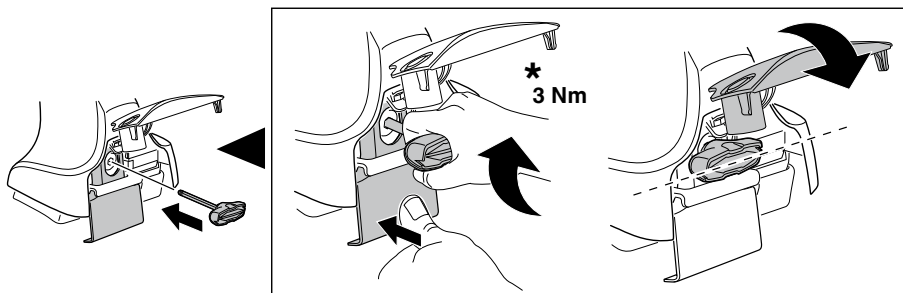
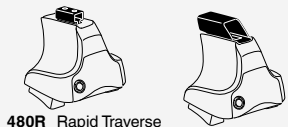

7

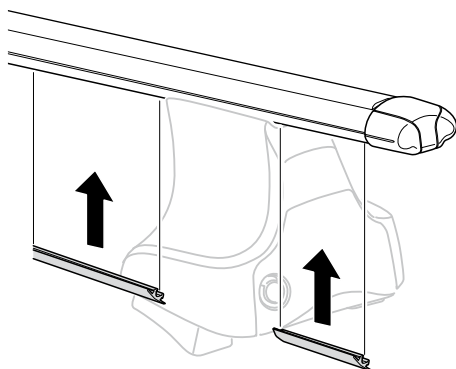
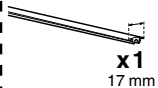

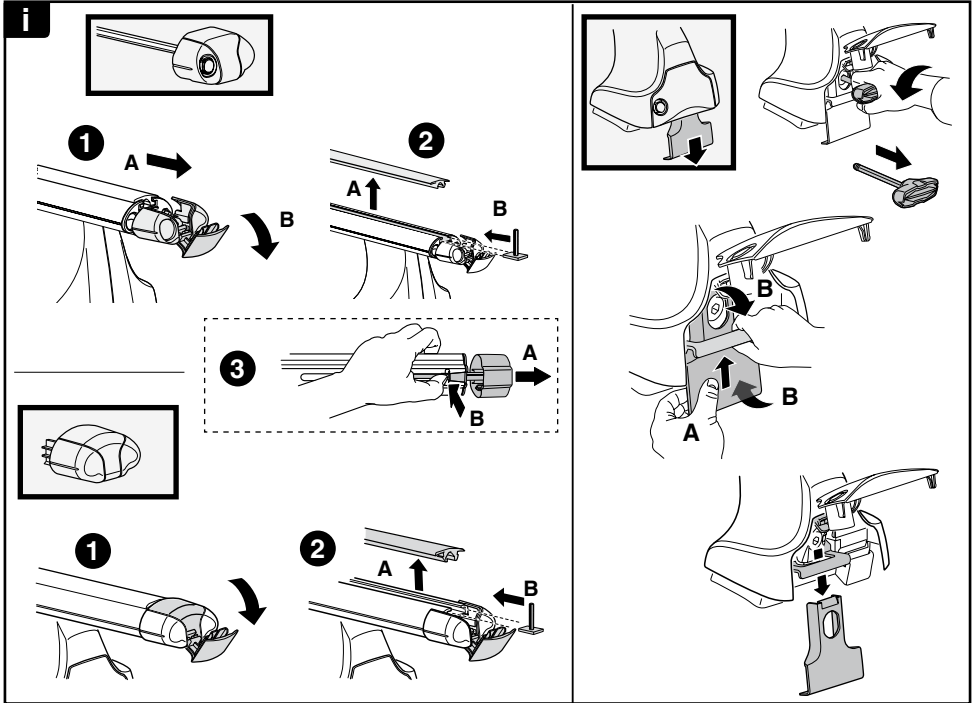

THULE
SWEDEN
**ONE
KEY
SYSTEM**

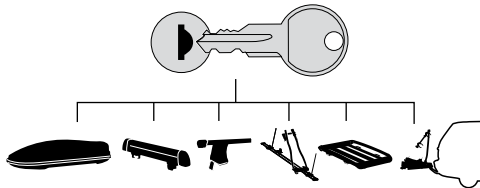

544 (x4)

596 (x6)

588 (x8)

NA **510** (x10)

EUR **452** (x12)

ASIA

