

Technical Specifications	
Goal Zero Yeti 150	26-52 hrs
Goal Zero Sherpa 50 v2	8-16 hrs
Goal Zero Guide 10 Plus	2.5-5 hrs
Solar Panel	
Rated Power	13W
Open Circuit Voltage	18-22V
Cell Type	monocrystalline
Ports	
USB Port	5V, up to 1A (5W max) regulated
Solar Port (blue, 8mm)	14-22V, up to 0.9A (13W max)
Mini Solar Port (2.5mm)	6.5V, up to 1.1A (7W max) regulated

General	
Weight	1.6 lbs (726 g)
Dimensions (unfolded)	10.5 x 24 x 0.25 in (27 x 61 x 0.6 cm)
Dimensions (folded)	10.5 x 9 x 1 in (27 x 23 x 2.5 cm)
Certs	CE FCC RoHS
Warranty	12 months

This equipment has been tested and found to comply with the limits for a Class B digital device, pursuant to part 15 of the FCC Rules. These limits are designed to provide reasonable protection against harmful interference in a residential installation. This equipment generates, uses and can radiate radio frequency energy and, if not installed and used in accordance with the instructions, may cause harmful interference to radio communications. However, there is no guarantee that interference will not occur in a particular installation. If this equipment does cause harmful interference to radio or television reception, which can be determined by turning the equipment off and on, the user is encouraged to try to correct the interference by one or more of the following measures:

- Reorient or relocate the receiving antenna.
- Increase the separation between the equipment and receiver.
- Connect the equipment into an outlet on a circuit different from that to which the receiver is connected.
- Consult the dealer or an experienced radio/TV technician for help.

This device complies with part 15 of the FCC Rules. Operation is subject to the following two conditions: (1) This device may not cause harmful interference, and (2) this device must accept any interference received, including interference that may cause undesired operation.

Power Port on Back of Solar Panel

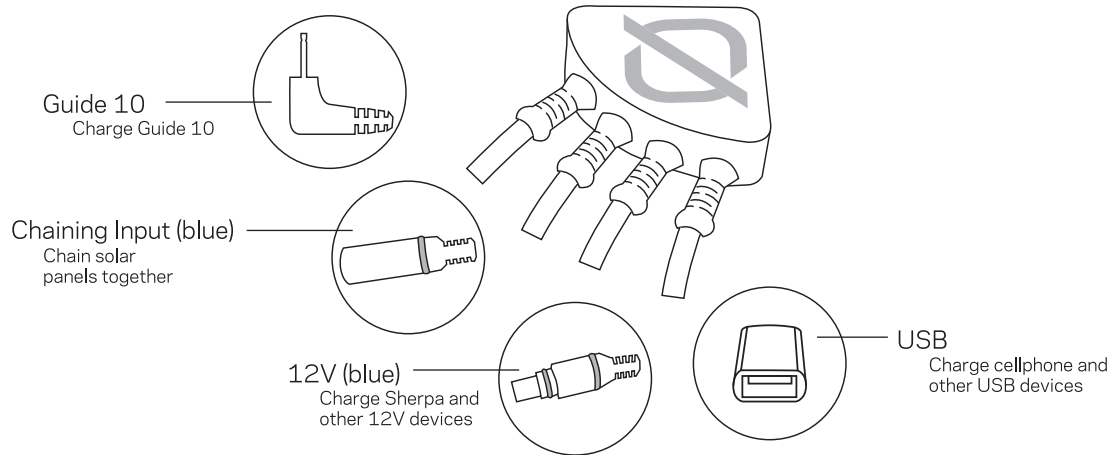

Know Your Gear

NOMAD[®]13

SOLAR PANEL

USER GUIDE

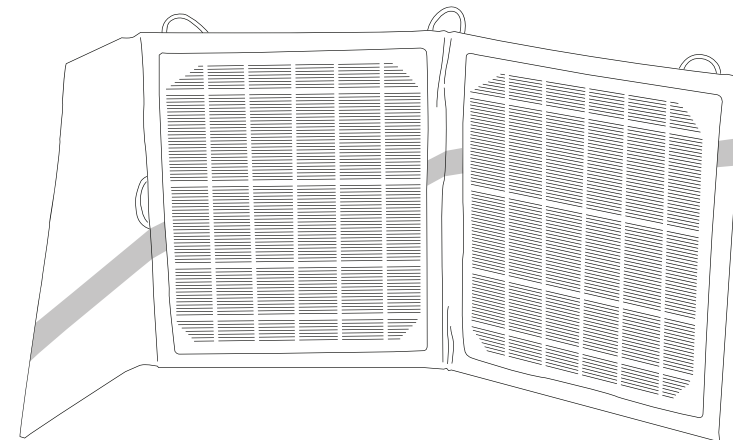

GOAL ZERO HEADQUARTERS
675 West 14600 South
Bluffdale, UT 84065
1-888-794-6250
Designed in the U.S.A.
Made in China

Nomad is a trademark of Goal Zero.

Be sure to activate your warranty at goalzero.com/warranty

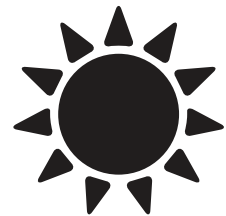

CHARGE

From the sun.

Angle the panel towards the sun.

1

POWER

Plug in any USB or 12V device.

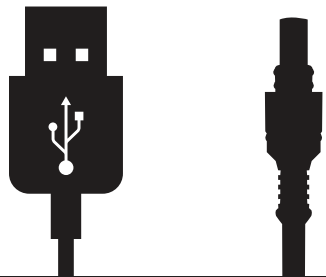

2

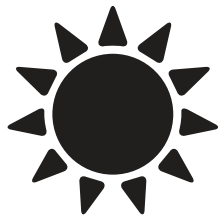

REPLENISH

To stay prepared
keep devices plugged into USB
or solar panel.

3

Frequently Asked Questions

Q: Does the solar panel hold a charge?

A: No, the panel produces power only when it is exposed to sunlight. To generate the most power, angle the panel towards the sun. This improves your ability to collect power from the sun. Note: Clouds and windows affect collection efficiency. If you would like to store solar power, combine the Nomad 13 with the Sherpa 50 Power Pack.

Q: What can I charge directly from the solar panel?

A: USB and 12V devices like cellphones, GPS and iPods. You can plug in a 12V device and a USB device at the same time, however, you will slow down the charge time for both devices.

Q: Is the solar panel waterproof?

A: It is weather-resistant and will not be harmed if exposed to rain or snow.

Q: Why am I having trouble charging my cellphone?

A: Some phones require very specific and constant power. Try changing the angle of your panel and re-plugging in your phone. Most charging issues are overcome by incorporating a Goal Zero portable recharger like a Sherpa.

Q: Can I chain multiple solar panels together?

A: Yes. Chaining additional solar panels is a great way to charge your device from the sun in less time. You can chain up to four solar panels at once.

